

Holy Cross Church, Taibach, Neath Port Talbot Photographic Survey



Report by: Trysor

For: Mr Malcolm Evans and Mr Andrew Atkins

February 2017



Holy Cross Church, Taibach, Neath Port Talbot Photographic Survey

By

Jenny Hall, MCIfA & Paul Sambrook, MCIfA
Trysor

Trysor Project No. 2017/534

For: Mr Malcolm Evans and Mr Andrew Atkins

February 2017

38, New Road
Gwaun-cae-Gurwen
Ammanford
Carmarthenshire
SA18 1UN
www.trysor.net
enquiries@trysor.net



Cover photograph: Holy Cross Church, Taibach, looking north

Holy Cross Church, Taibach, Neath Port Talbot Photographic Survey

RHIF YR ADRODDIAD - REPORT NUMBER: Trysor 2017/505

DYDDIAD 2^{il} Chwefror 2017 **DATE** 2nd February 2017

Paratowyd yr adroddiad hwn gan bartneriad Trysor. Mae wedi ei gael yn gywir ac yn derbyn ein sêl bendith.

This report was prepared by the Trysor partners. It has been checked and received our approval.

JENNY HALL MCIFA

Jenny Hall

PAUL SAMBROOK MCIFA

Paul Sambrook

Croesawn unrhyw sylwadau ar gynnwys neu strwythur yr adroddiad hwn.

We welcome any comments on the content or structure of this report.

*38, New Road,
Gwaun-cae-Gurwen
Ammanford
Carmarthenshire
SA18 1UN
01269 826397*

*82, Henfaes Road
Tonna
Neath
SA11 3EX
01639 412708*

www.trysor.net

enquiries@trysor.net

Trysor is a Registered Organisation with the Chartered Institute for Archaeologists and both partners are Members of the Chartered Institute for Archaeologists, www.archaeologists.net .

Jenny Hall (BSc Joint Hons., Geology and Archaeology, MCIfA) had 12 years excavation experience, which included undertaking watching briefs prior to becoming the Sites and Monuments Record Manager for a Welsh Archaeological Trust for 10 years. She has been an independent archaeologist since 2004 undertaking a variety of work that includes upland survey, desk-based appraisals and assessments, and watching briefs.

Paul Sambrook (BA Joint Hons., Archaeology and Welsh, MCIfA, PGCE) has extensive experience as a fieldworker in Wales. He was involved with Cadw's pan-Wales Deserted Rural Settlements Project for 7 years. He also undertook Tir Gofal field survey work and watching briefs. He has been an independent archaeologist since 2004 undertaking a variety of work including upland survey, desk-based appraisals/assessments, and watching briefs.

Contents

1. Summary	1
2. Copyright	1
3. Introduction	1
4. The Development	1
5. Conditions on the consent	1
6. Methodology	2
7. Historical and Archaeological Overview	4
8. Photographs	7
9. Conclusion	17
10. Archive	18
11. Sources	18
Appendix A: Written Scheme of Investigation	19
Appendix B: Photographs	25

1. Summary

1.1 In October and November 2016, Trysor undertook a photographic survey at Holy Cross church, Taibach during conversion of the closed church to a chapel of ease.

1.2 The modification of the church included the partitioning of the south transept to create a workshop area, as well as the addition of a canopy above the pews. No significant structural alterations were to be made to the building however and the conversion was generally undertaken in a sympathetic manner, retaining most original features.

2. Copyright

2.1 Trysor hold the copyright of this report and of the paper and digital archive. Further paper copies may be made of this report without gaining permission to reproduce but it must be noted that Figures 2 and 3 include other copyright material and should not be copied.

3. Introduction

3.1 Ron Bagshaw of Wood Field House, Rosser Terrace, Cilfrew, Neath SA10 8LH, on behalf of his client Malcolm Evans, commissioned Trysor heritage consultants to write a Written Scheme of Investigation relating to Listed Building Consent for planning application number: P2016/0323 (Neath Port Talbot).

3.2 Trysor produced a written scheme of investigation for a Level 2 building record, see Appendix A.

3.3 The project has been identified as 2016/534 in Trysor records and given a site code HCT2016.

4. The Development

4.1 The development consists of alterations to the redundant church at Holy Cross, Taibach to convert it into a chapel of rest.

4.2 The works consist of widening the existing access way and pathway with relocation of stone pillars and insertion of new access gates, reuse of existing entrance gates to be re-sited across the external door of vestry and the construction of some internal partition walls. Plans to install a disabled toilet with associated cesspit have been dropped.

5. Conditions on the consent

5.1 In granting approval for the application, the Local Planning Authority imposed a condition on the consent; the condition specifies the actions necessary to mitigate the impact of the development on the built resource.

No works to which this consent relates shall commence until an appropriate programme of historic building recording and analysis has been secured and implemented in accordance with a written scheme of investigation which has been submitted and approved in writing by the local planning authority.

Reason

As the building is of architectural and cultural significance the specified records are required to mitigate impact.

6. Methodology

6.1 On September 7th, 2016, Trysor visited the church and took a series of photographs showing external views and features.

6.2 On October 6th, 2016, Trysor again visited the church and took a series of internal photographs of the church, accompanied by the owners.

Holy Cross Church, Taibach, Neath Port Talbot
Photographic Survey

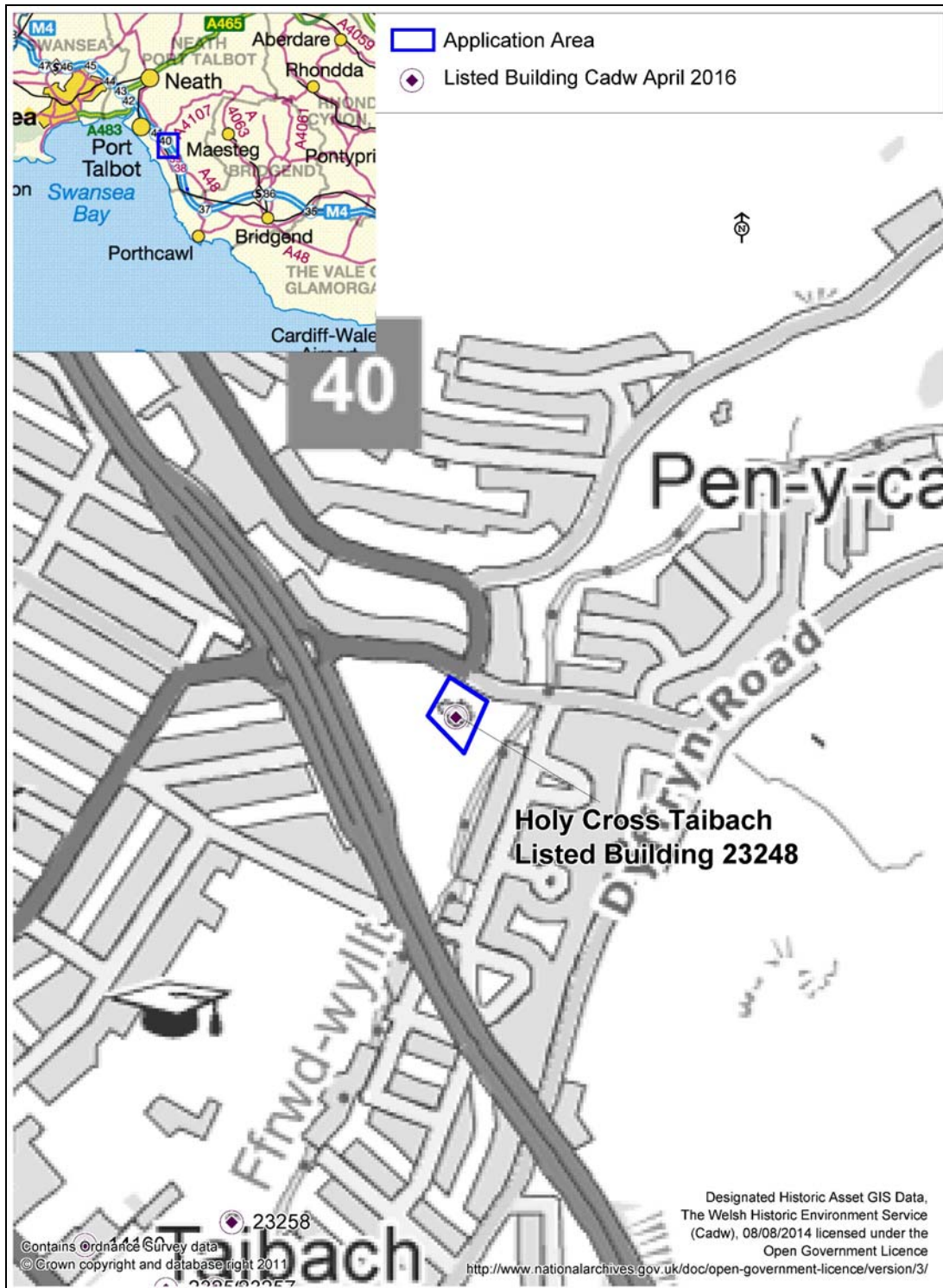

Figure 1: Location of Holy Cross Church, Taibach.

7. Historical and Archaeological Overview

7.1 Holy Cross church, Taibach is a Grade II listed building, Listed Building number 23248. It is recorded in the National Monuments Record as NPRN 414438, but no record for it exists in the regional Historic Environment Record.

7.2 The church was originally built in 1827, on land donated by C.R.M. Talbot of the Margam Estate. The field was known as “Pedair Erw” (Four Acres) and part of Tanygroes Farm (Rees, 2013). The new chapel was intended to serve as a chapel of ease to Margam Abbey church. It was consecrated by the Bishop of Llandaff on September 15th, 1827. The chapel of ease was designed by Shrewsbury architect Edward Haycock in a Decorated Gothic style. Local Pennant Sandstone was used for the building, with Bath Stone used for dressings.

7.3 Taibach was at that time a rapidly growing industrial community and the project had the active support of the Vicar of Margam, the Reverend William Bruce Knight, as well as that of the manager of Taibach Copper Works, who saw that it would serve the spiritual needs of his workforce. The chapel was built for a large congregation, with seating provided for 500 worshippers. An early plan of the church (Figure 2), shows it packed with pews and benches (Haycock, E., 1827).

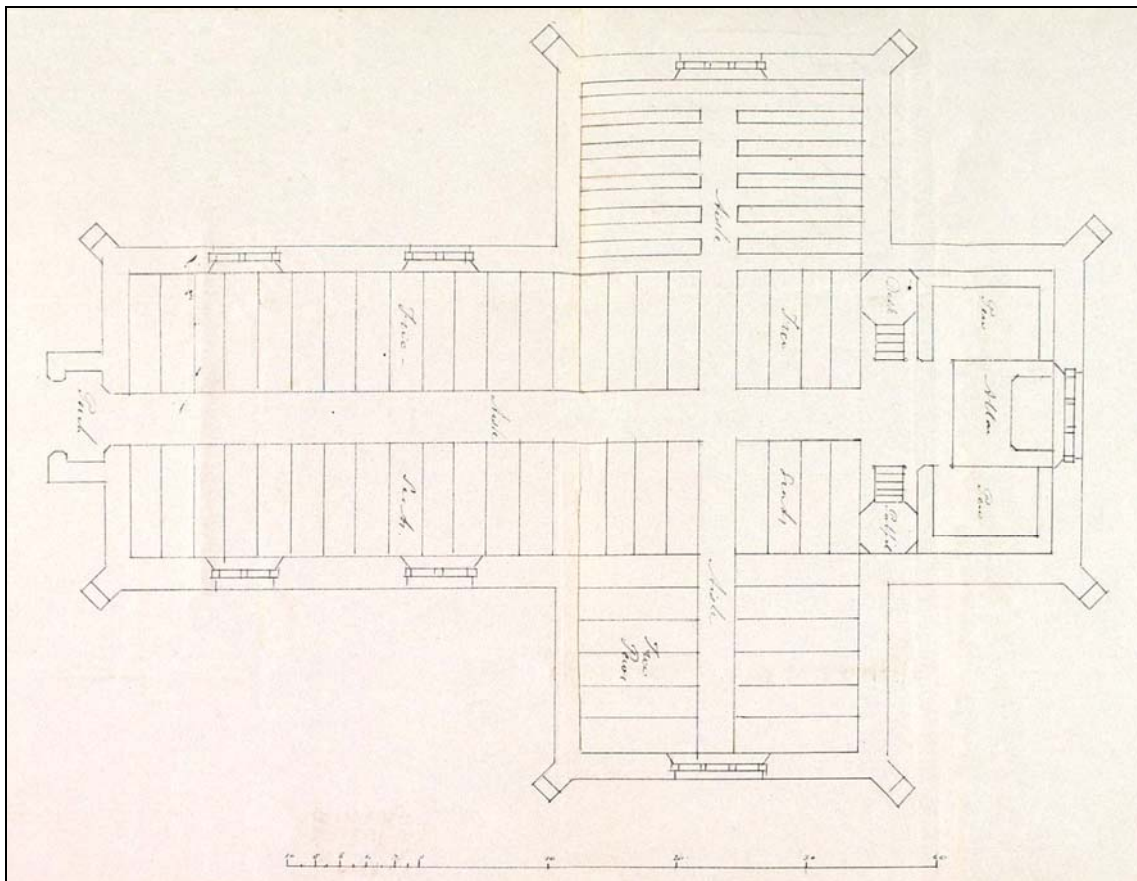

Figure 2; A plan of the church in 1827.

7.4 In 1831, a significant alteration was made to the interior of the church, with the addition of a small gallery at the western end of the nave. This was added to accommodate a choir and orchestra. The gallery was extended in 1860 when an organ was added. The organ was taken down in 1873 and moved to the north transept. An area between the organ and the north wall of the transept was then screened by the organ and used as the church vestry. In 1880, a vestry was created for the choir under the south side of the gallery, in the area where the font is currently placed.

7.5 The building was known simply as Margam Chapel of Ease until 1901, in which year it was transferred from Margam parish into the parish of St. Theodore's, Port Talbot. At this point the name Holy Cross Church was adopted, known to its predominantly Welsh-speaking congregation as Eglwys y Grôg.

7.6 In 1903, the church was renovated by G.E.Halliday. The gallery at the west end of the nave was removed at this time and the ornate rood screen was inserted.

7.7 The fine stained glass window at the eastern end of the church, above the altar, dates to sometime after 1905. It was added to the church sometime in commemoration of Ann Vintin, Taibach (1823-1905) and donated by her family. The window shows the Crucifixion, Resurrection and Ascension of Jesus.

7.8 The church was closed in 2008 due to healthy and safety issues.

7.9 In 2009 Martin Crampin, on behalf of the Friends of Friendless Churches, undertook a photographic survey of the interior and exterior of the church. Around a 100 photographs were taken in raw format and have been archived by the Friends of Friendless Churches. Some of these photographs can be currently seen on the Stained Glass in Wales website.

7.10 The organ was removed in 2010 and sold to an Irish church (Malcolm Evans, pers. Comm.) It was, however, recorded by a photographic survey prior to its removal (GGAT HER PRN E003253).

7.11 A plan of the church as it was in January 2011 was drawn by Page & Dean Ltd of Peterstone, Wentloog, along with four elevations, of the east, south, west and north faces of the building, as well as 8 cross sections across the building. The elevations show details of quoinstones/buttresses, roof line, the surrounds of the doors and windows and the door and windows themselves. The cross sections show masonry detail including location of plaques and wood fittings

including the rood screen. These drawings have been deposited with the National Monuments Record in Aberystwyth, under the record number NPRN 414438.

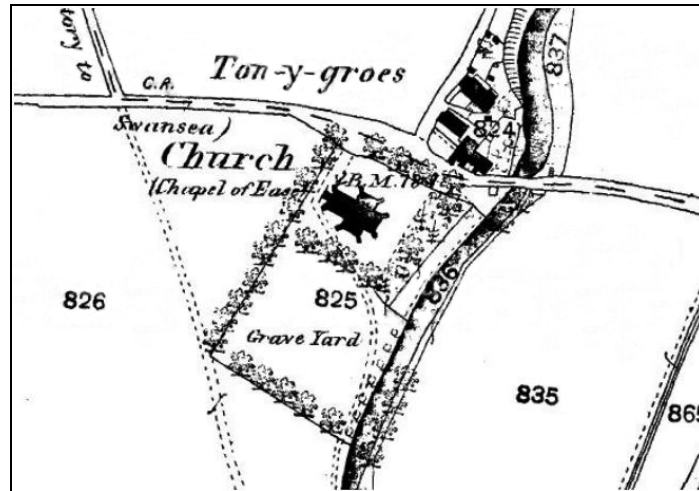

Figure 3: The 1875 1:2500 scale Ordnance Survey map shows that the church originally stood in a smaller, rectangular churchyard.

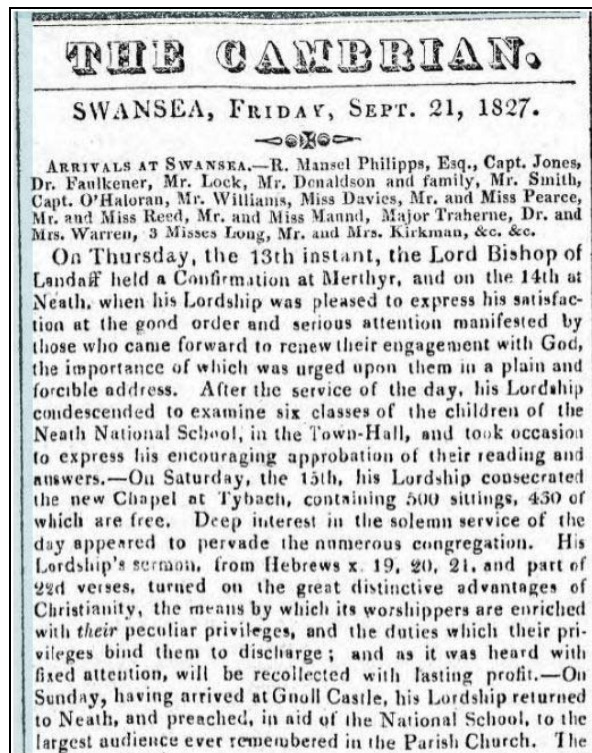

Figure 4: A newspaper report from The Cambrian newspaper, September 22nd, 1827 reporting the opening of the church.

8. Photographs

8.1 Colour digital photographs, inside and outside the church, using a 16M pixel camera. The following table describes the content of each photograph included in the project archive and their locations are provided in the following map, see Figure 5, 6 & 7. The photographs are included in Appendix B at the end of the report.

Photo Number	Description	Date Taken	Direction
HCT2016_001	<i>External view of western end of church, looking east-southeast.</i>	07/09/2016	East-southeast
HCT2016_002	<i>Detail of bellcote, looking east-southeast.</i>	07/09/2016	East-southeast
HCT2016_003	<i>Upper part of western end of church, showing base of bellcote, looking east-southeast.</i>	07/09/2016	East-southeast
HCT2016_004	<i>Rose window in western end of church, looking east-southeast.</i>	07/09/2016	East-southeast
HCT2016_005	<i>External view of church, looking east-northeast.</i>	07/09/2016	East-northeast
HCT2016_006	<i>External view of southern side of church, looking north-northeast.</i>	07/09/2016	North-northeast
HCT2016_007	<i>External view of church, looking north-northwest.</i>	07/09/2016	North-northwest
HCT2016_008	<i>External view of church, looking north-northwest (zoomed in).</i>	07/09/2016	North-northwest
HCT2016_009	<i>External view of church, looking north-northwest.</i>	07/09/2016	North-northwest
HCT2016_010	<i>External view of southern chancel wall, looking north-northeast.</i>	07/09/2016	North-northeast
HCT2016_011	<i>External view of south wall of south transept, looking north-northeast.</i>	07/09/2016	North-northeast
HCT2016_012	<i>External view of south side of nave, looking north-northeast.</i>	07/09/2016	North-northeast
HCT2016_013	<i>External view of south side of porch, looking north-northeast.</i>	07/09/2016	North-northeast
HCT2016_014	<i>External view of east-southeast end of church, looking west-northwest.</i>	07/09/2016	West-northwest
HCT2016_015	<i>External view of east wall of the north transept, looking west-northwest.</i>	07/09/2016	West-northwest

*Holy Cross Church, Taibach, Neath Port Talbot
Photographic Survey*

Photo Number	Description	Date Taken	Direction
HCT2016_016	<i>External view of north wall of north transept, looking south-southwest.</i>	07/09/2016	South-southwest
HCT2016_017	<i>External view of northern chancel wall, looking south.</i>	07/09/2016	South
HCT2016_018	<i>External view of northern side of the nave, looking west-southwest.</i>	07/09/2016	West-southwest
HCT2016_019	<i>External view of western wall of northern transept, including door into transept/vestry, looking east-southeast.</i>	07/09/2016	East-southeast
HCT2016_020	<i>External view of transept/vestry door, looking east-southeast.</i>	07/09/2016	East-southeast
HCT2016_021	<i>Detail of benchmark on buttress on external northwestern corner of the nave at the western end of the church, looking west-southwest.</i>	07/09/2016	West-southwest
HCT2016_022	<i>External view of porch entrance, looking south-southwest.</i>	07/09/2016	South-southwest
HCT2016_023	<i>External view of southern wall of porch and west end of church, with railings in foreground, looking east-northeast.</i>	07/09/2016	East-northeast
HCT2016_024	<i>External view of north wall porch, looking north-northeast.</i>	07/09/2016	North-northeast
HCT2016_025	<i>Detail of railings in front of western end of church, looking east-southeast.</i>	07/09/2016	East-southeast
HCT2016_026	<i>View of gate pillars at entrance to churchyard with the eastern pillar under reconstruction after the entrance has been widened, looking south-southeast.</i>	07/09/2016	South-southeast
HCT2016_027	<i>View of the intact western gate pillar at the entrance to the churchyard, looking north-northwest.</i>	07/09/2016	North-northwest
HCT2016_028	<i>Internal view of the chancel, showing rood screen and cross, looking east-southeast.</i>	6/10/2016	East-southeast
HCT2016_029	<i>Internal view of the chancel, showing altar, chancel floor and pews, looking east-southeast. Taken from a stepladder.</i>	6/10/2016	East-southeast

*Holy Cross Church, Taibach, Neath Port Talbot
Photographic Survey*

Photo Number	Description	Date Taken	Direction
HCT2016_030	<i>Internal view of the main door in the western end of the church, with the rose window above, looking west-northwest along the nave. Taken from a stepladder.</i>	6/10/2016	West-northwest
HCT2016_031	<i>Internal view of the nave, showing the rose window above the main entrance, as well as the new "canopies" erected over the pews along either side of the nave. Also showing the western end of the church roof and a roof beam. Looking west-northwest. Taken from a stepladder.</i>	6/10/2016	West-northwest
T2016_032	<i>Internal view of the nave, showing the rose window, the main entrance door, as well as the new "canopies" erected over the pews along either side of the nave. Also showing the western end of the church roof and a roof beam. Looking west-northwest. Taken from a stepladder.</i>	6/10/2016	West-northwest
HCT2016_033	<i>Internal view of the pews along the southern side of the nave, looking southwest.</i>	6/10/2016	Southwest
HCT2016_034	<i>Internal view of the pews along the northern side of the nave, looking northwest.</i>	6/10/2016	Northwest
HCT2016_035	<i>Internal view into new workshop inserted into south transept, looking south.</i>	6/10/2016	South
HCT2016_036	<i>Internal view of north transept, showing the pulpit, the partition creating the vestry area and the doorway leading into the vestry, looking north-northeast.</i>	6/10/2016	North-northeast
HCT2016_037	<i>Internal view of north transept, showing the north window, pulpit, the partition creating the vestry area and the doorway leading into the vestry, looking north-northeast.</i>	6/10/2016	North-northeast
HCT2016_038	<i>Internal view of stained glass window in east wall of chancel, looking east-southeast.</i>	6/10/2016	East-southeast

*Holy Cross Church, Taibach, Neath Port Talbot
Photographic Survey*

Photo Number	Description	Date Taken	Direction
HCT2016_039	<i>View of altar at eastern end of church, looking east-southeast.</i>	6/10/2016	East-southeast
HCT2016_040	<i>View of altar at eastern end of church, with the purple altar hanging used for Lent and funerals hung in front, looking east-southeast.</i>	6/10/2016	East-southeast
HCT2016_041	<i>View of altar at eastern end of church, with the white altar hanging used for weddings, Christmas and Easter hung in front, looking east-southeast.</i>	6/10/2016	East-southeast
HCT2016_042	<i>View of altar at eastern end of church, with the green altar hanging used for Trinity hung in front, looking east-southeast.</i>	6/10/2016	East-southeast
HCT2016_043	<i>View of altar at eastern end of church, with the red altar hanging used for Whitsun hung in front, looking east-southeast.</i>	6/10/2016	East-southeast
HCT2016_044	<i>A decorative 6" x 6" floor tile in the sanctuary, before the altar, looking east-southeast.</i>	6/10/2016	East-southeast
HCT2016_045	<i>A decorative 6" x 6" floor tile in the sanctuary, before the altar, looking east-southeast.</i>	6/10/2016	East-southeast
HCT2016_046	<i>A decorative 6" x 6" floor tile in the chancel, the eastern tile of three, looking east-southeast.</i>	6/10/2016	East-southeast
HCT2016_047	<i>A decorative 6" x 6" floor tile in the chancel, the central tile of three, looking east-southeast.</i>	6/10/2016	East-southeast
HCT2016_048	<i>A decorative 6" x 6" floor tile in the chancel, the western tile of three, looking east-southeast.</i>	6/10/2016	East-southeast
HCT2016_049	<i>Detail of the decorative panelling on the front of the altar, looking east-southeast.</i>	6/10/2016	East-southeast
HCT2016_050	<i>Seat in southern side of chancel from where notices are given, looking west-southwest.</i>	6/10/2016	West-southwest
HCT2016_051	<i>Seat in southern side of chancel from where notices are given, looking south-southwest.</i>	6/10/2016	South-southwest

*Holy Cross Church, Taibach, Neath Port Talbot
Photographic Survey*

Photo Number	Description	Date Taken	Direction
HCT2016_052	<i>Plaque fixed in front of seat box in southern side of chancel from where notices are given, looking south-southwest. "In Memory of Thomas Edwards Died 1948 and Gwenny Edwards Died 1956"</i>	6/10/2016	South-southwest
HCT2016_053	<i>View of a plaque on the north wall of the nave, looking north-northeast. "In Memory of Hopkin Llewellyn Prichard Esq."</i>	6/10/2016	North-northeast
HCT2016_054	<i>View of a plaque on the north wall of the nave, looking north-northeast. "In Memory of my wife Margaret Jenkins."</i>	6/10/2016	North-northeast
HCT2016_055	<i>View of the Hymn Board on the north wall of the nave, looking north-northeast.</i>	6/10/2016	North-northeast
HCT2016_056	<i>View of a memorial plaque on the Hymn Board on the north wall of the nave, looking north-northeast. "In Memory of Augustus G. Sims presented by his wife and family"</i>	6/10/2016	North-northeast
HCT2016_057	<i>View of a marble memorial tablet on the north wall of the nave, looking north-northeast. "Sacred to the memory of Robert Lindsay of Glan Afon Taibach Esquire"</i>	6/10/2016	North-northeast
HCT2016_058	<i>View of a memorial plaque on the west wall of the north transept, looking west-northwest. "In Affectionate Memory of Augusta Emily 2nd Daughter of the 3rd Earl of Dunraven.</i>	6/10/2016	West-northwest
HCT2016_059	<i>View of the pews in the northern side of the nave, looking north-northeast.</i>	6/10/2016	North-northeast
HCT2016_060	<i>Internal view of vestry door in west wall of north transept, looking west-northwest.</i>	6/10/2016	West-northwest
HCT2016_061	<i>Photograph hung on the east wall of the vestry in the north transept, showing the Holy Cross Church Choir in 1968, looking east-southeast.</i>	6/10/2016	East-southeast
HCT2016_062	<i>View of the pulpit, with the north transept and vestry partition behind, looking north-northeast.</i>	6/10/2016	North-northeast

*Holy Cross Church, Taibach, Neath Port Talbot
Photographic Survey*

Photo Number	Description	Date Taken	Direction
HCT2016_063	<i>View of the pulpit, with the north transept and vestry partition behind, looking east-northeast.</i>	6/10/2016	East-northeast
HCT2016_064	<i>Close up view of the pulpit, looking northeast.</i>	6/10/2016	Northeast
HCT2016_065	<i>View of the pulpit, with the nave behind, looking west-northwest.</i>	6/10/2016	West-northwest
HCT2016_066	<i>Close up of decorative ironwork on pulpit, looking north-northwest.</i>	6/10/2016	North-northwest
HCT2016_067	<i>View of the Hymn Board on the south wall of the nave, looking south-southwest.</i>	6/10/2016	South-southwest
HCT2016_068	<i>View of the baptismal font, looking east-northeast.</i>	6/10/2016	East-northeast
HCT2016_069	<i>View of the baptismal font, looking south-southeast.</i>	6/10/2016	South-southeast
HCT2016_070	<i>View of the baptismal font, looking south-southwest.</i>	6/10/2016	South-southwest
HCT2016_071	<i>Detail of the cross and heraldic shields at the top of the rood screen between the chancel and nave, looking east-southeast. Taken from a stepladder.</i>	6/10/2016	East-southeast
HCT2016_072	<i>Close up of the detail on the cross on top of the rood screen, looking east-southeast.</i>	6/10/2016	East-southeast
HCT2016_073	<i>Internal close-up of the rose window in the west end of the nave, looking west-northwest. Taken from a stepladder.</i>	6/10/2016	West-northwest
HCT2016_074	<i>1827 foundation board, hung on west wall of nave, to northern side of main entrance door, looking west-northwest.</i>	6/10/2016	West-northwest
HCT2016_075	<i>Internal view of main door into nave through the west wall, looking west-northwest.</i>	6/10/2016	West-northwest
HCT2016_076	<i>Churchyard gates, taken down due to the entrance being widened and stored in porch, looking west-northwest.</i>	6/10/2016	West-northwest
HCT2016_077	<i>Church notice board, originally displayed in the churchyard, removed to the porch for storage, looking west-northwest.</i>	6/10/2016	West-northwest

*Holy Cross Church, Taibach, Neath Port Talbot
Photographic Survey*

Photo Number	Description	Date Taken	Direction
HCT2016_078	<i>View of pews along north side of nave, with developer Mr Malcolm Evans, a former member of the church, in foreground, looking northwest.</i>	6/10/2016	Northwest

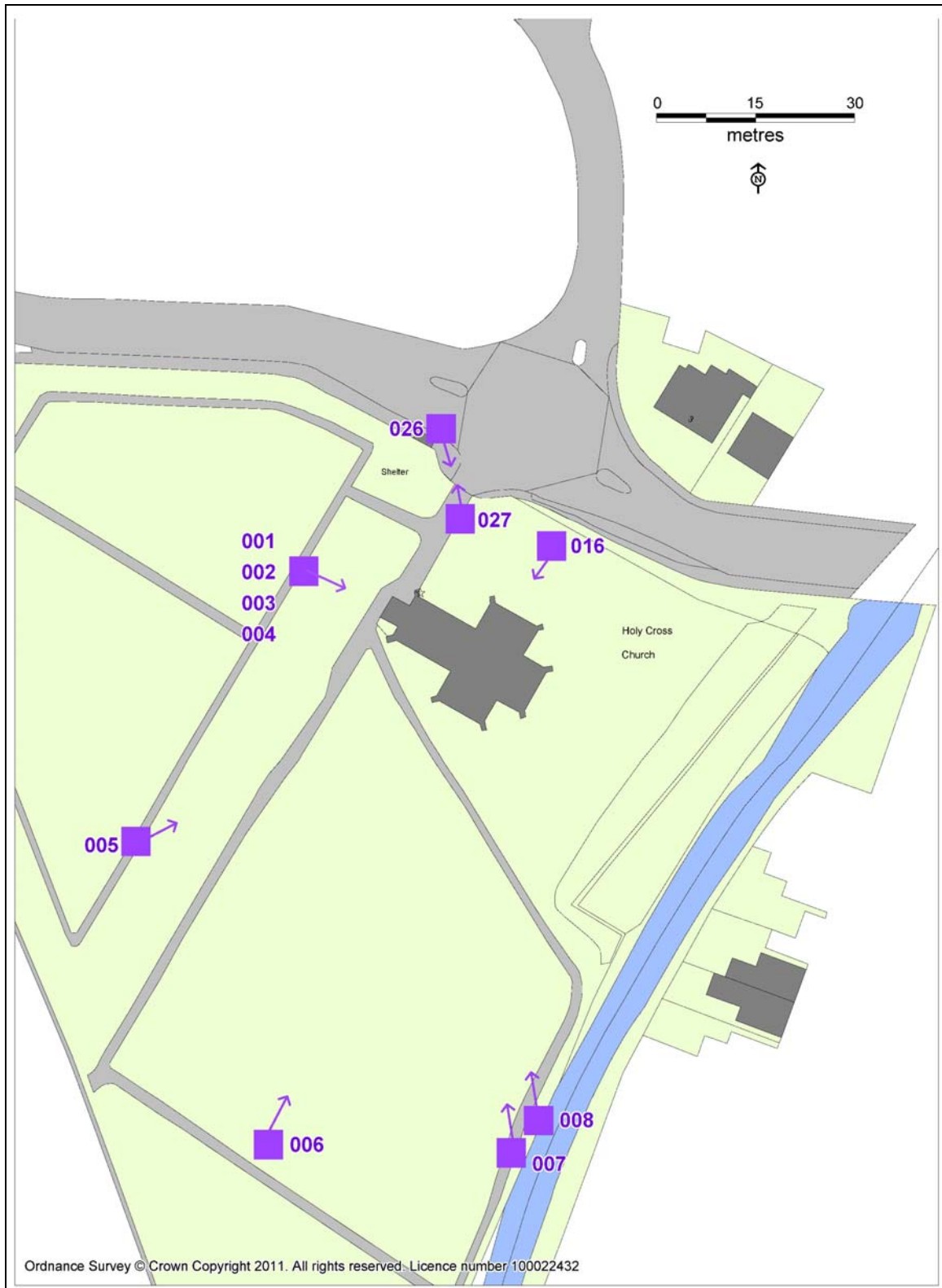

Figure 5: Location of photographs. Long views of the church from within the churchyard.

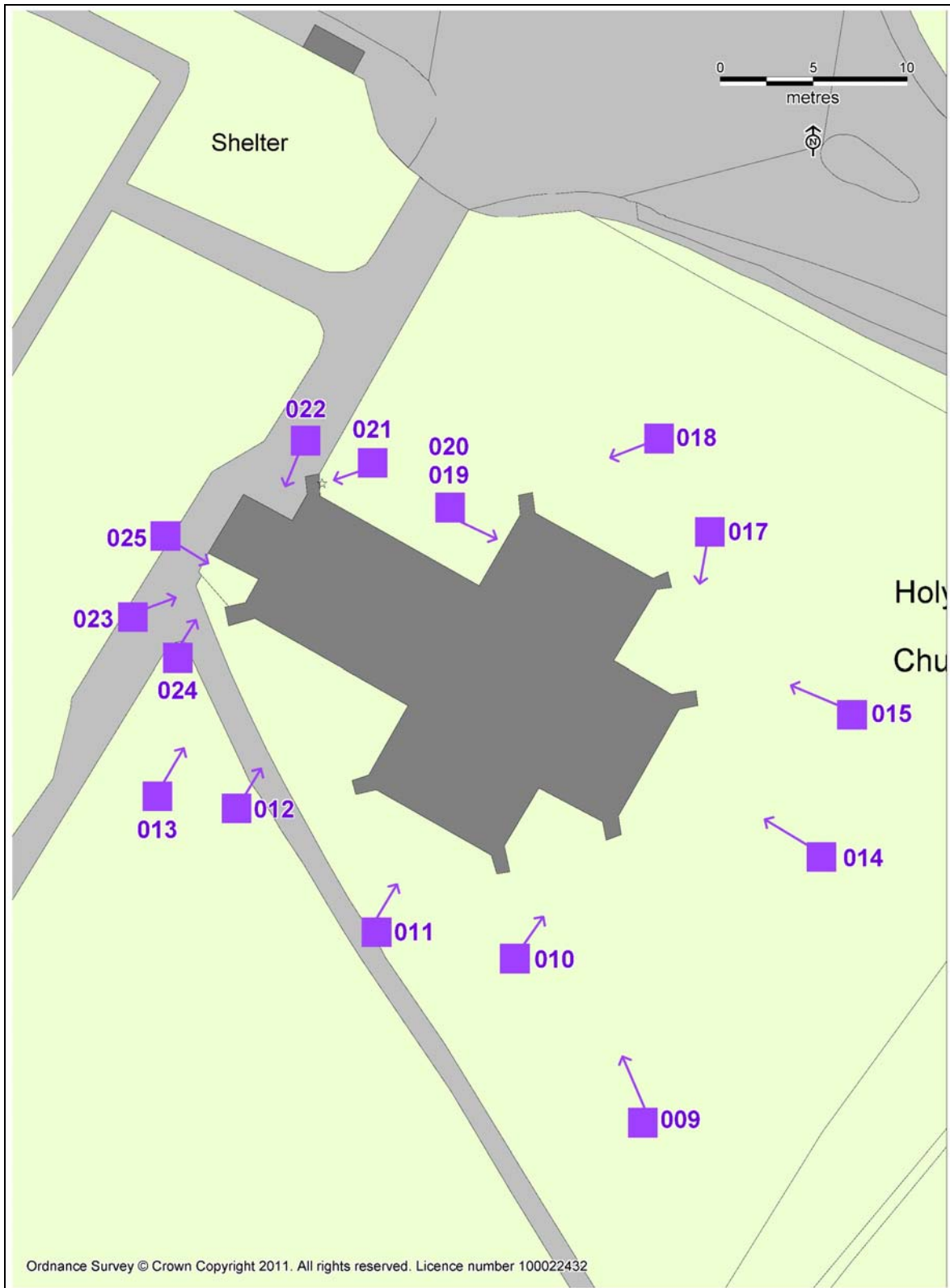

Figure 6: Location of photographs. Shorter views of the church from within the churchyard.

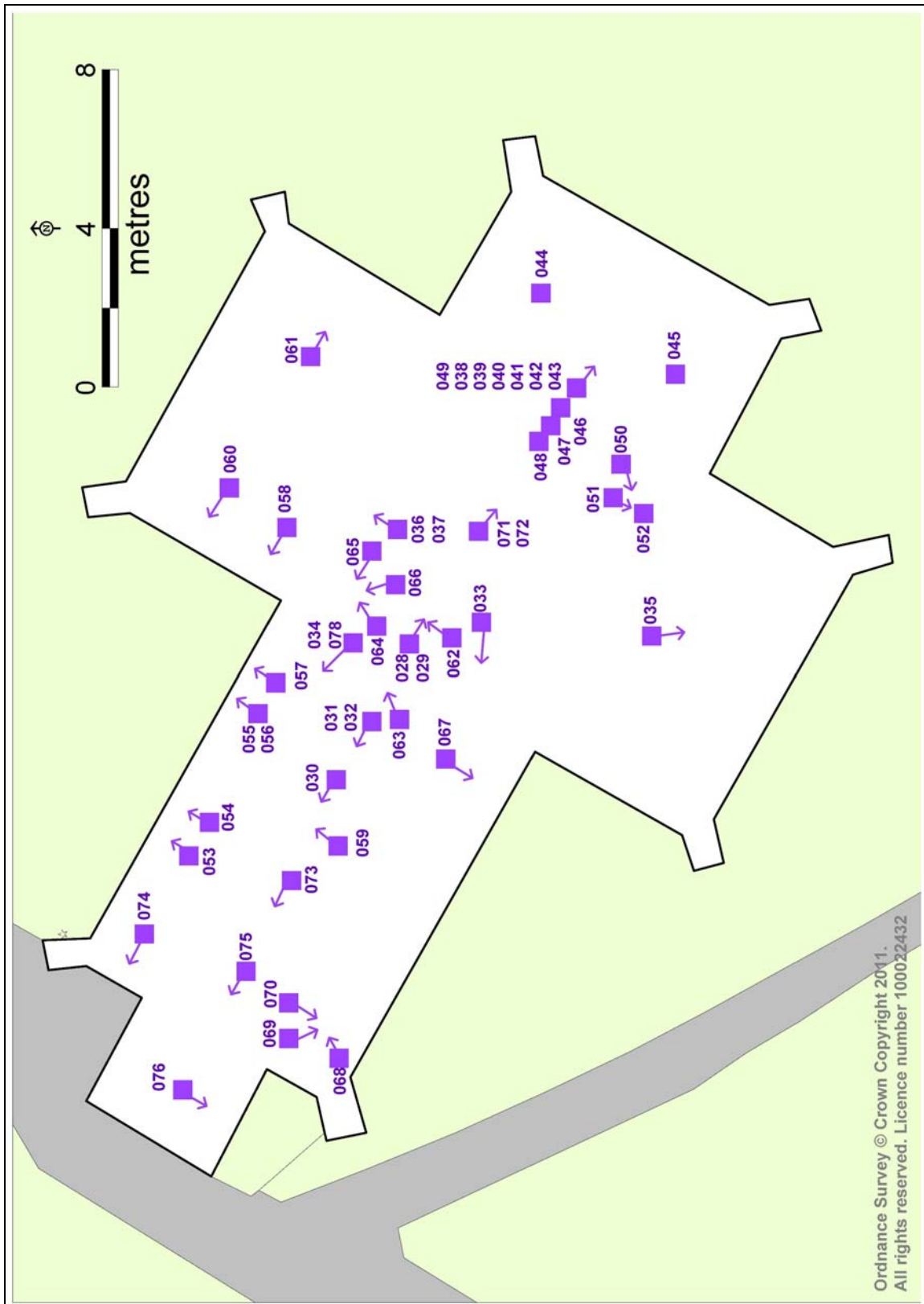

Figure 7: Location of photographs. Internal photographs.

9. Conclusion

9.1 As the church is being converted for use as chapel of rest, the conversion work is generally sympathetic. The alterations to the building do not impact significantly on the original fabric or fixtures and fittings of the building. Additions such as the internal partition walls for the workshop area or the lighting canopy erected in the nave could be removed at a later date with little impact on the building fabric or internal features.

9.2 Research has shown that an earlier photographic survey in 2009, undertaken for Friends of Friendless Churches, captured the building shortly after closure and provides a good record of the condition of the structure before any modern work was undertaken. This survey shows the church organ in place, before it was sold and removed.

9.3 A detailed plan and elevations of the church were also made by Page & Dean Ltd of Peterstone, Wentloog, in 2011. This plan was made after the organ had been removed from the church, but otherwise captures the layout of the building as it was at the end of its use as a place of worship.

10. Archive

10.1 The archive and a copy of the report and photographs will be deposited with the National Monuments Record, Aberystwyth. Photographs are in TIFF format, following the standard required by the RCAHMW.

10.2 A further pdf copy of the report and photographic archive will be supplied to the Historic Environment Record at Glamorgan Gwent Archaeological Trust, Swansea.

11. Sources

Chartered Institute for Archaeologists, 2014, *Standard and Guidance for the creation, compilation, transfer and deposition of archaeological archives*, available online from the CIfA website, www.archaeologists.net

Haycock, E., 1827, *Plan of Holy Cross, Taibach*, in the Incorporated Church Building Society Collection, ICBS00529 in the Lambeth Palace Library Archive.

Newman, J., 2001, *The Buildings of Wales: Glamorgan*, 2nd edition. University of Wales Press.

Orrin, G.R., 2004, *Church Building and Restoration in Victorian Glamorgan*. University of Wales Press.

Stained Glass in Wales website, llgc.org.uk

Rees, L., 2013, "Remembering Holy Cross". Port Talbot Historical Society website <http://www.historicalporttalbot.com/blogging-port-talbot/remembering-holy-cross>

APPENDIX A – Written Scheme of Investigation

WRITTEN SCHEME OF INVESTIGATION FOR HOLY CROSS CHURCH, TAIBACH

Contents

1	Introduction	1
2.	Objective of the Written Scheme of Investigation	2
3.	The Development	2
4.	Conditions on the Listed Building consent	2
5.	Nature of the Archaeological Resource	2
6.	Scope of Work	3
7.	Methodology	3
8.	Health & Safety	3
9.	Reporting	3
10.	Dissemination	3
11.	Archive	4
12.	Resources to be used	4
13.	Qualification of personnel	4
14.	Insurance & Professional indemnity	4
15.	Project identification	4
16.	Monitoring	4
17.	Sources	4

HOLY CROSS, TAIBACH WRITTEN SCHEME OF INVESTIGATION

Listed Building application – P2016/0323 (Neath Port Talbot)

1. Introduction

1.1 Ron Bagshaw of Wood Field House, Rosser Terrace, Cilfrew, Neath SA10 8LH, on behalf of his client, has commissioned Trysor heritage consultants to write a Written Scheme of Investigation relating to Listed Building Consent for planning application number: P2016/0323 (Neath Port Talbot)

1.2 The development is at SS7754889517, north of the M4 in Taibach.

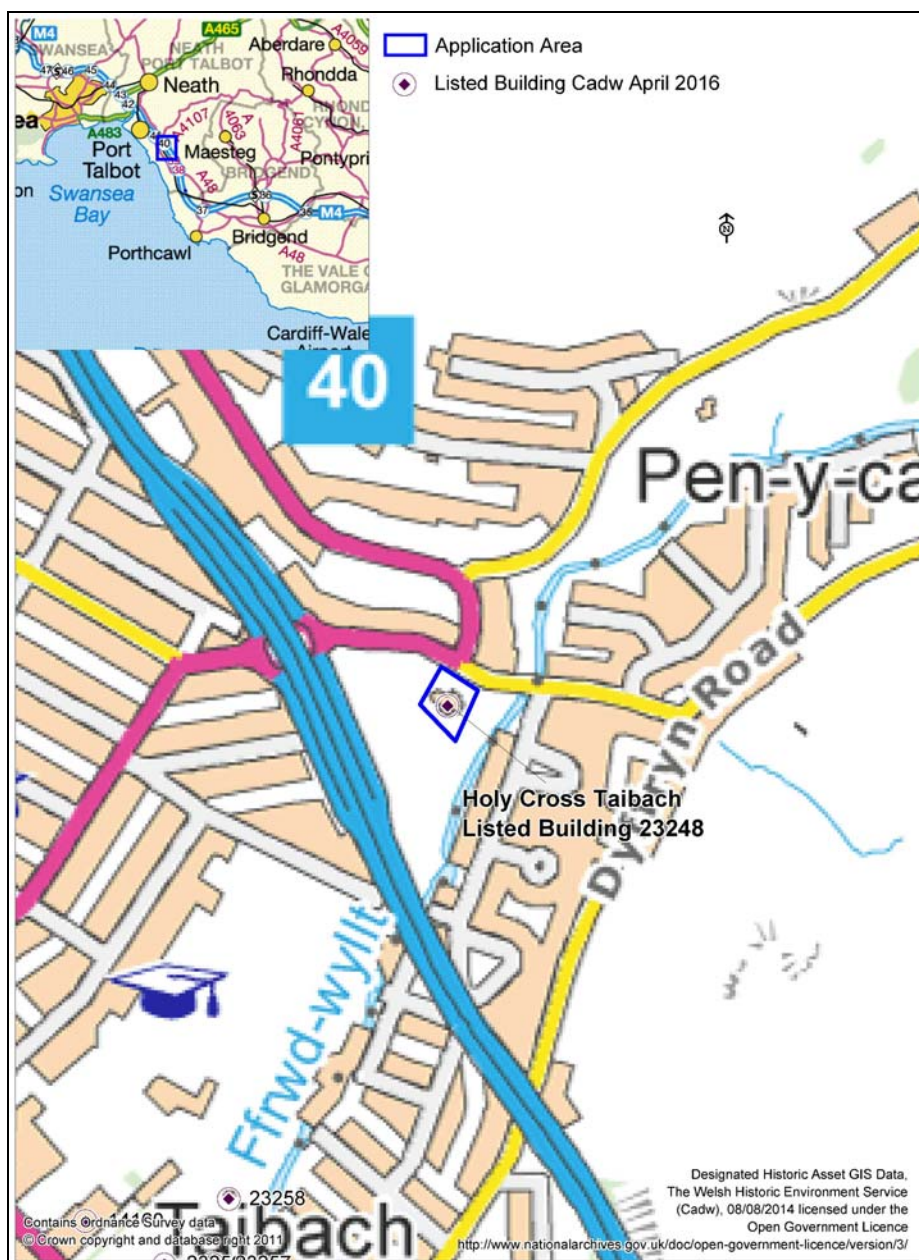

Figure 1: Location of Holy Cross Church, Taibach

2. Objective of the Written Scheme of Investigation

2.1 The objective of this written scheme of investigation (WSI) is to specify the method to be used for the programme of building recording.

3. The development

3.1 The development consists of alterations to the redundant church at Holy Cross, Taibach to convert it into a chapel of rest.

3.2 The works will consist of widening the existing access way and pathway with relocation of stone pillars and insertion of new access gates, reuse of existing entrance gates to be re-sited across the external door of vestry, internal partition walls, and disabled toilet with associated cess pit

4. Conditions on the Listed Building consent

4.1 In granting approval for the application, the Local Planning Authority imposed a condition on the consent; the condition specifies the actions necessary to mitigate the impact of the development on the built resource.

No works to which this consent relates shall commence until an appropriate programme of historic building recording and analysis has been secured and implemented in accordance with a written scheme of investigation which has been submitted and approved in writing by the local planning authority.

Reason

As the building is of architectural and cultural significance the specified records are required to mitigate impact.

5. Nature of the archaeological resource

5.1 Holy Cross church, Taibach is a Grade II listed building, Listed Building number 23248. It is recorded in the National Monuments Record as NPRN 414438.

5.2 The church was originally built in 1827 as a chapel of ease to Margam parish church. It was designed by Edward Haycock of Shrewsbury in a pre-archaeological gothic style and built on land donated by CRM Talbot of the Margam Estate.

5.3 In 1903, the chapel was enhanced by G.E.Halliday, including the insertion of an ornate rood screen.

5.4 The church closed in 2008 due to health and safety issues.

5.5 A plan of the church as it was in January 2011 was drawn by Page & Dean Ltd of Peterstone, Wentloog, with elevation, along with four elevations, of the east, south, west and north faces of the building, and 8 cross sections across the building. The elevations show details of quoinstones/buttresses, roof line, the surrounds of the doors and windows and the door and windows themselves. The cross sections show masonry detail including location of plaques and wood fittings including the rood screen. These drawings have been deposited with the National Monuments Record in Aberystwyth, NPRN 414438.

6. Scope of Work

6.1 Historic England's *Understanding Historic Buildings: A guide to good recording practice* was used to write this Written Scheme of Investigation. They define a Level 2 record as

“...as a **descriptive record**, made in similar circumstances to Level 1 but when more information is needed. It may be made of a building which is judged not to require a more detailed record, or it may serve to gather data for a wider project. Both the exterior and interior of the building will be seen, described and photographed. The examination of the building will produce an analysis of its development and use and the record will include the conclusions reached, but it will not discuss in detail the evidence on which this analysis is based. A plan and sometimes other drawings may be made but the drawn record will normally not be comprehensive and may be tailored to the scope of a wider project.

6.2 A Level 2 record of the buildings will be made to record the interior and exteriors of the building (Historic England, 2016, p,26).

7. Methodology

7.1 The building recording will be carried out in accordance with Chartered Institute for Archaeologists' *Standard and Guidance for the Archaeological Investigation and Recording of Standing Buildings or Structures* (CIfA, 2014a) and according to the description of a Level 2 in Historic England's guide.

7.2 Colour digital photographs will be taken using a 16M pixel camera. A written record will be made on site of the photographs taken. Appropriate photographic scales will be used.

7.3 The copies of the archive drawings deposited with the NMR in 2011, subject to agreement with the RCAHMW, will be used as a base on which additional annotations will be made.

8. Health & Safety

8.1 Trysor will undertake a risk assessment in accordance with their health and safety policy.

9. Reporting

9.1 A report on the building recording will be prepared according to the requirements of Annex 2 of the Chartered Institute for Archaeologists' *Standard and Guidance for the Archaeological Investigation and Recording of Standing Buildings or Structures* (CIfA, 2014a, p.19) following the completion of the work. Copies of the report will be provided to the client, the Regional Historic Environment Record and the National Monuments Record.

10. Dissemination

10.1 A summary of the work undertaken and its findings will be submitted to *Archaeology in Wales*, if appropriate, the annual review of archaeological work in Wales collated the Council for British Archaeology Wales (CBA Wales)

11. Archive

11.1 The archive will be deposited with the National Monuments Record, including a copy of the final report in accordance with the CIfA's *Standard and Guidance for the creation, compilation, transfer and deposition of archaeological archives* (CIfA, 2013b). This archive will include all written, drawn and photographic records relating directly to the investigations undertaken. Digital archives will follow the standard required by the RCAHMW (RCAHMW, 2015).

12. Resources to be used

12.1 Two members of staff will undertake the building recording. They will be equipped with standard field equipment, including digital cameras, GPS and first aid kits. Trysor have access to the computer hardware and software required to deliver the completed final report and archive to a professional standard.

13. Qualification of personnel

13.1 Trysor is a Registered Organisation with the Chartered Institute for Archaeologists and both partners are Members of the Chartered Institute for Archaeologists, www.archaeologists.net

13.2 Jenny Hall (BSc Joint Hons., Geology and Archaeology, MCIfA) had 12 years excavation experience, which included undertaking watching briefs prior to becoming the Sites and Monuments Record Manager for a Welsh Archaeological Trust for 10 years. Since 2004 she has been an independent archaeologist undertaking a variety of work that includes upland survey, desktop assessments and watching briefs.

13.3 Paul Sambrook (BA Joint Hons., Archaeology and Welsh, MCIfA, PGCE) has extensive experience as a fieldworker in Wales. He was involved with Cadw's pan-Wales Deserted Rural Settlements Project for 7 years. He also undertook Tir Gofal field survey work and watching briefs. Since 2004 he has been an independent archaeologist undertaking a variety of work that includes upland survey, desktop assessments and watching briefs.

14. Insurance & Professional indemnity

14.1 Trysor has Public Liability and Professional Indemnity Insurance.

15. Project identification

15.1 The project has been designated Trysor Project No. 2016/534

16. Monitoring

16.1 Staff from Neath Port Talbot LPA will be welcome to visit the site and monitor the work.

17. Sources

17.1 Non-published

RCAHMW, 2015, *RCAHMW guidelines for Digital Archives*, Version 1

17.2 Published

CIfA, 2014a, *Standard and Guidance for the Archaeological Investigation and Recording of Standing Buildings or Structures*

CIfA, 2014c, *Standard and Guidance for the creation, compilation, transfer and deposition of archaeological archives*

Historic England, 2016, Understanding Historic Buildings: A Guide to Good Recording Practice

17.3 Web based materials

Historic Wales, <http://historicwales.gov.uk/>, accessed 16/08/2016

17.4 Data Sources

Cadw, Listed Building all-Wales dataset, supplied April 2016

Jenny Hall & Paul Sambrook
Trydor, August 2016

APPENDIX B: PHOTOGRAPHS



Plate 1: HCT2016_001, External view of western end of church, looking east-southeast.



Plate 2: HCT2016_002, Detail of bellcote, looking east-southeast.



Plate 3: HCT2016_003, Upper part of western end of church, showing base of bellcote, looking east-southeast.



Plate 4: HCT2016_004, Rose window in western end of church, looking east-southeast.



Plate 5: HCT2016_005, External view of church, looking east-northeast.



Plate 6: HCT2016_006, External view of southern side of church, looking north-northeast.



Plate 7: HCT2016_007, External view of church, looking north-northwest.



Plate 8: HCT2016_008, External view of church, looking north-northwest (zoomed in).



Plate

9: HCT2016_009, External view of church, looking north-northwest.



Plate 10: HCT2016_010, External view of southern chancel wall, looking north-northeast.



Plate 11: HCT2016_011, External view of south wall of south transept, looking north-northeast.



Plate 12: HCT2016_012, External view of south side of nave, looking north-northeast.



Plate 13: HCT2016_013, External view of south side of porch, looking north-northeast.



Plate 14: HCT2016_014, External view of east-southeast end of church, looking west-northwest.



Plate 15: HCT2016_015, External view of east wall of the north transept, looking west-northwest.



Plate 16: HCT2016_016, External view of north

wall of north transept, looking south-southwest.



Plate 17: HCT2016_017, External view of northern chancel wall, looking south.



Plate 18: HCT2016_018, External view of northern side of the nave, looking west-southwest.

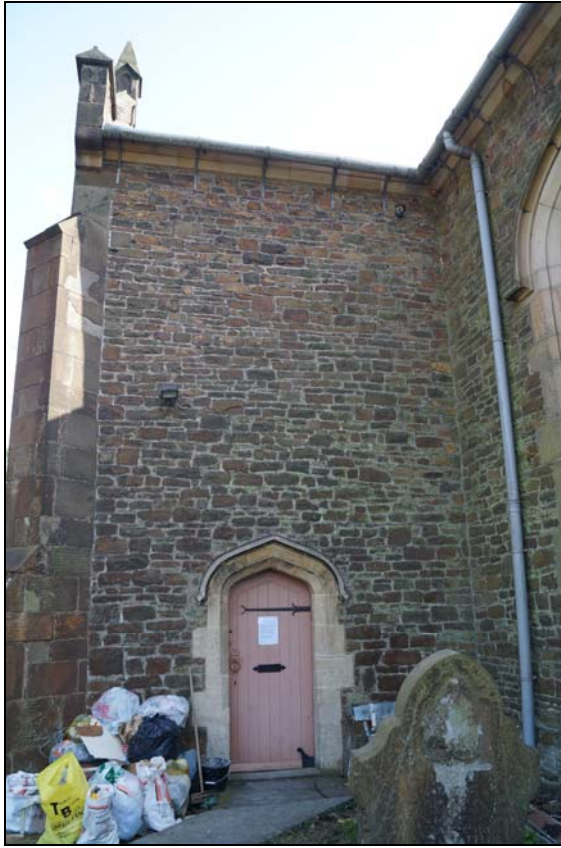

Plate 19: HCT2016_019, External view of western wall of northern transept, including door into transept/vestry, looking east-southeast.



Plate 20: HCT2016_020, External view of

transept/vestry door, looking east-southeast.



Plate 21: HCT2016_021, Detail of benchmark on buttress at the western end of the church, looking west-southwest.



Plate 22: HCT2016_022, External view of

porch entrance, looking south-southwest.



Plate 23: HCT2016_023, External view of southern wall of porch, looking east-northeast.



*Plate 24: HCT2016_024, External view of
north wall porch, looking north-northeast.*



Plate 25: HCT2016_025, Detail of railings in front of western end of church, looking east-southeast.



Plate 26: HCT2016_026, View of gate pillars at entrance to churchyard with the eastern pillar under reconstruction after the entrance has been widened, looking south-southeast.



Plate 27: HCT2016_027, View of the intact western gate pillar at the entrance to the churchyard, looking north-northwest.



Plate 28: HCT2016_028, Internal view of the chancel, showing rood screen and cross, looking east-southeast.



Plate 29: HCT2016_029, Internal view of the chancel, showing altar, chancel floor and pews, looking east-southeast. Taken from a stepladder.



Plate 30: HCT2016_030, View of the main door in the western end of the church, with the rose window above, looking west-northwest along

the nave. Taken from a stepladder.



Plate 31: HCT2016_031, Internal view of the nave, showing the rose window above the main entrance, as well as the new "canopies" erected over the pews along either side of the nave. Also showing the western end of the church roof and a roof beam. Looking west-northwest. Taken from a stepladder.



Plate 32: HCT2016_032, Internal view of the nave,

looking west-northwest. Taken from a stepladder.



Plate 33: HCT2016_033, Internal view of the pews along the southern side of the nave, looking southwest.



Plate 34: HCT2016_034, Internal view of the pews along the northern side of the nave, looking northwest.



Plate 35: HCT2016_035, Internal view into new workshop inserted into south transept, looking south.



Plate 36: HCT2016_036, Internal view of north transept, showing the pulpit, the partition creating the vestry area and the doorway leading into the vestry, looking north-northeast.



Plate 37: HCT2016_037, Internal view of north transept, looking north-northeast.



Plate 38: HCT2016_038, Internal view of stained-glass

window in east wall of chancel, looking east-southeast.



Plate 39: HCT2016_039, View of altar at eastern end of church, looking east-southeast.



Plate 40: HCT2016_040, View of altar at eastern end of church, with the purple altar hanging used for Lent and funerals hung in front, looking east-southeast.



Plate 41: HCT2016_041, View of altar at eastern end of church, with the white altar hanging used for weddings, Christmas and Easter hung in front, looking east-southeast.



Plate 42: HCT2016_042, View of altar at eastern end of church, with the green altar hanging used for Trinity hung in front, looking east-southeast.



Plate 43: HCT2016_043, View of altar at eastern end of church, with the red altar hanging used for Whitsun hung in front, looking east-southeast.



Plate 44: HCT2016_044, A decorative 6" x 6" floor tile in the sanctuary, before the altar, looking east-southeast.



Plate 45: HCT2016_045, A decorative 6" x 6" floor tile in the sanctuary, before the altar, looking east-southeast.



Plate 46: HCT2016_046, A decorative 6" x 6" floor tile in the chancel, the eastern tile of three, looking east-southeast.



Plate 47: HCT2016_047, A decorative 6" x 6" floor tile in the chancel, the central tile of three, looking east-southeast.



Plate 48: HCT2016_048, A decorative 6" x 6" floor tile in the chancel, the western tile of three, looking east-southeast.



Plate 49: HCT2016_049, Detail of the decorative panelling on the front of the altar, looking east-southeast.



Plate 50: HCT2016_050, Seat in southern side of chancel from where notices are given, looking west-southwest.



Plate 51: HCT2016_051, Seat in southern side of chancel from where notices are given, looking south-southwest.

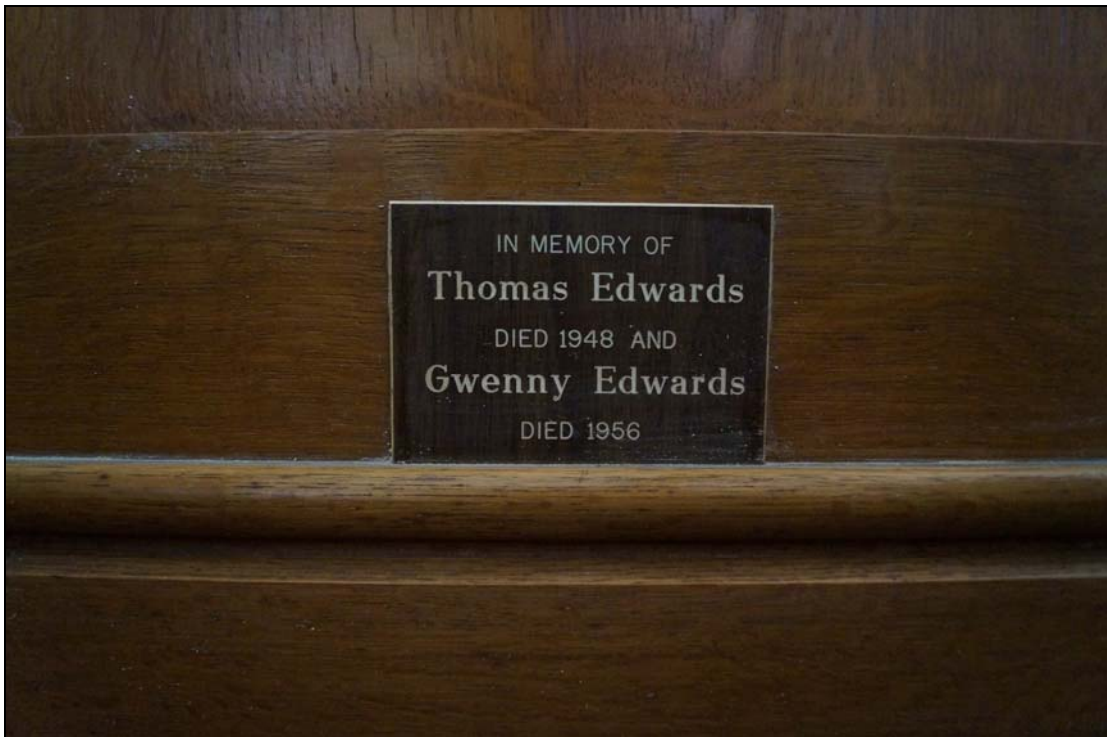

Plate 52: HCT2016_052, Plaque fixed in front of seat box in southern side of chancel from where notices are given, looking south-southwest. "In Memory of Thomas Edwards Died 1948 and Gwenny Edwards Died 1956"



Plate 53: HCT2016_053, View of a plaque on the north wall of the nave, looking north-northeast. "In Memory of Hopkin Llewellyn Prichard Esq."



Plate 54: HCT2016_054, View of a plaque on the north wall of the nave, looking north-northeast. "In Memory of my wife Margaret Jenkins."



Plate 55: HCT2016_055, View of the Hymn Board on the north wall of the nave, looking north-northeast.



Plate 56: HCT2016_056, View of a memorial plaque on the Hymn Board on the north wall of the nave, looking north-northeast. "In Memory of Augustus G. Sims presented by his wife and family"



Plate 57: HCT2016_057, View of a marble memorial tablet on the north wall of the nave, looking north-northeast. "Sacred to the memory of Robert Lindsay of Glan Afon Taibach Esquire"



Plate 58: HCT2016_058, View of a memorial plaque on the west wall of the north transept, looking west-northwest. "In Affectionate Memory of Augusta Emily 2nd Daughter of the 3rd Earl of Dunraven.



Plate 59: HCT2016_059, View of the pews in the northern side of the nave, looking north-northeast.



Plate 60: HCT2016_060, Internal view of vestry door in west wall of north transept, looking west-northwest.



Plate 61: HCT2016_061, Photograph hung on the east wall of the vestry in the north transept, showing the Holy Cross Church Choir in 1968, looking east-southeast.



Plate 62: HCT2016_062, View of the pulpit, with the north transept and vestry partition behind, looking north-northeast.



Plate 63: HCT2016_063, View of the pulpit, looking east-northeast.



Plate 64: HCT2016_064, Close up view of

the pulpit, looking northeast.



Plate 65: HCT2016_065, View of the pulpit, with the nave behind, looking west-northwest.

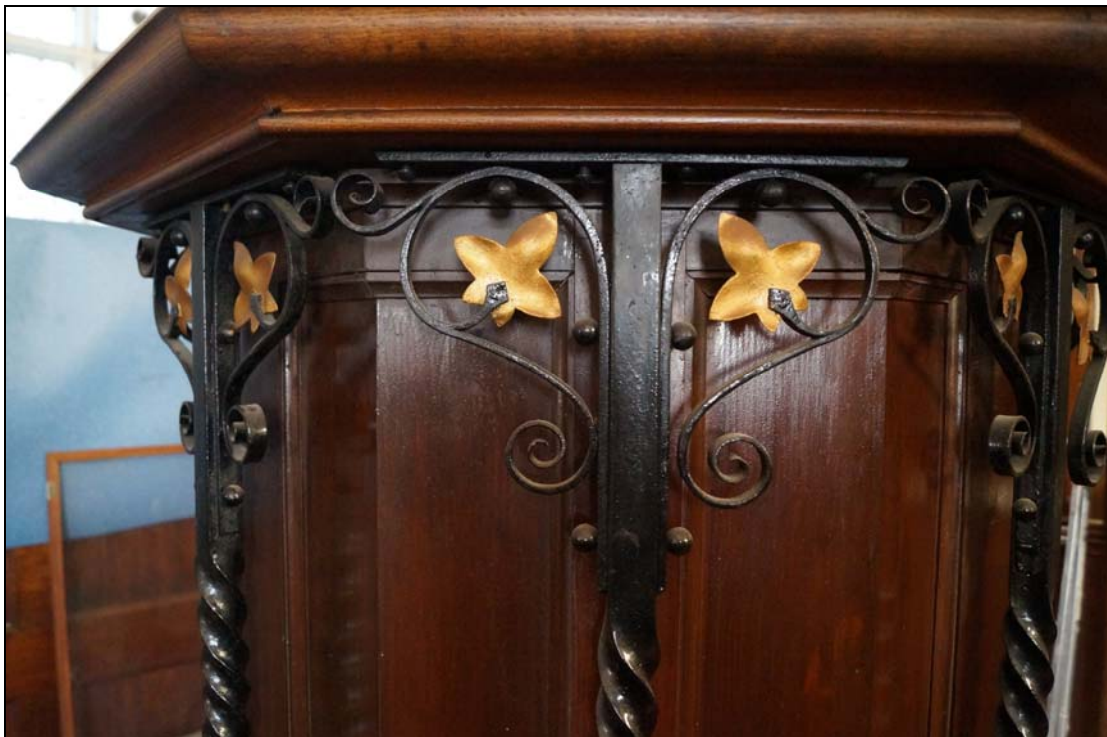

Plate 66: HCT2016_066, Close up of decorative ironwork on pulpit, looking north-northwest.



Plate 67: HCT2016_067, View of the Hymn Board on the south wall of the nave, looking south-southwest.



Plate 68: HCT2016_068, View of the baptismal font, looking east-northeast



Plate 69: HCT2016_069, View of the baptismal font, looking south-southeast.



Plate 70: HCT2016_070, View of the baptismal font, looking south-southwest.



Plate 71: HCT2016_071, Detail of the cross & heraldic shields at the top of the rood screen between chancel and nave, looking east-southeast. Taken from a stepladder.

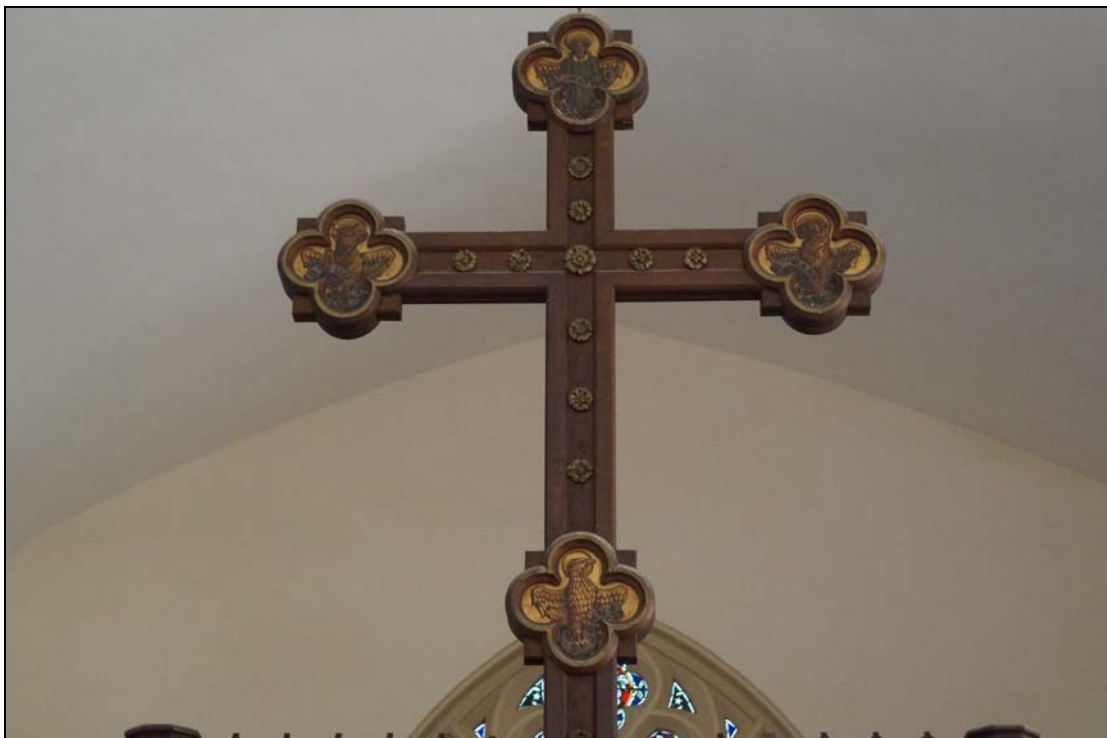

Plate 72: HCT2016_072, Close up of the detail on the cross on top of the rood screen, looking east-southeast.



Plate 73: HCT2016_073, Internal close-up of the rose window in the west end of the nave, looking west-northwest. Taken from a stepladder.

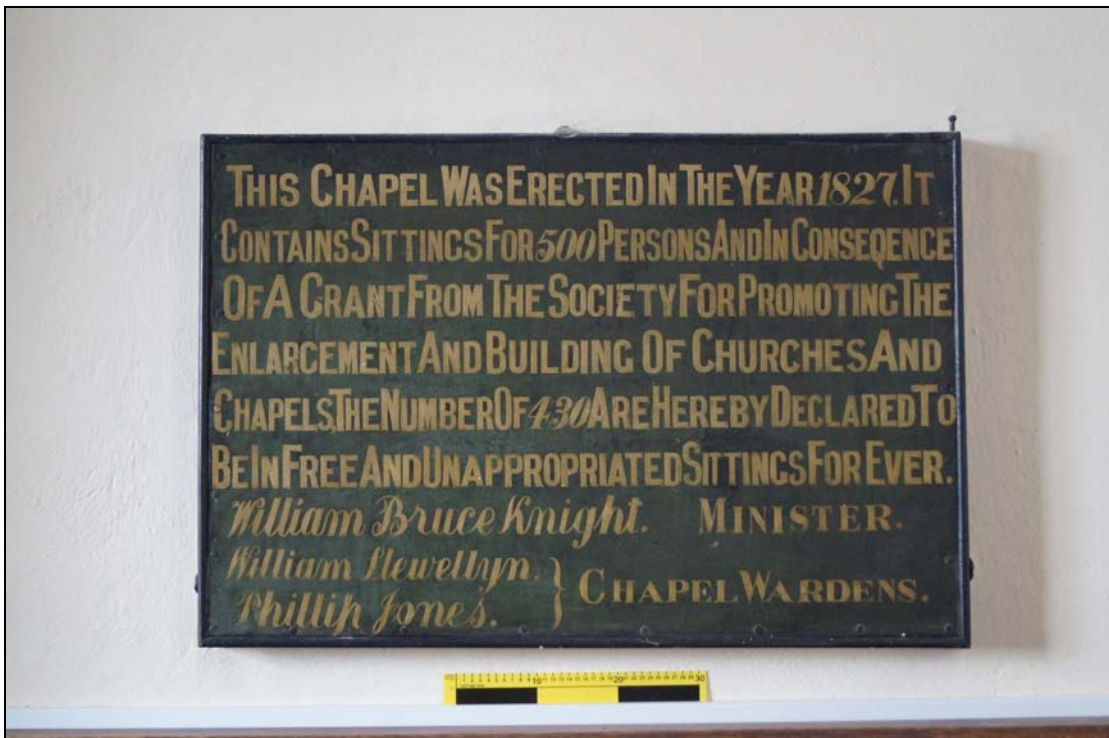

Plate 74: HCT2016_074, 1827 foundation board, hung on west wall of nave, to northern side of main entrance door, looking west-northwest.



Plate 75: HCT2016_075, Internal view of main door into nave through the west wall, looking west-northwest.



Plate 76: HCT2016_076, Churchyard gates,
stored in porch, looking west-northwest.

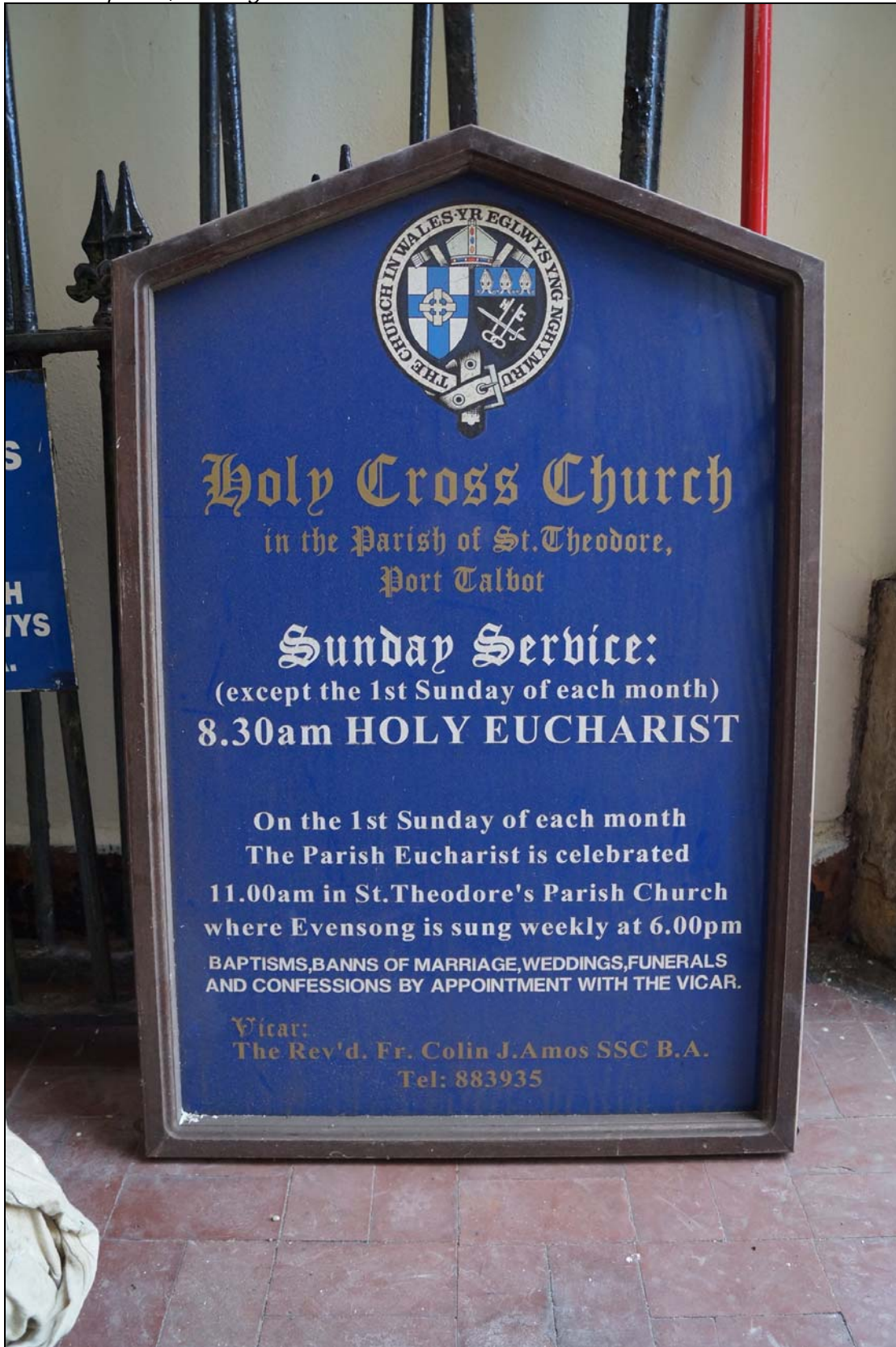

Plate 77: HCT2016_077, Church notice board, originally displayed in the churchyard,
removed to the porch for storage, looking west-northwest.



Plate 78: HCT2016_078, View of pews along north side of nave, looking northwest, with developer Mr Malcolm Evans, a former member of the church, in foreground.