

LEVELS CONTINUED
DOWN SHORTBRIDGE
STREET
5M INTERVALS

166.685
166.745
166.845
166.935
167.35
167.075
167.165

PCC - ECR
19 JUN 2014
RECEIVED

**SURVEY AS EXISTING:
THE OLD SAWMILLS
ADJACENT TO
THE BRIDGEND MILL,
CHAPEL STREET,
LLANIDLOES.**

 **Charles Cowan**
ARCHITECT

Bank House, Great Oak Street, Llanidloes,
Powys, SY18 6BW Tel 01686 413553

DATE	JUNE 07	DRAWN	CC
DWG No	298/S05	REV	

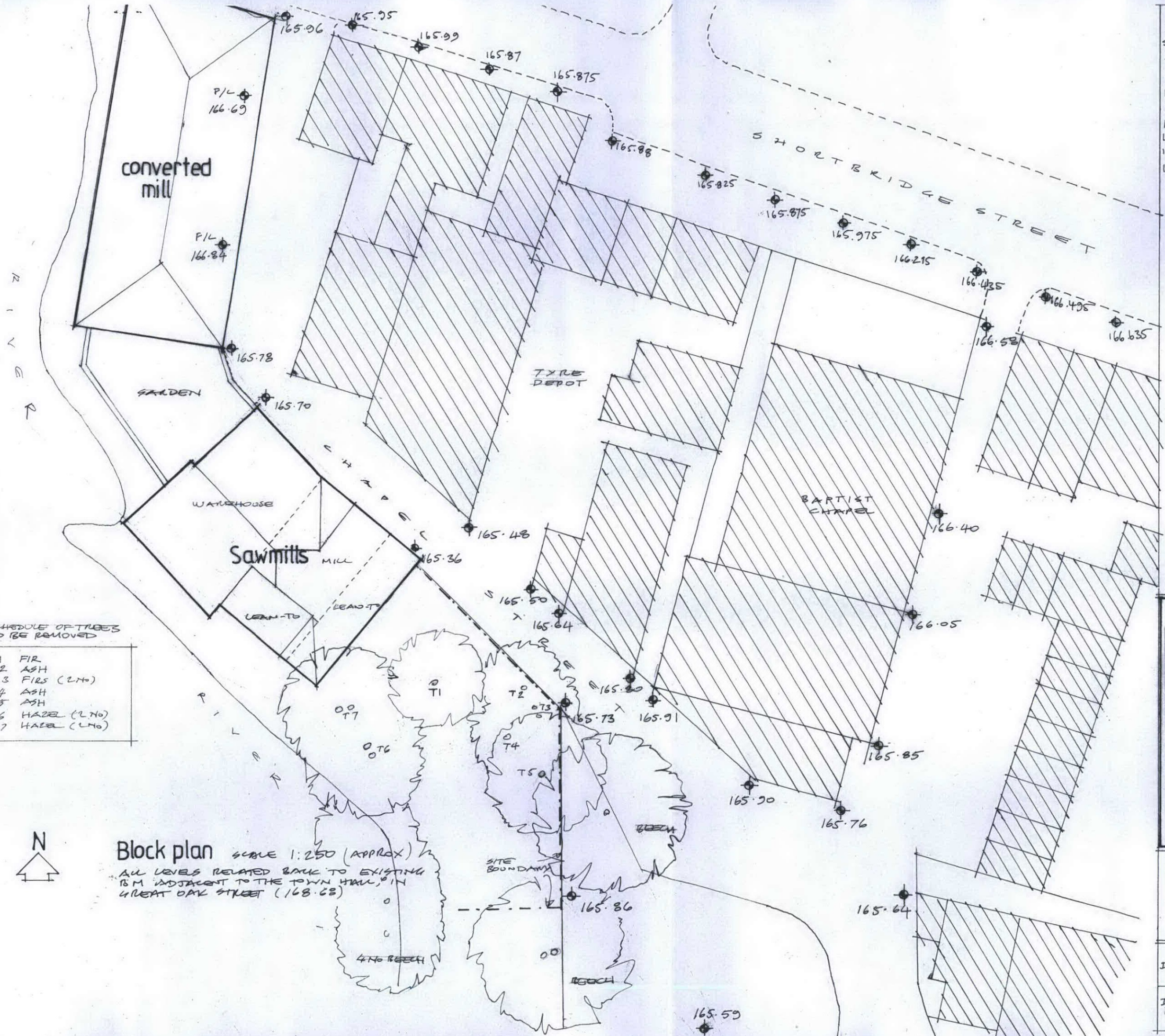

SCHEDULE OF TREES
TO BE REMOVED

T1	FIR
T2	ASH
T3	FIRS (LHO)
T4	ASH
T5	ASH
T6	HAZEL (LHO)
T7	HAZEL (LHO)

Block plan SCALE 1:250 (APPROX)
ALL LEVELS RELATED BACK TO EXISTING
15M ADJACENT TO THE TOWN HALL, IN
GREAT OAK STREET (168.68)