

Landway Farm, Jameston, Pembrokeshire Archaeological Appraisal



Report by: Trysor

For: Mr and Mrs Thomas

February 2013



Landway Farm, Jameston, Pembrokeshire Archaeological Appraisal

By

Jenny Hall, MIfA & Paul Sambrook, MIfA
Trysor

Trysor Project No. 2013/281

For: Mr and Mrs Thomas

February 2013

38, New Road
Gwaun-cae-Gurwen
Ammanford
Carmarthenshire
SA18 1UN
www.trysor.net
enquiries@trysor.net



Cover photograph: View from the proposed location of the turbine, looking north towards Landway Farm

Landway Farm, Jameston, Pembrokeshire Archaeological Appraisal

RHIF YR ADRODDIAD - REPORT NUMBER: Trysor 2013/281

DYDDIAD 28^{fed} Chwefror 2013

DATE 28th February 2013

Paratowyd yr adroddiad hwn gan bartneriad Trysor. Mae wedi ei gael yn gywir ac yn derbyn ein sêl bendith.

This report was prepared by the Trysor partners. It has been checked and received our approval.

JENNY HALL MifA

Jenny Hall

PAUL SAMBROOK MifA

Paul Sambrook

DYDDIAD

DATE

28/02/2013

Croesawn unrhyw sylwadau ar gynnwys neu strwythur yr adroddiad hwn.

We welcome any comments on the content or structure of this report.

*38, New Road,
Gwaun-cae-Gurwen
Ammanford
Carmarthenshire
SA18 1UN
01269 826397*

*Treclyn
Eglywswrw
Crymych
Pembrokeshire
SA41 3SU
01239 891470*

www.trysor.net

enquiries@trysor.net

Contents

1. Summary	1
2. Copyright	1
3. Introduction	1
4. The Proposed Development	1
5. Methodology	3
6. Landway Farm Historical Overview	6
7. Landway Farm Proposed Turbine Site	7
8. Impact Assessment	10
9. Historic Landscape Aspects Relating to the Landway Farm Proposed Turbine	17
10. Conclusion	20
11. Reporting	20
12. References	21
Appendix A: Landway Farm Impacts	22
Appendix B: Descriptions of Newly Recorded Sites	44
Appendix C: Site Appraisals within the Revised Study Area	46

1. Summary

This archaeological appraisal has been undertaken by Trysor to examine likely impacts on the historic environment from a proposed wind turbine at Landway Farm, Jameston, Pembrokeshire.

The appraisal has looked at all known historic assets within an area measuring 2km in radius, focused on a central point at the proposed turbine site at SS0557098630, consulting the regional Historic Environment Record and the National Monuments Record, as well as examining historic maps. A field visit was also undertaken to examine the location of the turbine and record previously unknown historic assets.

The appraisal shows that there is no evidence of a Mesolithic or Neolithic flintworking site at the proposed development site. It also shows and that no direct, physical impact or significant indirect, visual impact would be caused to the historic environment at the turbine site. Furthermore, none of the Scheduled Ancient Monuments within the appraisal area would be affected by the development. With these points in mind, no archaeological mitigation is thought necessary for the proposed development.

2. Copyright

Trysor hold the copyright of this report. Further copies may be made of this report without gaining permission to reproduce but it must be noted that Figures 2 and 4 include other copyrighted material and should not be copied.

3. Introduction

Mr and Mrs Thomas of Landway Farm, Cob Lane, Jameston, Tenby, Pembrokeshire, SA70 8QH commissioned Trysor heritage consultants to write an Historic Environment Appraisal to inform a planning application for a wind turbine at Landway Farm, Jameston, Pembrokeshire

Dyfed Archaeological Trust Heritage Management section supplied a brief for the appraisal, (DAT HM, 2013), which was to be a rapid appraisal of the readily available historic environment information including a site visit. The purpose of the appraisal was to inform DAT HM as to whether any further assessment or evaluation would be required as part of the planning process.

4. The proposed development

It is proposed that one 20kW wind turbine, with 15m high tower and blades of 13.1m diameter will be located in a field south of Landway Farm, Jameston. The turbine is proposed to be located at SS0557098630, see Figure 1.

The turbine will require a foundation hole, 5.5 metres by 5.5 metres and 1 metre deep. A cable trench, approximately 200 metres in length, will run from the turbine to the farmyard, to a point close to SS0559298818.

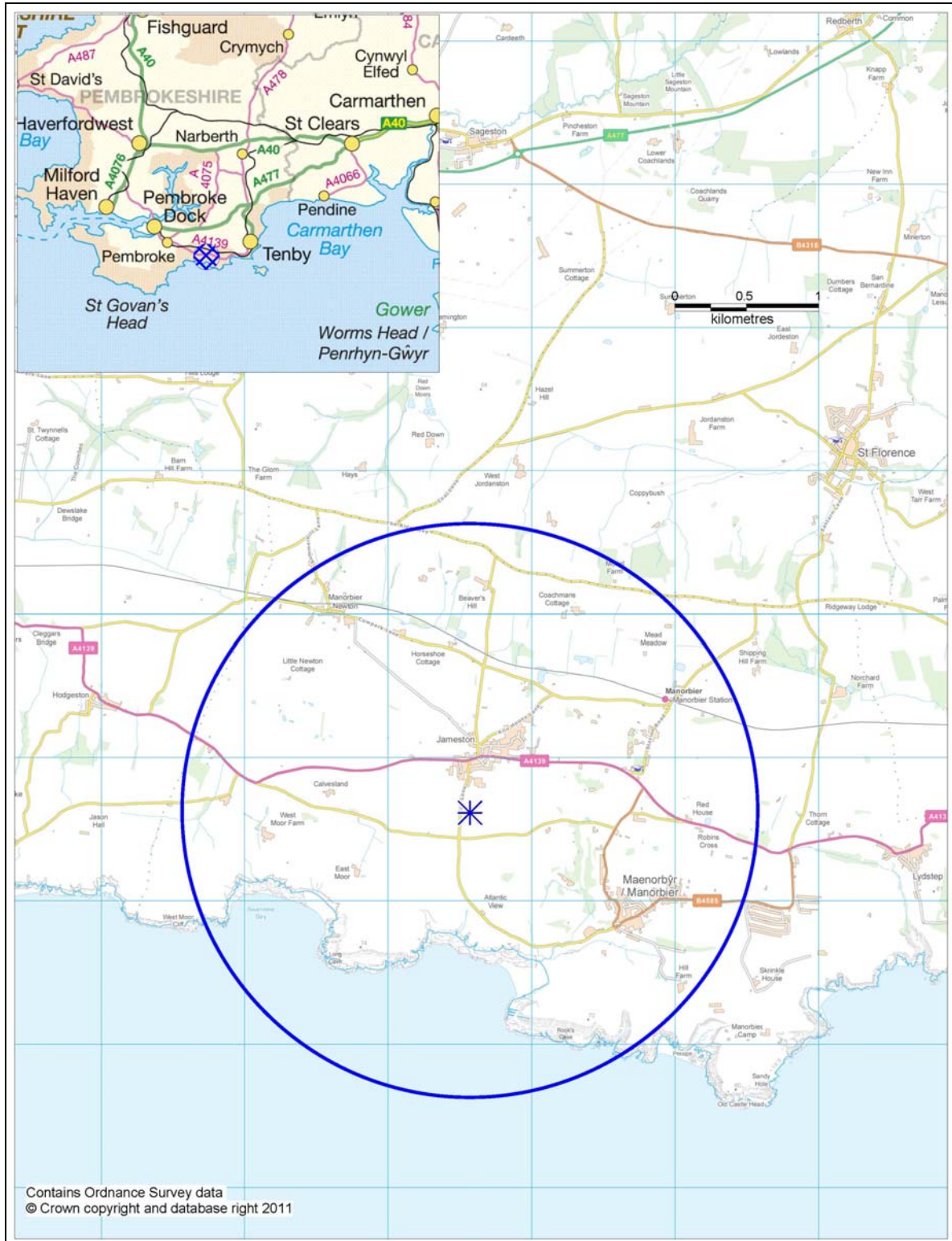

Figure 1: Location of the proposed turbine, showing the 2km radius appraisal area.

5. Methodology

5.1 A study area of 2.5km radius circle centred on SS0557098630 was chosen for the initial appraisal of sites. This was reviewed at an early stage and the area of the appraisal reduced to an area of 2km radius, which was sufficient to include important monuments such as the four Scheduled Ancient Monuments of Bier Hill Round Barrow Cemetery, Manorbier Castle, the King's Quoit Chambered Tomb and Manorbier Dovecote.

5.2 The HER enquiry for the 2km radius area yielded 148 records. Two of these were found to be mislocated and were removed from the appraisal and a further 8 records were removed as they were duplicate records. Of the 138 remaining records, 4 were for Scheduled Ancient Monuments and 27 for Listed Buildings.

5.2.1 Also included within the appraisal area is the Manorbier conservation area. Conservation Areas are defined areas "of special architectural and historic interest, the character or appearance of which it is desirable to preserve or enhance" (Planning (Listed buildings and Conservation Areas) Act 1990).

5.2.2 The proposed development site lies within the East Moor and West Moor Historic Landscape Characterisation area of the Manorbier Landscape of Historic Interest, defined in the Register of Landscapes of Outstanding Historic Interest in Wales (Cadw/ICOMOS/CCW, 1998).

5.3 A site visit was made to Landway Farm and the surrounding area on February 11th, 2013 to rapidly appraise the wider landscape context of the proposed development. During this visit key sites in the wider landscape were visited to assess intervisibility with the proposed development site. The proposed development site was also examined and a field walking exercise carried out around the proposed turbine site to assess the potential for discovering flint artefacts, indicative of Mesolithic or Neolithic flintworking sites, a number of which are known to the south of Landway Farm, in the coastal area.

5.4 The aerial photographs on Google Earth, dating to 2006 and 2009, were used to inform the appraisal.

5.5 Historic mapping was consulted. The maps used included 19th and 20th century 1:2500 scale Ordnance Survey mapping and the Manorbier parish tithe map (1842) and tithe schedule (1840).

5.6 All information gathered during the desktop appraisal and fieldwork was entered into a bespoke database in Access 2003 format to create an appraisal dataset. The dataset is the source of the material output in this report, including the GIS mapping which illustrates the location of sites in the area, and the tables and appendices which provide detailed information on the sites within the study area.

5.7 At the end of a rapid assessment of the data, the information from the site visit and historic map search, the appraisal dataset contained 140 records. As stated in 5.2, some HER records were discarded as they were for deleted records or duplicate records, whilst some new records were created as a result of the desktop work and field survey undertaken by Trysor, i.e.

5.7.1 The National Monuments Record was consulted and compared with the HER. Only one further site was added to the project database for the appraisal as it was of significance and not included in the HER. This was for the former Wesleyan Methodist Chapel in Jameston (ID number 139).

5.7.2 A new record was also created in the project database by Trysor for Landway Farm itself (ID number 140).

5.8 Each of the records in the appraisal dataset was assessed for Period, Rarity, Documentation, Group Value¹, as well as Evidential Value, Historical Value, Aesthetic Value, Communal Value². Once these had been considered the significance of each site was determined and scored in accordance with the categories adopted by the Welsh Archaeological Trusts i.e. Nationally Important, Regionally Important, Locally Important, Minor and Features Needing Further Investigation (Unknown). Full details of this exercise are given in Appendix C.

5.9 As this exercise is an appraisal of the study area, not a full desk-based archaeological assessment, no site descriptions have been included in the appraisal dataset or this printed report, apart from newly recorded features (See Appendix B).

¹ Period, Rarity, Documentation and Group Value are criteria defined in the Welsh Office Circular 60/96, 1996.

² Evidential Value, Historical Value, Aesthetic Value and Communal Value are criteria defined in Cadw's Conservation Principles publication, 2011.

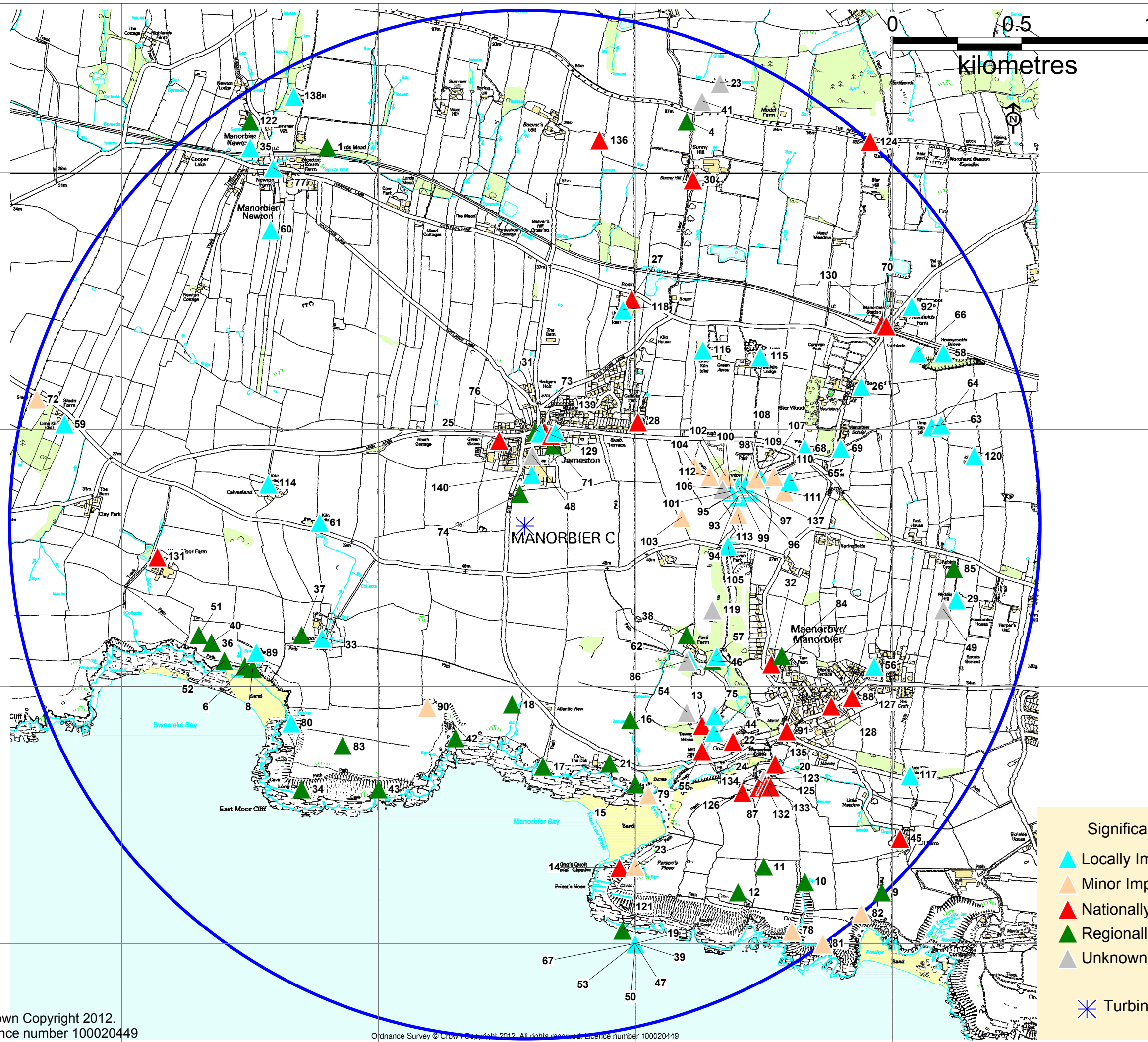

Figure 2: Sites showing significance, labelled with Project ID number

6. Landway Farm: Historical overview

6.1 Landway Farm appears to have its origins as a small farmstead in the first half of the 19th century, focused on Landway Cottage, which was close to, or at, the present farmhouse. The holding acquired more land and buildings during the 20th century and by the present day the building complex itself has undergone further modernisation and expansion, in keeping with the trends of modern farming. Apart from the farmhouse and its garden plot, little now remains of the earlier 20th century complex around the farmyard.

6.2 Historic Ordnance Survey and tithe maps show that the field pattern on the farmstead has changed considerably since the first half of the 19th century. The large field parcel in which the proposed turbine will stand is shown as a complex of smaller fields on the parish tithe map (see Figure 3). The field parcels shown on the tithe map are named as follows;

Owner: Ann Williams Occupier: Robert Phelp

533 Meadow
 535 Lower Landway
 536 Pool Park
 542 Big Landway
 24 House
 27 Garden

Owner & Occupier: William Greenish of Jameston village

538 Broad Meadow
 539 South Meadow
 540 Marybone Mead
 541 Marybone Mead

Owner: Mary Gwyther Occupier: John Evans

534 Unnamed

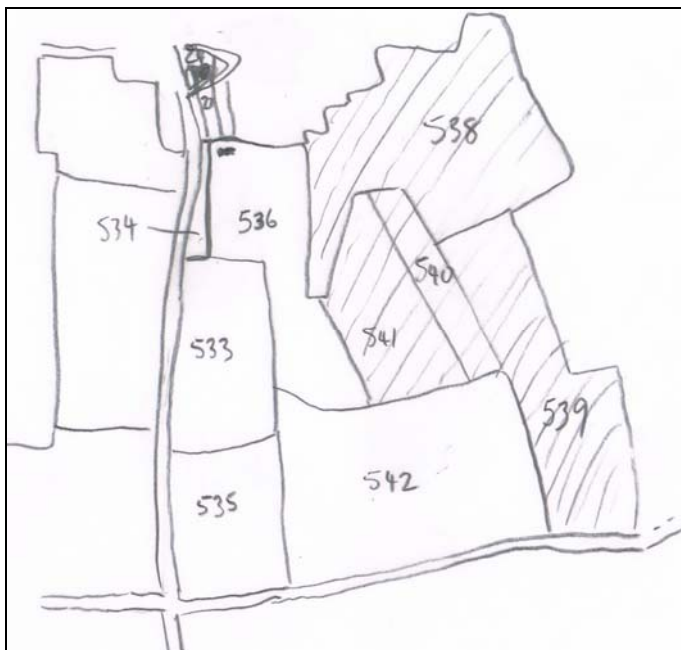

Figure 3: A rough sketch of the area around the proposed development site as shown on the parish tithe map. The numbered fields are now mostly incorporated into the field parcel where the turbine would be located, specifically in field number 533. Landway Cottage is shown at the northern end of field 536.

7. Landway Farm: Proposed turbine site

7.1 The proposed turbine at Landway Farm is to be located at SS0557098630 in a large arable field immediately to the south of the farmyard. The proposed cable trench will run northwards for c.200 metres from the turbine to a point near SS0559298818, near a large, modern shed on the farmyard. This shed houses a corn-drying kiln which will be powered by electricity generated by the turbine.

7.2 When the farm and its environs were visited in early February 2013, key monuments in the local landscape were visited to assess their intervisibility with the proposed turbine site. The key monuments visited were the medieval castle at Manorbier (ID number 22), the parish church at Manorbier (ID number 20), King's Quoit Chambered Tomb at Manorbier Bay (ID number 14) and the Bier Hill Round Barrow Cemetery on the Ridgeway (ID number 124).

7.3 Photographs were taken in both directions between the proposed turbine site and these monuments to inform this appraisal. Although it was a dark, overcast day, visibility was sufficiently good to make clear observations.



Plate 1: Looking northwest from the church (ID number 20), over the castle (ID number 22), towards Landway Farm. The hill of Park Farm, beyond the castle cuts off the view to the proposed development site.



Plate 2: View northwards from King's Quoit (ID number 14), towards Landway Farm. The high ground beyond Manorbier Bay blocks the view to the proposed development site.



Plate 3: The view north-eastwards from the proposed development site towards the Bier Hill round barrow cemetery (ID number 124), which is barely visible behind the trees in the centre of the photograph, 2km away.



Plate 4: The view south-eastwards from the proposed development site to Manorbier village. The castle (ID number 22) and church (ID number 20) cannot be seen. Only a few houses at the eastern end of the village are in view.

8. Impact Assessment

8.1 Within the revised area a total of 140 sites were recorded in the appraisal database.

8.2 The Direct and Indirect impact on each site was assessed taking into account both physical and non-physical impacts. A full table is found in Appendix A but a summary is tabulated in Table 1 below.

8.3 As Table 1 and Appendix A show, no recorded archaeological sites within the area of the appraisal were determined to be exposed to any significant impact from the proposed turbine development. (Details of the appraisal for direct and indirect impact for each of the sites in Table 1 can be found in Appendix A).

8.4 The cable trench will cut through a modern fence boundary line at the southern edge of the farmyard. Although this boundary is in itself not an historic feature, it may in part overlies or mimic a ploughed-out boundary bank shown on the parish tithe map, defining the northern boundary of field parcel 533 (see Figure 2). No surface evidence of the field boundary bank now survives, nor is its precise location known, but it must be assumed that the cable trench would cut through this feature. It is not however thought that mitigation is required in this instance as there is no evidence to suggest that the ploughed-out boundary is anything other than a post medieval feature. As the cable trench will be less than 50cm wide, a watching brief on this feature would be highly unlikely to throw any light on its origins and any disruption of the feature would be minimal. Recent archaeological excavations to the north of the farmyard (Ramsey, 2008) found evidence of ploughed-out field banks and boundaries which also appear on 19th century maps and were reduced in the 20th century. No pre-18th century dating evidence was found in these features and they appeared to be of post medieval date.

8.5 Fieldwalking across the proposed turbine site and along the line of the proposed cable trench was undertaken in February 2013, when the field was only thinly vegetated and the ground surface was rain-washed and clearly visible, produced no finds of significance. A small number of flint fragments were picked up but none were worked flints, or waste produced by flint-working, and they were not found in any concentration. An assortment of post medieval pottery sherds were also found, as would be expected in a field that has been under the plough for several centuries. Fragments of clay drainage pipes and red house-brick were also found, again probably indicative of waste material from the farmyard being spread on the field in modern times during manuring. None of the finds were of archaeological significance.

Table 1: Impact on sites within the appraisal area around Landway Farm proposed turbine site

Project ID	Name	Type	Impact Level
33	EAST MOOR	MOATED SITE,MOATED HOMESTEAD,DWELLING	Low
45	HILL FARM	FARMHOUSE	Low
75	MANORBIER	SETTLEMENT	Low
76	JAMESTON	SETTLEMENT	Low
93	NORTON FARM	FARMSTEAD	Low
94	NORTON FARM	FIELD SYSTEM	Low
100	NORTON FARM	WALLED GARDEN	Low
104	NORTON FARM	WELL	Low
106	NORTON FARM	RUBBING STONE; STANDING STONE?	Low
112	NORTON FARM	TRACKWAY	Low
124	BIER HILL MOUNDS	ROUND BARROW	Low
140	LANDWAY FARM	FARMSTEAD	Low
1	LORDS MEAD	FLINT WORKING SITE	None
2	PARK WALL DYKE	EARTHWORK	None
3	PARK WALL MOUND	UNKNOWN,EARTHWORK	None
4	SUNNY HILL	ROUND BARROW	None
5	SWANLAKE	FLINT WORKING SITE	None
6	SWANLAKE I	BURNT MOUND	None
7	SWANLAKE II	BURNT MOUND	None
8	SWANLAKE III	BURNT MOUND	None
9	HILL FARM	FLINT WORKING SITE	None
10	COOMB	FLINT WORKING SITE	None
11	HILL FARM	FLINT WORKING SITE	None
12	HILL FARM	FLINT WORKING SITE	None
13	OLD PIGEON HOUSE	DOVECOTE	None
14	KINGS QUOIT	CHAMBERED TOMB	None
15	DAK THE	BURNT MOUND	None
16	PARK FARM	FLINT WORKING SITE	None
17	MANORBIER BAY	FLINT WORKING SITE	None
18	MANORBIER BAY	FLINT WORKING SITE	None
19	MANORBIER BOUNDARY WALL;DEER PARK WALL	BOUNDARY WALL	None
20	MANORBIER PARISH CHURCH;ST JAMES';ST MARTIN'S?	CHURCH	None
21	DAK THE	FINDSPOT	None

Project ID	Name	Type	Impact Level
22	MANORBIER CASTLE;MAENOR PYR	CASTLE	None
23	MANORBIER	NATURAL FEATURE	None
24	CHURCH HILL COTTAGE	COTTAGE	None
25	GROVE THE;GROVE GREEN	DWELLING	None
26	BUTTYLAND	DWELLING	None
27	ROCK FARM	FARMHOUSE	None
28	TUDOR LODGE	DWELLING	None
29	MIDDLE HILL	DWELLING	None
30	SUNNYHILL	DWELLING	None
31	SWANLAKE INN	PUBLIC HOUSE,DWELLING	None
32	SEA VIEW COTTAGE; BLUE DOLPHINS	COTTAGE	None
34	SWANLAKE BAY;TRIG POINT	FLINT SCATTER	None
35	MANORBIER NEWTON	FINDSPOT	None
36	SWANLAKE	FINDSPOT	None
37	EAST MOOR	FINDSPOT	None
38	PARK FARM	FINDSPOT	None
39	HILLFARM	FINDSPOT	None
40	SWANLAKE	FINDSPOT	None
41	PARK WALL	ROUND BARROW	None
42	MANORBIER BAY	FLINT WORKING SITE	None
43	MANORBIER BAY	FLINT WORKING SITE	None
44	MANORBIER CASTLE	FISHPOND	None
46	PARK FARM	FLINT SCATTER	None
47	MANORBIER	GRANGE,CHANTRY CHAPEL	None
48	JAMESTON CHURCH	CHURCH,CHAPEL	None
49	MANORBIER MANSION	FORTIFIED HOUSE	None
50	PARSONS PIECE	CHURCH LAND	None
51	SWANLAKE BAY	FLINT WORKING SITE	None
52	SWANLAKE	FLINT SCATTER	None
53	MANORBIER	WATER MILL	None
54	MANORBIER CASTLE	EARTHWORK	None
55	MANORBIER MILL	MILL	None
56	MANORBIER	VICARAGE	None

Project ID	Name	Type	Impact Level
57	PARK FARM	LIME KILN	None
58		QUARRY	None
59	SLADE FARM	LIME KILN	None
60		LIME KILN	None
61		LIME KILN	None
62	PARK FARM	LIME KILN	None
63	MANORBIER	LIME KILN	None
64	MANORBIER	LIMESTONE QUARRY	None
65	KILN PARKS	LIME KILN	None
66	MANORBIER	LIME KILN	None
67	UNKNOWN	DWELLING	None
68	MANORBIER BAPTIST CHAPEL	CHAPEL	None
69	MANORBIER VC SCHOOL	SCHOOL	None
70	MANORBIER STATION	RAILWAY STATION	None
71	JAMESTON CHURCH	CHURCH	None
72	SLADE COTTAGE	COTTAGE	None
73	JAMESTON MEETING HOUSE	MEETING HOUSE	None
74	MANORBIER IRON MINE	MINING FEATURE	None
77	MANORBIER NEWTON	SETTLEMENT	None
78	COOMB	QUARRY	None
79	MANORBIER BAY	BOAT HOUSE	None
80	SWANLAKE BAY	BOUNDARY STONE	None
81		SHELTER	None
82	PRESIPE	QUARRY	None
83	EAST MOOR CLIFF	OBSERVATION POST	None
84	TARR FARM	WINDMILL	None
85	MIDDLE HILL	WINDMILL	None
86	PARK FARM	DEER PARK	None
87	MANORBIER	SCHOOL HOUSE	None
88	THE BIER HOUSE	BIER HOUSE	None
89	SWANLAKE	FARMSTEAD	None
90	UNKNOWN	RUBBING STONE	None
91	MANORBIER VILLAGE HALL	VILLAGE HALL	None
92	WHITEMOOR FARM	FARM	None
95	NORTON FARM	FARMHOUSE	None
96	NORTON FARM	FARM BUILDING	None

Project ID	Name	Type	Impact Level
97	NORTON FARM	STABLE	None
98	NORTON FARM	CART SHED	None
99	NORTON FARM	FARM BUILDING	None
101	NORTON FARM	TY BACH	None
102	NORTON FARM	ORCHARD	None
103	NORTON FARM	PLANTATION	None
105	NORTON FARM	POND	None
107	NORTON FARM	QUARRY	None
108	NORTON FARM	QUARRY	None
109	NORTON FARM	TRACKWAY	None
110	NORTON FARM	TRACKWAY	None
111	NORTON FARM	TRACKWAY	None
113	NORTON FARM	TRACKWAY	None
114	CALVESLAND FARM LIME KILN	LIME KILN	None
115	TYNEWYDD	LIME KILN	None
116	GREEN ACRES	LIME KILN	None
117	MUD LANE	LIME KILN	None
118	ROCK FARM	LIME KILN	None
119	PARK FARM	FINDSPOT	None
120	RED HOUSE KILN	LIME KILN	None
121	PARSON'S PIECE	FINDSPOT	None
122	MANORBIER NEWTON	FINDSPOT	None
123	MANORBIER PARISH CHURCH;ST JAMES';ST MARTIN'S?	CHURCHYARD	None
125	RUINS ADJACENT TO CHURCH HILL COTTAGE, RUIN A	RUINS	None
126	OLD VICARAGE	HOUSE	None
127	MANORBIER	CATTLE POUND	None
128	WARLOW'S COTTAGE	HOUSE	None
129	WESLEY HOUSE	HOUSE	None
130	FORMER RAILWAY STATIONMASTER'S HOUSE	HOUSE	None
131	WEST MOOR FARMHOUSE	HOUSE	None

Project ID	Name	Type	Impact Level
132	RUINS ADJACENT TO CHURCH HILL COTTAGE, RUIN B	BUILDING	None
133	RUINS ADJACENT TO CHURCH HILL COTTAGE, RUIN C	BUILDING	None
134	RUINS ADJACENT TO CHURCH HILL COTTAGE, RUIN D	RUINS	None
135	SHUTE COTTAGE	HOUSE	None
136	MANORBIER	FINDSPOT	None
137	NORTON FARM	LIMEKILN	None
138	FERN HILL	FARMSTEAD	None
139	JAMESTON WESLEYAN METHODIST CHAPEL	CHAPEL	None



Figure 4: Sites showing impact, labelled with Project ID number

9. Historic Landscape Aspects Relating to the Landway Farm Proposed Turbine

The following aspects of the historic environment around the Landway Farm proposed turbine site have also been considered by this appraisal, as required by the brief supplied by the Dyfed Archaeological Trust Heritage Management Section (DAT, HM, 2013);

a) Scheduled Ancient Monuments in their settings

Potential impacts on the four Scheduled Ancient Monuments within the appraisal area are included in Appendix A. In only one instance is there considered to be low, visual impact over distance, the remaining three Scheduled sites are not intervisible with the proposed development. The significance of Scheduled Ancient Monuments is addressed in Appendix C.

b) Non-scheduled Ancient Monuments in their settings

Potential impacts on Non-scheduled Ancient Monuments are included in Appendix A. The significance of Non-scheduled Ancient Monuments is addressed in Appendix C. There are no direct, physical impacts on any of these monuments and only in a small number of instances is a low, indirect, visual impact identified.

c) Listed Buildings in their settings

Only one of the 27 listed buildings within the appraisal area was thought to be likely to have any impact from the proposed development, namely Hill Farm farmhouse. This would however be a low, visual impact, over a distance of 1.9km, which would not affect the settings of the listed building.

d) Non-statutory buildings of local importance

No non-statutory buildings of local importance were identified as being of relevance to the proposed turbine site.

e) Registered Parks & Gardens and their essential settings.

There are no Registered Parks and Gardens within the overall study area.

f) Registered Historic Landscapes

The development site lies within the Manorbier Historic Landscape area, specifically within the East Moor & West Moor Characterisation Area. This puts it outside the historic settlement of Jameston village as well as a separate character area which covers the medieval strip field system to the north of Jameston. The field system of Landway farm appears to be of a markedly different character and post medieval in origin. The elongated field strips which are typical of the former open field system are absent here.

There will be a minimal visual impact on adjacent HLC areas (Manorbier Newton Strip Fields and Jameston) due to the relatively small scale of the turbine, the location of the turbine on a declining slope to the south of Jameston village, with the intervening farm buildings screening the view from much of the village.

g) Non-registered Historic Landscapes

There are no identified non-registered Historic Landscapes within the overall study area.

h) Conservation Area

A small portion of the eastern side of the village of Manorbier would be intervisible from the proposed turbine. The village falls within the Manorbier conservation area. The turbine would however be approximately 1.3km to the northwest and, due to its relatively small scale, would not affect the character or setting of the Conservation Area.

i) Buried archaeological potential

There is no identifiable buried archaeological potential at the proposed turbine site at Landway Farm, other than the possible ploughed-out field boundary mentioned in point 8.4 above. It must be assumed that this now lost field boundary would have comprised a bank and ditch of which some sub-surface evidence survives. The boundary is not thought to be a significant feature, however, and likely to be of later post-medieval date.

A specific concern raised in relation to this development was the possibility that Mesolithic or Neolithic flintworking floors are known locally and might potentially be affected by groundworks. However, analysis of the distribution of existing flintworking floors and other finds of prehistoric artefacts shows that there is a definite concentration along the coast edge and in the sheltered valley at Park Farm, Manorbier, where most Mesolithic flints have been found.

A number of flintworking sites are recorded in the HER at Hodgeston and Manorbier Newton. These are PRNs 3514-3518, with one site, PRN3517 (ID number 1 in the appraisal database) found within the appraisal area. These records are not accurately plotted and were based on a 1963 map by Geoff Wainwright in an article in the Proceedings of the Prehistoric Society (Wainwright, 1963, p.104). No information is known about the precise location of these findspots or what was found, therefore the significance of the records is unknown. Dyfed Archaeological Trust re-examined these records in 2004 (Page, 2004) and failed to establish any details about these finds.

During Trysor's visit to the farm in February 2013, an area approximately 100m square centred on the proposed turbine site was fieldwalked to establish whether there was any evidence of a flintworking site there. At the time the field was only thinly vegetated and the ground surface was rain-washed and clearly visible. This exercise produced no finds of significance. A small number of flint fragments were picked up, but none were worked flints, or waste material from flint working, and they were not found in any concentration.

j) Palaeoenvironmental potential

No palaeoenvironmental potential can be identified at the Landway Farm turbine site. It is situated in an arable field which has been regularly ploughed in modern times.

k) Hedgerows and field patterns

The proposed development would be located in a large, arable field, which is an amalgamation of several smaller fields, the boundaries of which have been removed in modern times. The only historic field boundary in close proximity to the development is a hedged bank along the western side of the field (bordering Cob Lane), which would not be affected by the development.

l) Ancient woodland

There are no recorded areas of Ancient and Semi-natural Woodland within the appraisal area.

m) Place-names

There are no significant place-names associated with the proposed development site. The field parcel names recorded on the parish tithe map have no archaeological significance.

n) Cumulative impact

No other turbines were visible from the proposed development site.

n) Newly identified sites of historic importance

The only newly recorded site of historic importance recorded for this appraisal was that of Landway farmstead. The details of this site are included in Appendices A & C.

10. Conclusion

10.1 There would not be a significant impact on the historic environment or on individual historic assets in relation to the proposed development of the proposed wind turbine at Landway Farm, Jameston. No sites have been found to be likely to be exposed to moderate or high impact, either in terms of direct physical or indirect visual impact. Those sites which would experience any impact at all would only be exposed to low, indirect visual impact, often over distances of a kilometre or more.

10.2 Fieldwalking the proposed development site produced no evidence to suggest that a flintworking floor is present. Added to this, the absence of any direct, physical impact on known historic assets, no archaeological mitigations are thought necessary for this development.

11. Reporting

11.1 Copies of this report will be provided to the client and the Regional Historic Environment Record.

12. References

12.1 Map sources

Ordnance Survey, 1866, 1:2500, 1st edition

Ordnance Survey, 1907, 1:2500 2nd edition

Ordnance Survey, 1967-8, 1:2500

Manorbier Township parish tithe map and schedule, 1842 & 1840

12.2 Web-based materials

English Heritage, 2011, *The Setting of Heritage Assets*

RCAHMW, Historic Wales Portal

Manorbier Historic Landscape, online description by Dyfed Archaeological Trust

www.dyfedarchaeology.co.uk

12.3 Published sources

Cadw, 2011, *Conservation Principles for the sustainable management of the historic environment of Wales*,

Cadw & CCW, 2007, *Guide to the Good Practice on using the Register of Landscapes of Historic Interest in Wales in the planning and development process.*

Page, N 2004 *Prehistoric Undefended Settlements Project, Southwest Wales: A Review of the Lithic Evidence from the Regional SMR* Report no.2004-53, ACA Reports

Wainwright, GJ, 1963, *A reinterpretation of the microlithic industries of Wales* 99-133, Proceedings of the Prehistoric Society 1963 Vol 29 p.104

Welsh Office, 1996, *Planning and the Historic Environment: Archaeology* Welsh Office Circular 60/96

12.4 Unpublished sources

Dyfed Archaeological Trust, Historic Environment Record

DAT HM, 2013, *Brief for the preparation of an historic environment appraisal for Landway Farm, Jameston*

Ramsey, R, 2008, *Land adjacent to Landway Farm, Jameston, Pembrokeshire, Archaeological Evaluation*

Jenny Hall & Paul Sambrook
Trydor,
February 2013

Appendix A: Landway Farm Impacts

ID number: 1
Is there a Direct Impact: No
Is there an Indirect Impact: No
Overall Impact: None The flints have been removed from their site, which is not intervisible with the proposed development.

=====

ID number: 2
Is there a Direct Impact: No
Is there an Indirect Impact: No
Overall Impact: None Not intervisible with the proposed development.

=====

ID number: 3
Is there a Direct Impact: No
Is there an Indirect Impact: No
Overall Impact: None Not intervisible with the proposed development.

=====

ID number: 4
Is there a Direct Impact: No
Is there an Indirect Impact: No
Overall Impact: None Not intervisible with the proposed development.

=====

ID number: 5
Is there a Direct Impact: No
Is there an Indirect Impact: No
Overall Impact: None These flints have been removed from their findspots, none of which are accurately recorded.

=====

ID number: 6
Is there a Direct Impact: No
Is there an Indirect Impact: No
Overall Impact: None Not intervisible with the proposed development.

=====

ID number: 7
Is there a Direct Impact: No
Is there an Indirect Impact: No
Overall Impact: None Not intervisible with the proposed development.

=====

ID number: 8
Is there a Direct Impact: No
Is there an Indirect Impact: No
Overall Impact: None Not intervisible with the proposed development.

=====
ID number: 9
Is there a Direct Impact: No
Is there an Indirect Impact: No
Overall Impact: None Not intervisible with proposed development.

=====
ID number: 10
Is there a Direct Impact: No
Is there an Indirect Impact: No
Overall Impact: None Not intervisible with proposed development.

=====
ID number: 11
Is there a Direct Impact: No
Is there an Indirect Impact: No
Overall Impact: None Not intervisible with proposed development.

=====
ID number: 12
Is there a Direct Impact: No
Is there an Indirect Impact: No
Overall Impact: None Not intervisible with proposed development.

=====
ID number: 13
Is there a Direct Impact: No
Is there an Indirect Impact: No
Overall Impact: None Not intervisible with proposed development.

=====
ID number: 14
Is there a Direct Impact: No
Is there an Indirect Impact: No
Overall Impact: None Not intervisible with proposed development.

ID number: 15
Is there a Direct Impact: No
Is there an Indirect Impact: No
Overall Impact: None Not intervisible with proposed development.

=====

ID number: 16
Is there a Direct Impact: No
Is there an Indirect Impact: No
Overall Impact: None Not intervisible with proposed development.

=====

ID number: 17
Is there a Direct Impact: No
Is there an Indirect Impact: No
Overall Impact: None Not intervisible with proposed development.

=====

ID number: 18
Is there a Direct Impact: No
Is there an Indirect Impact: No
Overall Impact: None Not intervisible with proposed development.

=====

ID number: 19
Is there a Direct Impact: No
Is there an Indirect Impact: No
Overall Impact: None Fenton is not precise in his description of the wall and it is not certain that there was a deer park here. The area suggested is not thought intervisible with the proposed development.

=====

ID number: 20
Is there a Direct Impact: No
Is there an Indirect Impact: No
Overall Impact: None Not intervisible with proposed development.

=====

ID number: 21
Is there a Direct Impact: No
Is there an Indirect Impact: No
Overall Impact: None Not intervisible with proposed development.

=====

ID number: 22
Is there a Direct Impact: No
Is there an Indirect Impact: No
Overall Impact: None Not intervisible with proposed development.

=====
ID number: 23
Is there a Direct Impact: No
Is there an Indirect Impact: No
Overall Impact: None Not intervisible with proposed development.

=====
ID number: 24
Is there a Direct Impact: No
Is there an Indirect Impact: No
Overall Impact: None Not intervisible with proposed development.

=====
ID number: 25
Is there a Direct Impact: No
Is there an Indirect Impact: No
Overall Impact: None Shielded from any view of the proposed development by modern houses between the two sites.

=====
ID number: 26
Is there a Direct Impact: No
Is there an Indirect Impact: No
Overall Impact: None Not intervisible with proposed development.

=====
ID number: 27
Is there a Direct Impact: No
Is there an Indirect Impact: No
Overall Impact: None Not intervisible with proposed development site.

=====
ID number: 28
Is there a Direct Impact: No
Is there an Indirect Impact: No
Overall Impact: None Not intervisible with proposed development as its view is blocked by trees between the two sites.

ID number: 29
Is there a Direct Impact: No
Is there an Indirect Impact: No
Overall Impact: None Not intervisible with proposed development site.

=====

ID number: 30
Is there a Direct Impact: No
Is there an Indirect Impact: No
Overall Impact: None Not intervisible with proposed development.

=====

ID number: 31
Is there a Direct Impact: No
Is there an Indirect Impact: No
Overall Impact: None The pub is shielded from the proposed development by other buildings in the village and is not intervisible with it.

=====

ID number: 32
Is there a Direct Impact: No
Is there an Indirect Impact: No
Overall Impact: None Not intervisible with proposed development

=====

ID number: 33
Is there a Direct Impact: No
Is there an Indirect Impact: Yes Possible long range view of wind turbine 1km to the northeast.
Overall Impact: Low Although the turbine blades may just be visible from the farmyard area, the scale of the turbine and distance involved means the development would not affect the setting of the modern farm complex.

=====

ID number: 34
Is there a Direct Impact: No
Is there an Indirect Impact: No
Overall Impact: None These flints have been removed from their findspots, none of which are accurately recorded.

=====

ID number: 35
Is there a Direct Impact: No
Is there an Indirect Impact: No
Overall Impact: None
The pottery has been removed from its site, which is not intervisible with the proposed development.

=====
ID number: 36
Is there a Direct Impact: No
Is there an Indirect Impact: No
Overall Impact: None
The arrowhead has been removed from its findspot, which was not accurately recorded.

=====
ID number: 37
Is there a Direct Impact: No
Is there an Indirect Impact: No
Overall Impact: None
These flints have been removed from their findspots, none of which are accurately recorded.

=====
ID number: 38
Is there a Direct Impact: No
Is there an Indirect Impact: No
Overall Impact: None
Findspot not intervisible with proposed development.

=====
ID number: 39
Is there a Direct Impact: No
Is there an Indirect Impact: No
Overall Impact: None
Findspot not intervisible with proposed development.

=====
ID number: 40
Is there a Direct Impact: No
Is there an Indirect Impact: No
Overall Impact: None
The arrowhead has been removed from its findspot, which was not accurately recorded.

=====
ID number: 41
Is there a Direct Impact: No
Is there an Indirect Impact: No
Overall Impact: None
Not intervisible with proposed development

ID number: 42
Is there a Direct Impact: No
Is there an Indirect Impact: No
Overall Impact: None Findspot is not intervisible with proposed development.

=====

ID number: 43
Is there a Direct Impact: No
Is there an Indirect Impact: No
Overall Impact: None These flints have been removed from their findspots, none of which are accurately recorded.

=====

ID number: 44
Is there a Direct Impact: No
Is there an Indirect Impact: No
Overall Impact: None Not intervisible with proposed development

=====

ID number: 45
Is there a Direct Impact: No
Is there an Indirect Impact: Yes
Overall Impact: Low Intervisible with proposed turbine site but over a distance of 1.9km, therefore the development does not affect its setting.

=====

ID number: 46
Is there a Direct Impact: No
Is there an Indirect Impact: No
Overall Impact: None Findspot is not intervisible with proposed development.

=====

ID number: 47
Is there a Direct Impact: No
Is there an Indirect Impact: No
Overall Impact: None It is not certain what this record refers to or the precise site of any buildings included in the record. No impact assessment can be made.

=====

ID number: 48
Is there a Direct Impact: No
Is there an Indirect Impact: No
Overall Impact: None

Saxtons map of Pembrokeshire in 1578 shows Jameston as apparently having a church. It is not known where in the village such a church stood or if it was associated with the site of the present church.

=====
ID number: 49
Is there a Direct Impact: No
Is there an Indirect Impact: No
Overall Impact: None

It seems unlikely that such a fortified dwelling ever existed and that a misinterpretation of historic texts has given rise to the records. No impact can be assessed.

=====
ID number: 50
Is there a Direct Impact: No
Is there an Indirect Impact: No
Overall Impact: None

Not intervisible with proposed development

=====
ID number: 51
Is there a Direct Impact: No
Is there an Indirect Impact: No
Overall Impact: None

These flints have been removed from their findspots, none of which are accurately recorded.

=====
ID number: 52
Is there a Direct Impact: No
Is there an Indirect Impact: No
Overall Impact: None

These flints have been removed from their findspots, none of which are accurately recorded.

=====
ID number: 53
Is there a Direct Impact: No
Is there an Indirect Impact: No
Overall Impact: None

Not intervisible with proposed development

=====

ID number: 54
Is there a Direct Impact: No
Is there an Indirect Impact: No
Overall Impact: None Not intervisible with proposed development.

=====

ID number: 55
Is there a Direct Impact: No
Is there an Indirect Impact: No
Overall Impact: None Not intervisible with proposed development.

=====

ID number: 56
Is there a Direct Impact: No
Is there an Indirect Impact: No
Overall Impact: None Not intervisible with proposed development.

=====

ID number: 57
Is there a Direct Impact: No
Is there an Indirect Impact: No
Overall Impact: None Not intervisible with proposed development.

=====

ID number: 58
Is there a Direct Impact: No
Is there an Indirect Impact: No
Overall Impact: None Not intervisible with proposed development.

=====

ID number: 59
Is there a Direct Impact: No
Is there an Indirect Impact: No
Overall Impact: None Not intervisible with the proposed development.

=====

ID number: 60
Is there a Direct Impact: No
Is there an Indirect Impact: No
Overall Impact: None Not intervisible with the proposed development.

=====

ID number: 61
Is there a Direct Impact: No
Is there an Indirect Impact: No
Overall Impact: None Not intervisible with proposed development as the sheds of Calvesland farm lie between the two sites.

=====
ID number: 62
Is there a Direct Impact: No
Is there an Indirect Impact: No
Overall Impact: None Not intervisible with the proposed development.

=====
ID number: 63
Is there a Direct Impact: No
Is there an Indirect Impact: No
Overall Impact: None The kiln no longer survives and the site is not intervisible with the proposed development.

=====
ID number: 64
Is there a Direct Impact: No
Is there an Indirect Impact: No
Overall Impact: None Not intervisible with the proposed development.

=====
ID number: 65
Is there a Direct Impact: No
Is there an Indirect Impact: No
Overall Impact: None Not intervisible with proposed development.

=====
ID number: 66
Is there a Direct Impact: No
Is there an Indirect Impact: No
Overall Impact: None Now destroyed but the site is not intervisible with the proposed development.

=====
ID number: 67
Is there a Direct Impact: No
Is there an Indirect Impact: No
Overall Impact: None Not intervisible with proposed development.

ID number: 68
Is there a Direct Impact: No
Is there an Indirect Impact: No
Overall Impact: None Not intervisible with proposed development.

=====

ID number: 69
Is there a Direct Impact: No
Is there an Indirect Impact: No
Overall Impact: None Not intervisible with proposed development.

=====

ID number: 70
Is there a Direct Impact: No
Is there an Indirect Impact: No
Overall Impact: None Not intervisible with proposed development.

=====

ID number: 71
Is there a Direct Impact: No
Is there an Indirect Impact: No
Overall Impact: None The church is sheltered from the proposed development by the outbuildings of Landway Farm and is therefore not intervisible with it.

=====

ID number: 72
Is there a Direct Impact: No
Is there an Indirect Impact: No
Overall Impact: None Not intervisible with the proposed development.

=====

ID number: 73
Is there a Direct Impact: No
Is there an Indirect Impact: No
Overall Impact: None The location of the Quaker Meeting House at Jameston, which was closed in the early 1800s has never been established. No evidence of its location survives.

=====

ID number: 74
Is there a Direct Impact: No
Is there an Indirect Impact: No
Overall Impact: None This mine working was infilled in the 20th century and is no longer visible. It will not be directly affected by the development.

=====

ID number: 75
Is there a Direct Impact: No
Is there an Indirect Impact: Yes
Overall Impact: Low
Part of the eastern side of the village will be intervisible with the proposed turbine, but at a distance of 1.3km which will not affect the setting of the settlement.

=====
ID number: 76
Is there a Direct Impact: No
Is there an Indirect Impact: No
Overall Impact: Low
Most of the village will be sheltered from the proposed turbine, which will only be 15m in height and to the south of the modern farm buildings of Landway Farm.

=====
ID number: 77
Is there a Direct Impact: No
Is there an Indirect Impact: No
Overall Impact: None
Not intervisible with the proposed development.

=====
ID number: 78
Is there a Direct Impact: No
Is there an Indirect Impact: No
Overall Impact: None
Not intervisible with proposed development.

=====
ID number: 79
Is there a Direct Impact: No
Is there an Indirect Impact: No
Overall Impact: None
Not intervisible with proposed development.

=====
ID number: 80
Is there a Direct Impact: No
Is there an Indirect Impact: No
Overall Impact: None
Not intervisible with proposed development.

=====
ID number: 81
Is there a Direct Impact: No
Is there an Indirect Impact: No
Overall Impact: None
Not intervisible with proposed development.

ID number: 82
Is there a Direct Impact: No
Is there an Indirect Impact: No
Overall Impact: None Not intervisible with proposed development.

=====

ID number: 83
Is there a Direct Impact: No
Is there an Indirect Impact: No
Overall Impact: None Not intervisible with proposed development.

=====

ID number: 84
Is there a Direct Impact: No
Is there an Indirect Impact: No
Overall Impact: None Not intervisible with proposed development.

=====

ID number: 85
Is there a Direct Impact: No
Is there an Indirect Impact: No
Overall Impact: None Not intervisible with proposed development.

=====

ID number: 86
Is there a Direct Impact: No
Is there an Indirect Impact: No
Overall Impact: None Not intervisible with development site.

=====

ID number: 87
Is there a Direct Impact: No
Is there an Indirect Impact: No
Overall Impact: None Not intervisible with development site.

=====

ID number: 88
Is there a Direct Impact: No
Is there an Indirect Impact: No
Overall Impact: None Not intervisible with development site.

=====

ID number: 89
Is there a Direct Impact: No
Is there an Indirect Impact: No
Overall Impact: None Not intervisible with development site.

=====
ID number: 90
Is there a Direct Impact: No
Is there an Indirect Impact: No
Overall Impact: None Not intervisible with proposed development.

=====
ID number: 91
Is there a Direct Impact: No
Is there an Indirect Impact: No
Overall Impact: None Not intervisible with proposed development.

=====
ID number: 92
Is there a Direct Impact: No
Is there an Indirect Impact: No
Overall Impact: None Not intervisible with proposed development.

=====
ID number: 93
Is there a Direct Impact: No
Is there an Indirect Impact: Yes The proposed development would be visible from parts of the farmstead.
Overall Impact: Low The western part of the farmstead will be intervisible with the proposed turbine but at a range of 600m or more, which will not affect the setting of the complex.

=====
ID number: 94
Is there a Direct Impact: No
Is there an Indirect Impact: Yes Intervisible with the proposed development.
Overall Impact: Low Intervisible with the proposed development but there would be no affect on the setting of the field system due to scale and distance (over 600m).

=====
ID number: 95
Is there a Direct Impact: No
Is there an Indirect Impact: No
Overall Impact: None Not intervisible with proposed development

ID number: 96
Is there a Direct Impact: No
Is there an Indirect Impact: No
Overall Impact: None Not intervisible with proposed development.

=====

ID number: 97
Is there a Direct Impact: No
Is there an Indirect Impact: No
Overall Impact: None Not intervisible with proposed development.

=====

ID number: 98
Is there a Direct Impact: No
Is there an Indirect Impact: No
Overall Impact: None Not intervisible with proposed development.

=====

ID number: 99
Is there a Direct Impact: No
Is there an Indirect Impact: No
Overall Impact: None Not intervisible with proposed development.

=====

ID number: 100
Is there a Direct Impact: No
Is there an Indirect Impact: Yes Possible long distance view of turbine through trees.
Overall Impact: Low Although a long distance view westwards to the turbine is possible, the setting of the garden is not affected by the proposed development.

=====

ID number: 101
Is there a Direct Impact: No
Is there an Indirect Impact: No
Overall Impact: None Shielded from the proposed development by its location within a walled garden.

=====

ID number: 102
Is there a Direct Impact: No
Is there an Indirect Impact: No
Overall Impact: None The orchard no longer survives and the site is shielded from the proposed development by trees along its western boundary.

=====

ID number: 103
Is there a Direct Impact: No
Is there an Indirect Impact: No
Overall Impact: None Not intervisible with the proposed development.

=====

ID number: 104
Is there a Direct Impact: No
Is there an Indirect Impact: Yes Intervisible with proposed development.
Overall Impact: Low Although intervisible with the development, it is 700m away and divided from it by a field boundary which may block part of the view. Its setting is not affected.

=====

ID number: 105
Is there a Direct Impact: No
Is there an Indirect Impact: No
Overall Impact: None Not intervisible with proposed development.

=====

ID number: 106
Is there a Direct Impact: No
Is there an Indirect Impact: Yes Possibly intervisible with the proposed development.
Overall Impact: Low Possible long range views of the proposed turbine over 780m away. The setting of the stone would not be affected however.

=====

ID number: 107
Is there a Direct Impact: No
Is there an Indirect Impact: No
Overall Impact: None Not intervisible with proposed development.

=====

ID number: 108
Is there a Direct Impact: No
Is there an Indirect Impact: No
Overall Impact: None Not intervisible with proposed development.

=====

ID number: 109
Is there a Direct Impact: No
Is there an Indirect Impact: No
Overall Impact: None Not intervisible with proposed development.

=====

ID number: 110
Is there a Direct Impact: No
Is there an Indirect Impact: No
Overall Impact: None Not intervisible with proposed development.

=====

ID number: 111
Is there a Direct Impact: No
Is there an Indirect Impact: No
Overall Impact: None Not intervisible with proposed development.

=====

ID number: 112
Is there a Direct Impact: No
Is there an Indirect Impact: Yes Intervisible with proposed development.
Overall Impact: Low Although intervisible with the development, it is 700m away and divided from it by a field boundary which may block part of the view. Its setting is not affected.

=====

ID number: 113
Is there a Direct Impact: No
Is there an Indirect Impact: No Intervisible with proposed development.
Overall Impact: None Not intervisible with the proposed development

=====

ID number: 114
Is there a Direct Impact: No
Is there an Indirect Impact: No
Overall Impact: None Not intervisible with proposed development as the sheds of Calvesland farm lie between the two sites.

=====

ID number: 115
Is there a Direct Impact: No
Is there an Indirect Impact: No
Overall Impact: None Not intervisible with proposed development.

=====

ID number: 116
Is there a Direct Impact: No
Is there an Indirect Impact: No
Overall Impact: None Not intervisible with proposed development.

=====

ID number: 117
Is there a Direct Impact: No
Is there an Indirect Impact: No
Overall Impact: None Not intervisible with proposed development.

=====

ID number: 118
Is there a Direct Impact: No
Is there an Indirect Impact: No
Overall Impact: None Not intervisible with proposed development.

=====

ID number: 119
Is there a Direct Impact: No
Is there an Indirect Impact: No
Overall Impact: None The findspot is not intervisible with the proposed development and the coins have been removed from the site.

=====

ID number: 120
Is there a Direct Impact: No
Is there an Indirect Impact: No
Overall Impact: None Not intervisible with proposed development.

=====

ID number: 121
Is there a Direct Impact: No
Is there an Indirect Impact: No
Overall Impact: None Not intervisible with proposed development.

=====

ID number: 122
Is there a Direct Impact: No
Is there an Indirect Impact: No
Overall Impact: None The find has been removed from its site and the site of discovery is not intervisible with the proposed development.

=====

ID number: 123
Is there a Direct Impact: No
Is there an Indirect Impact: No
Overall Impact: None Not intervisible with proposed development.

=====

ID number: 124
Is there a Direct Impact: No
Is there an Indirect Impact: Yes Possible long range, partial view, over 2km distance.
Overall Impact: Low It is possible that the turbine blades will be visible beyond Jameston village and adjacent trees, but this would not affect the setting of the monument or the barrow cemetery it belongs to.

=====
ID number: 125
Is there a Direct Impact: No
Is there an Indirect Impact: No
Overall Impact: None Not intervisible with proposed development.

=====
ID number: 126
Is there a Direct Impact: No
Is there an Indirect Impact: No
Overall Impact: None Not intervisible with proposed development.

=====
ID number: 127
Is there a Direct Impact: No
Is there an Indirect Impact: No
Overall Impact: None Not intervisible with proposed development.

=====
ID number: 128
Is there a Direct Impact: No
Is there an Indirect Impact: No
Overall Impact: None Not intervisible with proposed development.

=====
ID number: 129
Is there a Direct Impact: No
Is there an Indirect Impact: No
Overall Impact: None Shielded from any view of the proposed development by other buildings in the village and therefore not intervisible with it.

=====
ID number: 130
Is there a Direct Impact: No
Is there an Indirect Impact: No
Overall Impact: None Not intervisible with proposed development.

=====

ID number: 131
Is there a Direct Impact: No
Is there an Indirect Impact: No
Overall Impact: None Does not appear to be intervisible with the proposed development, which lies almost 1.4km away.

=====
ID number: 132
Is there a Direct Impact: No
Is there an Indirect Impact: No
Overall Impact: None Not intervisible with proposed development.

=====
ID number: 133
Is there a Direct Impact: No
Is there an Indirect Impact: No
Overall Impact: None Not intervisible with proposed development.

=====
ID number: 134
Is there a Direct Impact: No
Is there an Indirect Impact: No
Overall Impact: None Not intervisible with proposed development.

=====
ID number: 135
Is there a Direct Impact: No
Is there an Indirect Impact: No
Overall Impact: None Not intervisible with proposed development.

=====
ID number: 136
Is there a Direct Impact: No
Is there an Indirect Impact: No
Overall Impact: None The bronze artefacts were removed from their site, which is not intervisible with the proposed development.

=====
ID number: 137
Is there a Direct Impact: No
Is there an Indirect Impact: No
Overall Impact: None Not intervisible with proposed development.

ID number: 138
Is there a Direct Impact: No
Is there an Indirect Impact: No
Overall Impact: None Not intervisible with proposed development and nearly 2km away.

=====

ID number: 139
Is there a Direct Impact: No
Is there an Indirect Impact: No
Overall Impact: None Not intervisible with proposed development.

=====

ID number: 140
Is there a Direct Impact: Yes The cable trench will run through the farmyard but will not impact on any buildings.
Is there an Indirect Impact: Yes The turbine will be intervisible with the farm buildings and farm house, but the complex is largely modern.
Overall Impact: Low The farmstead is largely modern

=====

**Appendix B:
Written Descriptions Of Newly
Recorded Archaeological Sites**

Landway Farm, Jameston, Pembrokeshire, Archaeological Appraisal

ID number: 140 LANDWAY FARM FARMSTEAD
HER PRN: NMR NPRN: 0
NGR: SS0559798827 Grid reference taken at centre of site
Broadclass: Agriculture and Subsistence
Period: Post Medieval;Modern
Form: Building **Condition:** Intact
Site Status: **SAM number:** **LB number:** **grade:**

Description:

Landway Farm appears to have been in existence by the mid-19th century. The closest approximation to the present farm is shown on the Manorbier parish tithe map of 1840. This shows an unnamed property, which was at that time owned by Ann Williams and occupied by a tenant, Robert Phelp. The owner appears to have lived in Jameston village, whilst a cottage occupied by the tenant stood close to, or on the site of, the present farmhouse. In 1841 the holding was no more than half-a-dozen fields arranged either side of Cob Lane. Although the cottage and farm are not named on the map or by the accompanying schedule, the Landway name was used in the names of two field parcels, Lower Landway and Big Landway.

The 1841 Census for Manorbier parish records that Robert Philp (sic) lived at Landway Cottage, with his wife Ann and Female Servant named Ann Brace. Later census returns show that Robert Phelps was a Cornishman, whilst his wife originally came from Carew, Pembrokeshire. The couple were still farming here in 1861, when the property was noted as being 22.5 acres in extent.

On the 1866, First Edition 1:2500 Ordnance Survey map a dwelling named Landway is shown on the site of the present farmhouse. It is possible that this building lies slightly to the west of the original cottage shown on the tithe map, and it is therefore possible, but not certain, that the present farmhouse dates to the period 1850-1860. It is equally possible that the tithe map gives an inaccurate representation of the site of the dwelling and that the present house incorporates or stands on the same site as the earlier cottage.

During the next four decades Landway appears to have continued as a small farmstead, occupied by a series of farming families. In 187, a John Angel of St Mary, Pembroke and his wife Ann Angel farmed 24 acres at Landway. By 1881, a stone mason named Charles Gwyther, aged 87 and his wife Martha, farmed 25 acres here and had one female servant. The size of the holding is not noted in the 1891 census and the head of the household was not present on census day. His wife, Hester Lewis was recorded as being home that day, with her two daughters Anne and Blanche. In 1901, William Davies of Narberth, with his wife Helena, daughter Frances were at Landway, with an Irish boarder. The last available census is that of 1911, when a local man, David Brown, lived here with his wife, two sons and a lodger.

Little is known of Landway Farm during the first half of the 20th century, but during the 1960s it is clear that it was becoming a more substantial holding. A range of outbuildings had appeared by this time, to the southwest and southeast of the farmhouse. Most of these buildings have now disappeared, replaced by much more substantial range of sheds and outbuildings to the east of the farmyard during more recent times, mirroring the enlargement of the holding since the mid-20th century.

Appendix C:

**Site Appraisals
Within Study Area**

Landway Farm, Jameston, Pembrokeshire, Archaeological Appraisal

ID number: 1 LORDS MEAD FLINT WORKING SITE
HER PRN: 3517 **NMR NPRN:**
NGR: SN048001 Grid reference taken at centre of site
Period: Neolithic;Mesolithic **Broadclass:** Industrial
Form: Finds **Condition:**
Site Status: Pembrok **SAM number:** **LB number:** **grade:**
Rarity: Common locally
Reference: Pembrokeshire HER
Documentation:
Group Value: One of a group in the wider area
Evidential Value: Artefacts
Historical Value: Not known
Aesthetic Value: None
Communal Value: None
Significance: Regionally Important

ID number: 2 PARK WALL DYKE EARTHWORK
HER PRN: 3525 **NMR NPRN:**
NGR: SN06330035 Grid reference taken at centre of site
Period: Unknown **Broadclass:** Unassigned
Form: Earthwork **Condition:** Near Intact
Site Status: **SAM number:** **LB number:** **grade:**
Rarity: Not known
Reference: RCAHMW, 1925, Pembrokeshire Inventory, No.1037, p.369.
Documentation:
Group Value: Not known
Evidential Value: Upstanding earthwork
Historical Value: Described in RCAHMW's Pembrokeshire Inventory
Aesthetic Value: None
Communal Value: None
Significance: Unknown

Landway Farm, Jameston, Pembrokeshire, Archaeological Appraisal

ID number: 3 PARK WALL MOUND UNKNOWN,EARTHWO
K

HER PRN: 3526 **NMR NPRN:**

NGR: SN06330035 Grid reference taken at centre of site

Period: Unknown **Broadclass:** Unassigned;Monument <By Form>

Form: Earthwork **Condition:** Not Known

Site Status: **SAM number:** **LB number:** **grade:**

Rarity: Not known

Reference: RCAHMW, 1925, Pembrokeshire Inventory, No.1037, p.369.

Documentation:

Group Value: Not known

Evidential Value: Upstanding earthwork

Historical Value: Described in RCAHMW's Pembrokeshire Inventory

Aesthetic Value: None

Communal Value: None

Significance: Unknown

ID number: 4 SUNNY HILL ROUND BARROW

HER PRN: 3527 **NMR NPRN:**

NGR: SN062002 Grid reference taken at centre of site

Period: Bronze Age **Broadclass:** Religious Ritual and Funerary

Form: Earthwork **Condition:** Destroyed

Site Status: Pembrok **SAM number:** **LB number:** **grade:**

Rarity: Not known

Reference: Pembrokeshire HER

Documentation:

Group Value: Possibly one of several Bronze Age barrows along the Ridgeway

Evidential Value: Surface features destroyed in 20th century

Historical Value: None

Aesthetic Value: None

Communal Value: None

Significance: Regionally Important

Landway Farm, Jameston, Pembrokeshire, Archaeological Appraisal

ID number: 5 SWANLAKE FLINT WORKING SITE
HER PRN: 4189 **NMR NPRN:**
NGR: SS04359817 Grid reference taken at centre of site
Period: Neolithic;Mesolithic;Bronze **Broadclass:** Industrial
Form: Finds **Condition:**
Site Status: Pembrok **SAM number:** **LB number:** **grade:**
Rarity: Common locally
Reference:
Documentation:
Group Value: One of a number of scatters of prehistoric flint artefacts found along this part of the Pembrokeshire coastline
Evidential Value: Artefacts
Historical Value: Discussed in many sources in the past century or so
Aesthetic Value: None
Communal Value: Some of the finds are kept at Tenby Museum & Pitt Rivers Museum, Oxford
Significance: Regionally Important

ID number: 6 SWANLAKE I BURNT MOUND
HER PRN: 4190 **NMR NPRN:**
NGR: SS04489808 Unknown
Period: Prehistoric **Broadclass:** Domestic;Monument <By Form>
Form: Earthwork **Condition:** Damaged
Site Status: Pembrok **SAM number:** **LB number:** **grade:**
Rarity: Not common
Reference: Pembrokeshire HER
Documentation:
Group Value: One of three burnt mounds recorded in close proximity. Bronze Age finds and barrows are also known locally
Evidential Value: Not found in 1996
Historical Value: None
Aesthetic Value: None
Communal Value: None
Significance: Regionally Important

Landway Farm, Jameston, Pembrokeshire, Archaeological Appraisal

ID number: 7 SWANLAKE II BURNT MOUND

HER PRN: 4191 **NMR NPRN:**

NGR: SS04519807 Unknown

Period: Prehistoric **Broadclass:** Domestic;Monument <By Form>

Form: Earthwork **Condition:** Damaged

Site Status: Pembrok **SAM number:** **LB number:** **grade:**

Rarity: Not common

Reference: Pembrokeshire HER

Documentation:

Group Value: One of three burnt mounds recorded in close proximity. Bronze Age finds and barrows are also known locally

Evidential Value: Not found in 1996

Historical Value: None

Aesthetic Value: None

Communal Value: None

Significance: Regionally Important

ID number: 8 SWANLAKE III BURNT MOUND

HER PRN: 4192 **NMR NPRN:**

NGR: SS04519807 Unknown

Period: Prehistoric **Broadclass:** Domestic;Monument <By Form>

Form: Earthwork **Condition:** Damaged

Site Status: Pembrok **SAM number:** **LB number:** **grade:**

Rarity: Not common

Reference: Pembrokeshire HER

Documentation:

Group Value: One of three burnt mounds recorded in close proximity. Bronze Age finds and barrows are also known locally

Evidential Value: Not found in 1996

Historical Value: None

Aesthetic Value: None

Communal Value: None

Significance: Regionally Important

Landway Farm, Jameston, Pembrokeshire, Archaeological Appraisal

ID number: 9 HILL FARM FLINT WORKING SITE
HER PRN: 4206 **NMR NPRN:**
NGR: SS06969720 Unknown
Period: Neolithic;Mesolithic **Broadclass:** Industrial
Form: Finds **Condition:**
Site Status: Pembrok **SAM number:** **LB number:** **grade:**
Rarity: Common locally
Reference: Pembrokeshire HER
Documentation:
Group Value: One of a number of flintworking sites along this part of the coastline
Evidential Value: Unknown
Historical Value: None
Aesthetic Value: None
Communal Value: None
Significance: Regionally Important

ID number: 10 COOMB FLINT WORKING SITE
HER PRN: 4207 **NMR NPRN:**
NGR: SS06669724 Unknown
Period: Neolithic;Mesolithic **Broadclass:** Industrial
Form: Finds **Condition:**
Site Status: Pembrok **SAM number:** **LB number:** **grade:**
Rarity: Common locally
Reference: Pembrokeshire HER
Documentation:
Group Value: One of a number of flintworking sites along this part of the coastline
Evidential Value: Artefacts
Historical Value: None
Aesthetic Value: None
Communal Value: None
Significance: Regionally Important

Landway Farm, Jameston, Pembrokeshire, Archaeological Appraisal

ID number: 11 HILL FARM FLINT WORKING SITE
HER PRN: 4208 **NMR NPRN:**
NGR: SS065973 Unknown
Period: Neolithic;Mesolithic **Broadclass:** Industrial
Form: Finds **Condition:**
Site Status: Pembrok **SAM number:** **LB number:** **grade:**
Rarity: Common locally
Reference: Pembrokeshire HER
Documentation:
Group Value: One of a number of flintworking sites along this part of the coastline
Evidential Value: Artefacts
Historical Value: None
Aesthetic Value: None
Communal Value: None
Significance: Regionally Important

ID number: 12 HILL FARM FLINT WORKING SITE
HER PRN: 4209 **NMR NPRN:**
NGR: SS064972 Unknown
Period: Neolithic;Mesolithic **Broadclass:** Industrial
Form: Finds **Condition:**
Site Status: Pembrok **SAM number:** **LB number:** **grade:**
Rarity: Common locally
Reference: Pembrokeshire HER
Documentation:
Group Value: One of a number of flintworking sites along this part of the coastline
Evidential Value: Artefacts
Historical Value: None
Aesthetic Value: None
Communal Value: None
Significance: Regionally Important

Landway Farm, Jameston, Pembrokeshire, Archaeological Appraisal

ID number: 13 OLD PIGEON HOUSE DOVECOTE
HER PRN: 4212 **NMR NPRN:**
NGR: SS06269785 Grid reference taken at centre of site
Period: Medieval **Broadclass:** Agriculture and Subsistence
Form: Other structure **Condition:** Near Intact
Site Status: scheduled **SAM number:** PE459 **LB number:** 5977 **grade:** II*
Rarity: Not rare
Reference: Pembrokeshire HER
Documentation:
Group Value: Part of medieval historic settlement of Manorbier
Evidential Value: Standing building
Historical Value: Described by Cadw for listing purposes
Aesthetic Value: No known
Communal Value: None
Significance: Nationally Important

ID number: 14 KINGS QUOIT CHAMBERED TOMB
HER PRN: 4213 **NMR NPRN:**
NGR: SS0593897297 Grid reference taken at centre of site
Period: Neolithic **Broadclass:** Religious Ritual and Funerary
Form: Other structure **Condition:** Near Intact
Site Status: scheduled **SAM number:** PE035 **LB number:** **grade:**
Rarity: Rare
Reference:
Documentation:
Group Value: None
Evidential Value: Standing structure
Historical Value: Well known monument
Aesthetic Value: Well known monument
Communal Value: None
Significance: Nationally Important

Landway Farm, Jameston, Pembrokeshire, Archaeological Appraisal

ID number: 15 DAK THE BURNT MOUND
HER PRN: 4214 **NMR NPRN:**
NGR: SS06009762 Unknown
Period: Prehistoric **Broadclass:** Domestic;Monument <By Form>
Form: Earthwork **Condition:** Not Known
Site Status: Pembrok **SAM number:** **LB number:** **grade:**
Rarity: Not common
Reference: Pembrokeshire HER
Documentation:
Group Value: None
Evidential Value: Documents only
Historical Value: None
Aesthetic Value: None
Communal Value: None
Significance: Regionally Important

ID number: 16 PARK FARM FLINT WORKING SITE
HER PRN: 4215 **NMR NPRN:**
NGR: SS05989787 Unknown
Period: Neolithic;Mesolithic **Broadclass:** Industrial
Form: Finds **Condition:**
Site Status: Pembrok **SAM number:** **LB number:** **grade:**
Rarity: Common locally
Reference: Pembrokeshire HER
Documentation:
Group Value: One of a number of flintworking sites along this part of the coastline
Evidential Value: Artefacts
Historical Value: None
Aesthetic Value: None
Communal Value: None
Significance: Regionally Important

Landway Farm, Jameston, Pembrokeshire, Archaeological Appraisal

ID number: 17 MANORBIER BAY FLINT WORKING SITE
HER PRN: 4216 **NMR NPRN:**
NGR: SS05649769 Unknown
Period: Mesolithic **Broadclass:** Industrial
Form: Finds **Condition:**
Site Status: Pembrok **SAM number:** **LB number:** **grade:**
Rarity: Common locally
Reference: Pembrokeshire HER
Documentation:
Group Value: One of a number of flintworking sites along this part of the coastline
Evidential Value: Artefacts
Historical Value: None
Aesthetic Value: None
Communal Value: None
Significance: Regionally Important

ID number: 18 MANORBIER BAY FLINT WORKING SITE
HER PRN: 4217 **NMR NPRN:**
NGR: SS05529793 Unknown
Period: Neolithic;Mesolithic **Broadclass:** Industrial
Form: Finds **Condition:**
Site Status: Pembrok **SAM number:** **LB number:** **grade:**
Rarity: Common locally
Reference: Pembrokeshire HER
Documentation:
Group Value: One of a number of flintworking sites along this part of the coastline
Evidential Value: Artefacts
Historical Value: None
Aesthetic Value: None
Communal Value: None
Significance: Regionally Important

Landway Farm, Jameston, Pembrokeshire, Archaeological Appraisal

ID number: 19 MANORBIER BOUNDARY BOUNDARY WALL
WALL;DEER PARK WALL

HER PRN: 4218 **NMR NPRN:**

NGR: SS0697 Unknown

Period: Medieval **Broadclass:** Monument <By Form>

Form: Other structure **Condition:** Damaged

Site Status: Pembrok **SAM number:** **LB number:** **grade:**

Rarity: Rare

Reference: Pembrokeshire HER

Documentation:

Group Value: Part of medieval landscape associated with castle

Evidential Value: Documents only

Historical Value: Mentioned in passing by Richard Fenton in 1811

Aesthetic Value: None

Communal Value: None

Significance: Unknown

ID number: 20 MANORBIER PARISH CHURCH
CHURCH;ST JAMES';ST
MARTIN'S?

HER PRN: 4219 **NMR NPRN:**

NGR: SS06509764 Grid reference taken at centre of site

Period: Post Medieval;Medieval **Broadclass:** Religious Ritual and Funerary

Form: Building **Condition:** Intact

Site Status: Pembrok **SAM number:** **LB number:** 5975 **grade:** I

Rarity: Not rare

Reference: Pembrokeshire HER

Documentation:

Group Value: Part of historic settlement of Manobier

Evidential Value: Standing building

Historical Value: Described by Cadw for listing purposes and by Fenton in 1811

Aesthetic Value: Not known

Communal Value: Place of worship

Significance: Nationally Important

Landway Farm, Jameston, Pembrokeshire, Archaeological Appraisal

ID number: 21 DAK THE FINDSPOT
HER PRN: 4220 **NMR NPRN:**
NGR: SS059977 Unknown
Period: Bronze Age **Broadclass:** Object
Form: Finds **Condition:**
Site Status: Pembrok **SAM number:** **LB number:** **grade:**
Rarity: Rare locally
Reference: Pembrokeshire HER
Documentation:
Group Value: Unknown
Evidential Value: Artefact
Historical Value: None
Aesthetic Value: None
Communal Value: None
Significance: Regionally Important

ID number: 22 MANORBIER CASTLE;MAENOR CASTLE
PYR
HER PRN: 4221 **NMR NPRN:**
NGR: SS06389779 Grid reference taken at centre of site
Period: Post Medieval;Medieval **Broadclass:** Monument <By Form>;Defence
Form: Building **Condition:** Near Intact
Site Status: schedule **SAM number:** PE004 **LB number:** 5976 **grade:** I
Rarity: Not rare
Reference: Pembrokeshire HER
Documentation:
Group Value: None
Evidential Value: Standing structure
Historical Value: Described by Giraldus Cambrensis in the late 12th century and much discussed since
Aesthetic Value: Not known
Communal Value: Public access
Significance: Nationally Important

Landway Farm, Jameston, Pembrokeshire, Archaeological Appraisal

ID number: 23 MANORBIER NATURAL FEATURE
HER PRN: 5014 **NMR NPRN:**
NGR: SS060973 Grid reference taken at centre of site
Period: General **Broadclass:** Unassigned
Form: Landform **Condition:**
Site Status: Pembrok **SAM number:** **LB number:** **grade:**
Rarity: Common
Reference: Pembrokeshire HER
Documentation:
Group Value: None
Evidential Value: Natural rock formation
Historical Value: None
Aesthetic Value: None
Communal Value: None
Significance: Minor Importance

ID number: 24 CHURCH HILL COTTAGE COTTAGE
HER PRN: 7277 **NMR NPRN:**
NGR: SS06509762 Grid reference taken at centre of site
Period: Post Medieval **Broadclass:** Domestic
Form: Building **Condition:** Restored
Site Status: Pembrok **SAM number:** **LB number:** 5979 **grade:** II
Rarity: Common
Reference: Pembrokeshire HER
Documentation:
Group Value: Part of an otherwise ruined building range near parish church
Evidential Value: Standing building in use
Historical Value: Described by Cadw for listing purposes and Fenton in 1811
Aesthetic Value: None
Communal Value: None
Significance: Nationally Important

Landway Farm, Jameston, Pembrokeshire, Archaeological Appraisal

ID number: 25 GROVE THE;GROVE GREEN DWELLING
HER PRN: 7278 **NMR NPRN:**
NGR: SS0546898961 Grid reference taken at centre of site
Period: Post Medieval **Broadclass:** Domestic
Form: Building **Condition:** Restored
Site Status: Pembrok **SAM number:** **LB number:** 5974 **grade:** II
Rarity: Common
Reference: Pembrokeshire HER
Documentation:
Group Value: Part of the historic village of Jameston
Evidential Value: Standing building
Historical Value: Described by Cadw for listing purposes
Aesthetic Value: None
Communal Value: None
Significance: Nationally Important

ID number: 26 BUTTYLAND DWELLING
HER PRN: 7279 **NMR NPRN:**
NGR: SS06889917 Grid reference taken at centre of site
Period: Post Medieval **Broadclass:** Domestic
Form: Building **Condition:** Intact
Site Status: Pembrok **SAM number:** **LB number:** **grade:**
Rarity: Common
Reference:
Documentation:
Group Value: Part of historic settlement pattern
Evidential Value: Standing building
Historical Value: None
Aesthetic Value: None
Communal Value: None
Significance: Locally Important

Landway Farm, Jameston, Pembrokeshire, Archaeological Appraisal

ID number: 27 ROCK FARM FARMHOUSE
HER PRN: 7280 **NMR NPRN:**
NGR: SS0598699510 Grid reference taken at centre of site
Period: Post Medieval **Broadclass:** Domestic
Form: Building **Condition:** Intact
Site Status: Pembrok **SAM number:** **LB number:** 5983 **grade:** II
Rarity: Common
Reference: Pembrokeshire HER
Documentation:
Group Value: Part of historic settlement pattern
Evidential Value: Standing building
Historical Value: Described by Cadw for listing purposes
Aesthetic Value: None
Communal Value: None
Significance: Nationally Important

ID number: 28 TUDOR LODGE DWELLING
HER PRN: 7281 **NMR NPRN:**
NGR: SS0601099032
Period: Post Medieval **Broadclass:** Domestic
Form: Building **Condition:** Intact
Site Status: Pembrok **SAM number:** **LB number:** 5982 **grade:** II
Rarity: Not rare
Reference: Pembrokeshire HER
Documentation:
Group Value: Part of historic settlement pattern
Evidential Value: Standing building
Historical Value: Described by Cadw for listing purposes
Aesthetic Value: None
Communal Value: None
Significance: Nationally Important

Landway Farm, Jameston, Pembrokeshire, Archaeological Appraisal

ID number: 29 MIDDLE HILL DWELLING
HER PRN: 7282 **NMR NPRN:**
NGR: SS07259834 Grid reference taken at centre of site
Period: Post Medieval **Broadclass:** Domestic
Form: Building **Condition:** Intact
Site Status: Pembrok **SAM number:** **LB number:** **grade:**
Rarity: Common
Reference:
Documentation:
Group Value: Part of historic settlement pattern
Evidential Value: Standing building
Historical Value: None
Aesthetic Value: None
Communal Value: None
Significance: Locally Important

ID number: 30 SUNNYHILL DWELLING
HER PRN: 7284 **NMR NPRN:**
NGR: SS0622499974 Grid reference taken at centre of site
Period: Post Medieval **Broadclass:** Domestic
Form: Building **Condition:** Intact
Site Status: Pembrok **SAM number:** **LB number:** 5984 **grade:** II*
Rarity: Not rare
Reference: Pembrokeshire HER
Documentation:
Group Value: Part of historic settlement pattern
Evidential Value: Standing building
Historical Value: Described by Cadw for listing purposes
Aesthetic Value: None
Communal Value: None
Significance: Nationally Important

Landway Farm, Jameston, Pembrokeshire, Archaeological Appraisal

ID number: 31 SWANLAKE INN PUBLIC
HOUSE, DWELLING

HER PRN: 7285 **NMR NPRN:**

NGR: SS0564898993 Grid reference taken at centre of site

Period: Post Medieval **Broadclass:** Domestic

Form: Building **Condition:** Restored

Site Status: Pembrok **SAM number:** **LB number:** 5973 **grade:** II

Rarity: Not rare

Reference: Pembrokeshire HER

Documentation:

Group Value: Part of historic village

Evidential Value: Standing building

Historical Value: Described by Cadw for listing purposes

Aesthetic Value: None

Communal Value: Public house

Significance: Nationally Important

ID number: 32 SEA VIEW COTTAGE; BLUE COTTAGE
DOLPHINS

HER PRN: 7286 **NMR NPRN:**

NGR: SS06539809 Grid reference taken at centre of site

Period: Post Medieval **Broadclass:** Domestic

Form: Building **Condition:** Intact

Site Status: Pembrok **SAM number:** **LB number:** 5980 **grade:** II

Rarity: Common

Reference: Pembrokeshire HER

Documentation:

Group Value: Part of the historic village of Manorbier

Evidential Value: Standing building

Historical Value: Described by Cadw for listing purposes and associated with Virginia Woolf who used it as a summer residence in 1908

Aesthetic Value: None

Communal Value: None

Significance: Nationally Important

Landway Farm, Jameston, Pembrokeshire, Archaeological Appraisal

ID number: 33 EAST MOOR MOATED SITE,MOATE
HOMESTEAD,DWELLIN
G

HER PRN: 7287 **NMR NPRN:**

NGR: SS0478098190 Grid reference taken at centre of site

Period: Unknown;Medieval **Broadclass:** Domestic

Form: Building **Condition:** Damaged

Site Status: Pembrok **SAM number:** **LB number:** **grade:**

Rarity: Not rare

Reference: Pembrokeshire HER

Documentation:

Group Value: Part of historic settlement pattern

Evidential Value: Pre-19th century buildings, including the original homestead at the farmyard, no longer appear to stand

Historical Value: Discussed by Richard Fenton in 1811.

Aesthetic Value: None

Communal Value: None

Significance: Locally Important

ID number: 34 SWANLAKE BAY;TRIG POINT FLINT SCATTER

HER PRN: 7381 **NMR NPRN:**

NGR: SS047976 Unknown

Period: Mesolithic **Broadclass:** Industrial

Form: Finds **Condition:**

Site Status: Pembrok **SAM number:** **LB number:** **grade:**

Rarity: Common locally

Reference: Pembrokeshire HER

Documentation:

Group Value: One of a number of flintworking sites along this part of the coastline

Evidential Value: Artefacts

Historical Value: None

Aesthetic Value: None

Communal Value: Some of these flints are kept at Tenby Museum

Significance: Regionally Important

Landway Farm, Jameston, Pembrokeshire, Archaeological Appraisal

ID number: 35 MANORBIER NEWTON FINDSPOT
HER PRN: 7468 **NMR NPRN:**
NGR: SN045001
Period: Medieval **Broadclass:** Object
Form: Finds **Condition:**
Site Status: Pembrok **SAM number:** **LB number:** **grade:**
Rarity: Not rare
Reference: Pembrokeshire HER
Documentation:
Group Value: Not known
Evidential Value: Artefacts
Historical Value: None
Aesthetic Value: None
Communal Value: None
Significance: Locally Important

ID number: 36 SWANLAKE FINDSPOT
HER PRN: 7639 **NMR NPRN:**
NGR: SS04359817 Unknown
Period: Neolithic **Broadclass:** Object
Form: Finds **Condition:**
Site Status: Pembrok **SAM number:** **LB number:** **grade:**
Rarity: Rare locally
Reference:
Documentation:
Group Value: Not known
Evidential Value: Artefact
Historical Value: None
Aesthetic Value: None
Communal Value: Kept at the Pitt-Rivers Museum, Oxford
Significance: Regionally Important

Landway Farm, Jameston, Pembrokeshire, Archaeological Appraisal

ID number: 37 EAST MOOR FINDSPOT
HER PRN: 7750 **NMR NPRN:**
NGR: SS047982 Unknown
Period: Prehistoric **Broadclass:** Object
Form: Finds **Condition:**
Site Status: Pembrok **SAM number:** **LB number:** **grade:**
Rarity: Common locally
Reference: Pembrokeshire HER
Documentation:
Group Value: One of a number of flintworking sites along this part of the coastline
Evidential Value: Flint scattered across a wide area
Historical Value: Discussed in many sources over the past century or more
Aesthetic Value: None
Communal Value: Some local flints are kept in the Pitt-Rivers Museum, Oxford
Significance: Regionally Important

ID number: 38 PARK FARM FINDSPOT
HER PRN: 7751 **NMR NPRN:**
NGR: SS062982 Unknown
Period: Prehistoric **Broadclass:** Object
Form: Finds **Condition:**
Site Status: Pembrok **SAM number:** **LB number:** **grade:**
Rarity: Not rare locally
Reference: Pembrokeshire HER
Documentation:
Group Value: One of a number of flint assemblages found in area
Evidential Value: Artefacts
Historical Value: Discussed in many sources over the past century or more
Aesthetic Value: None
Communal Value: Kept in the Pitt-Rivers Museum, Oxford
Significance: Regionally Important

Landway Farm, Jameston, Pembrokeshire, Archaeological Appraisal

ID number: 39 HILLFARM FINDSPOT
HER PRN: 7752 **NMR NPRN:**
NGR: SS0697 Unknown
Period: Prehistoric **Broadclass:** Object
Form: Finds **Condition:**
Site Status: Pembrok **SAM number:** **LB number:** **grade:**
Rarity: Common locally
Reference: Pembrokeshire HER
Documentation:
Group Value: One of a number of flint assemblages found in area
Evidential Value: Artefacts
Historical Value: None
Aesthetic Value: None
Communal Value: None
Significance: Regionally Important

ID number: 40 SWANLAKE FINDSPOT
HER PRN: 7758 **NMR NPRN:**
NGR: SS04359817 Unknown
Period: Bronze Age **Broadclass:** Object
Form: Finds **Condition:**
Site Status: Pembrok **SAM number:** **LB number:** **grade:**
Rarity: Rare locally
Reference: Pembrokeshire HER
Documentation:
Group Value: Not known but Bronze Age barrows are present in the locality
Evidential Value: Artefact
Historical Value: None
Aesthetic Value: None
Communal Value: Kept at the Pitt-Rivers Museum, Oxford
Significance: Regionally Important

Landway Farm, Jameston, Pembrokeshire, Archaeological Appraisal

ID number: 41 PARK WALL ROUND BARROW
HER PRN: 7981 **NMR NPRN:**
NGR: SN06260028
Period: Bronze Age **Broadclass:** Religious Ritual and Funerary
Form: Documents **Condition:**
Site Status: **SAM number:** **LB number:** **grade:**
Rarity: Not known
Reference: Pembrokeshire HER
Documentation:
Group Value: Not known
Evidential Value: No earthwork found here in 2004
Historical Value: None
Aesthetic Value: None
Communal Value: None
Significance: Unknown

ID number: 42 MANORBIER BAY FLINT WORKING SITE
HER PRN: 8169 **NMR NPRN:**
NGR: SS053978 Grid reference taken at centre of site
Period: Neolithic;Mesolithic **Broadclass:** Industrial
Form: Finds **Condition:**
Site Status: Pembrok **SAM number:** **LB number:** **grade:**
Rarity: Common locally
Reference: Pembrokeshire HER
Documentation:
Group Value: One of a number of flint assemblages found in area
Evidential Value: Artefacts
Historical Value: None
Aesthetic Value: Unknown
Communal Value: None
Significance: Regionally Important

Landway Farm, Jameston, Pembrokeshire, Archaeological Appraisal

ID number: 43 MANORBIER BAY FLINT WORKING SITE
HER PRN: 8190 **NMR NPRN:**
NGR: SS050976 Unknown
Period: Neolithic;Mesolithic **Broadclass:** Industrial
Form: Finds **Condition:**
Site Status: Pembrok **SAM number:** **LB number:** **grade:**
Rarity: Common locally
Reference: Pembrokeshire HER
Documentation:
Group Value: One of a number of flint assemblages found in area
Evidential Value: Artefacts
Historical Value: None
Aesthetic Value: None
Communal Value: Kept at Tenby Museum and the Pitt-Rivers Museum, Oxford
Significance: Regionally Important

ID number: 44 MANORBIER CASTLE FISHPOND
HER PRN: 8233 **NMR NPRN:**
NGR: SS0630697823 Grid reference taken at centre of site
Period: Medieval **Broadclass:** Water Supply and Drainage;Agriculture a
Form: Documents **Condition:**
Site Status: Pembrok **SAM number:** **LB number:** **grade:**
Rarity: Not common
Reference: Pembrokeshire HER
Documentation:
Group Value: Part of medieval landscape associated with castle
Evidential Value: Documents
Historical Value: Mentioned by Giraldus Cambrensis in late 12th century
Aesthetic Value: None
Communal Value: None
Significance: Locally Important

Landway Farm, Jameston, Pembrokeshire, Archaeological Appraisal

ID number: 45 HILL FARM FARMHOUSE
HER PRN: 8758 **NMR NPRN:**
NGR: SS0703097410 Grid reference taken at centre of site
Period: Post Medieval **Broadclass:** Domestic
Form: Building **Condition:** Not Known
Site Status: Pembrok **SAM number:** **LB number:** 18017 **grade:** II
Rarity: Common
Reference: Pembrokeshire HER
Documentation:
Group Value: Part of historic settlement pattern
Evidential Value: Standing building
Historical Value: Described by Cadw for listing purposes
Aesthetic Value: None
Communal Value: None
Significance: Nationally Important

ID number: 46 PARK FARM FLINT SCATTER
HER PRN: 10010 **NMR NPRN:**
NGR: SS063981 Unknown
Period: Mesolithic **Broadclass:** Monument <By Form>
Form: Finds **Condition:**
Site Status: Pembrok **SAM number:** **LB number:** **grade:**
Rarity: Common locally
Reference: Pembrokeshire HER
Documentation:
Group Value: One of a number of flint assemblages found in area
Evidential Value: Artefacts
Historical Value: Discussed in many sources over the past century or more
Aesthetic Value: None
Communal Value: Kept at the Pitt-Rivers Museum, Oxford and Tenby Museum
Significance: Regionally Important

Landway Farm, Jameston, Pembrokeshire, Archaeological Appraisal

ID number: 47 MANORBIER GRANGE, CHANTRY
CHAPEL

HER PRN: 10533 **NMR NPRN:**

NGR: SS0697 Unknown

Period: Medieval **Broadclass:** Religious Ritual and Funerary

Form: Documents **Condition:**

Site Status: Pembrok **SAM number:** **LB number:** **grade:**

Rarity: Unknown

Reference: Pembrokeshire HER

Documentation:

Group Value: Unknown

Evidential Value: Documents only

Historical Value: Unknown

Aesthetic Value: None

Communal Value: None

Significance: Unknown

ID number: 48 JAMESTON CHURCH CHURCH, CHAPEL

HER PRN: 11452 **NMR NPRN:**

NGR: SS056989 Unknown

Period: Medieval; Post Medieval **Broadclass:** Religious Ritual and Funerary

Form: Documents **Condition:**

Site Status: Pembrok **SAM number:** **LB number:** **grade:**

Rarity: Not rare

Reference: Pembrokeshire HER

Documentation:

Group Value: None

Evidential Value: Early mapping only

Historical Value: None

Aesthetic Value: None

Communal Value: None

Significance: Unknown

Landway Farm, Jameston, Pembrokeshire, Archaeological Appraisal

ID number: 49 MANORBIER MANSION FORTIFIED HOUSE
HER PRN: 11837 **NMR NPRN:**
NGR: SS072983 Unknown
Period: Medieval **Broadclass:** Domestic
Form: Documents **Condition:**
Site Status: Pembrok **SAM number:** **LB number:** **grade:**
Rarity: Unknown
Reference: Pembrokeshire HER
Documentation:
Group Value: None
Evidential Value: Documents only
Historical Value: Fenton refers to the "mansion" of Manorbier but this refers to the castle, not another fortified site. This seems to be an erroneous record.
Aesthetic Value: None
Communal Value: None
Significance: Unknown

ID number: 50 PARSONS PIECE CHURCH LAND
HER PRN: 12165 **NMR NPRN:**
NGR: SS0697 Grid reference taken at centre of site
Period: Post Medieval;Medieval **Broadclass:** Unassigned
Form: Place-name **Condition:**
Site Status: Pembrok **SAM number:** **LB number:** **grade:**
Rarity: Not rare
Reference: Pembrokeshire HER
Documentation:
Group Value: None
Evidential Value: Placename evidence only
Historical Value: None
Aesthetic Value: None
Communal Value: None
Significance: Locally Important

Landway Farm, Jameston, Pembrokeshire, Archaeological Appraisal

ID number: 51 SWANLAKE BAY FLINT WORKING SITE
HER PRN: 12258 **NMR NPRN:**
NGR: SS043982 Grid reference taken at centre of site
Period: Mesolithic **Broadclass:** Industrial
Form: Finds **Condition:**
Site Status: Pembrok **SAM number:** **LB number:** **grade:**
Rarity: Common locally
Reference: Pembrokeshire HER
Documentation:
Group Value: One of a number of flintworking sites recorded along this part of the Pembrokeshire coastline
Evidential Value: Artefacts
Historical Value: Discussed by many sources in the past century or so
Aesthetic Value: None
Communal Value: None
Significance: Regionally Important

ID number: 52 SWANLAKE FLINT SCATTER
HER PRN: 12260 **NMR NPRN:**
NGR: SS044981 Unknown
Period: Mesolithic **Broadclass:** Monument <By Form>
Form: Finds **Condition:**
Site Status: Pembrok **SAM number:** **LB number:** **grade:**
Rarity: Common locally
Reference:
Documentation:
Group Value: One of a number of flintworking sites recorded along this part of the Pembrokeshire coastline
Evidential Value: Artefacts
Historical Value: Discussed by many sources in the past century or so
Aesthetic Value: None
Communal Value: Kept at Tenby Museum
Significance: Regionally Important

Landway Farm, Jameston, Pembrokeshire, Archaeological Appraisal

ID number: 53 MANORBIER WATER MILL
HER PRN: 12543 **NMR NPRN:**
NGR: SS0697 Unknown
Period: Medieval **Broadclass:** Industrial
Form: Documents **Condition:**
Site Status: Pembrok **SAM number:** **LB number:** **grade:**
Rarity: Not rare
Reference: Pembrokeshire HER
Documentation:
Group Value: Part of medieval settlement
Evidential Value: Documents only
Historical Value: Described by Giraldus Cambrensis in late 12th century
Aesthetic Value: None
Communal Value: None
Significance: Locally Important

ID number: 54 MANORBIER CASTLE EARTHWORK
HER PRN: 14829 **NMR NPRN:**
NGR: SS062979 Grid reference taken at centre of site
Period: Medieval **Broadclass:** Monument <By Form>
Form: Earthwork **Condition:** Not Known
Site Status: pcnp **SAM number:** **LB number:** **grade:**
Rarity: Unknown
Reference: Pembrokeshire HER
Documentation:
Group Value: None
Evidential Value: Aerial photographic evidence only
Historical Value: None
Aesthetic Value: None
Communal Value: None
Significance: Unknown

Landway Farm, Jameston, Pembrokeshire, Archaeological Appraisal

ID number: 55 MANORBIER MILL MILL
HER PRN: 15930 **NMR NPRN:**
NGR: SS06269775 Grid reference taken at centre of site
Period: Post Medieval **Broadclass:** Industrial
Form: Building **Condition:** Near Intact
Site Status: Pembrok **SAM number:** **LB number:** 18014 **grade:** II
Rarity: Not rare
Reference: Pembrokeshire HER
Documentation:
Group Value: Part of historic settlement pattern
Evidential Value: Standing but ruinous
Historical Value: None
Aesthetic Value: None
Communal Value: None
Significance: Nationally Important

ID number: 56 MANORBIER VICARAGE
HER PRN: 15931 **NMR NPRN:**
NGR: SS06939808 Grid reference taken at centre of site
Period: Post Medieval **Broadclass:** Domestic
Form: Building **Condition:** Not Known
Site Status: Pembrok **SAM number:** **LB number:** **grade:**
Rarity: Not rare
Reference: Pembrokeshire HER
Documentation:
Group Value: Part of historic village of Manorbier
Evidential Value: Standing building
Historical Value: None
Aesthetic Value: None
Communal Value: None
Significance: Locally Important

Landway Farm, Jameston, Pembrokeshire, Archaeological Appraisal

ID number: 57 PARK FARM LIME KILN
HER PRN: 15932 **NMR NPRN:**
NGR: SS0631698120 Grid reference taken at centre of site
Period: Post Medieval **Broadclass:** Industrial
Form: Other structure **Condition:** Not Known
Site Status: Pembrok **SAM number:** **LB number:** **grade:**
Rarity: Not rare
Reference: Pembrokeshire HER
Documentation:
Group Value: None
Evidential Value: Standing structure in 1997
Historical Value: None
Aesthetic Value: None
Communal Value: None
Significance: Locally Important

ID number: 58 QUARRY
HER PRN: 15933 **NMR NPRN:**
NGR: SS072993 Grid reference taken at centre of site
Period: Post Medieval **Broadclass:** Industrial
Form: Earthwork **Condition:** Not Known
Site Status: Pembrok **SAM number:** **LB number:** **grade:**
Rarity: Common
Reference:
Documentation:
Group Value: None
Evidential Value: Now infilled and built over or wooded
Historical Value: None
Aesthetic Value: None
Communal Value: None
Significance: Locally Important

Landway Farm, Jameston, Pembrokeshire, Archaeological Appraisal

ID number: 59 SLADE FARM LIME KILN
HER PRN: 15969 **NMR NPRN:**
NGR: SS0377799024 Grid reference taken at centre of site
Period: Post Medieval **Broadclass:** Industrial
Form: Other structure **Condition:** Not Known
Site Status: Pembrok **SAM number:** **LB number:** **grade:**
Rarity: Not rare
Reference: Pembrokeshire HER
Documentation:
Group Value: None
Evidential Value: Standing structure in 2001
Historical Value: None
Aesthetic Value: None
Communal Value: None
Significance: Locally Important

ID number: 60 LIME KILN
HER PRN: 15972 **NMR NPRN:**
NGR: SS04589978
Period: Post Medieval **Broadclass:** Industrial
Form: Other structure **Condition:** Not Known
Site Status: Pembrok **SAM number:** **LB number:** **grade:**
Rarity: Not rare
Reference: Pembrokeshire HER
Documentation:
Group Value: Not rare
Evidential Value: Not known. Possibly an inaccurate NGR.
Historical Value: None
Aesthetic Value: None
Communal Value: None
Significance: Locally Important

Landway Farm, Jameston, Pembrokeshire, Archaeological Appraisal

ID number: 61 LIME KILN
HER PRN: 15973 **NMR NPRN:**
NGR: SS0477198639
Period: Post Medieval **Broadclass:** Industrial
Form: Other structure **Condition:** Not Known
Site Status: Pembrok **SAM number:** **LB number:** **grade:**
Rarity: Not rare
Reference:
Documentation:
Group Value: None
Evidential Value: Standing structure
Historical Value: None
Aesthetic Value: None
Communal Value: None
Significance: Locally Important

ID number: 62 PARK FARM LIME KILN
HER PRN: 16506 **NMR NPRN:**
NGR: SS06219811 Grid reference taken at centre of site
Period: Post Medieval **Broadclass:** Industrial
Form: Documents **Condition:**
Site Status: pcnp **SAM number:** **LB number:** **grade:**
Rarity: Not rare
Reference: Pembrokeshire HER
Documentation:
Group Value: None
Evidential Value: Documents only
Historical Value: None
Aesthetic Value: None
Communal Value: None
Significance: Locally Important

Landway Farm, Jameston, Pembrokeshire, Archaeological Appraisal

ID number: 63 MANORBIER LIME KILN
HER PRN: 16540 **NMR NPRN:**
NGR: SS0715499012 Grid reference taken at centre of site
Period: Post Medieval **Broadclass:** Industrial
Form: Documents **Condition:** Destroyed
Site Status: pcnp **SAM number:** **LB number:** **grade:**
Rarity: Not rare
Reference: Pembrokeshire HER; Ordnance Survey, 1890, 1:2500 First Edition Map
Documentation:
Group Value: Associated with quarry to east PRN16852
Evidential Value: Only shown on historic maps
Historical Value: None
Aesthetic Value: None
Communal Value: None
Significance: Locally Important

ID number: 64 MANORBIER LIMESTONE QUARRY
HER PRN: 16852 **NMR NPRN:**
NGR: SS07199902 Grid reference taken at centre of site
Period: Post Medieval **Broadclass:** Industrial
Form: Documents **Condition:**
Site Status: pcnp **SAM number:** **LB number:** **grade:**
Rarity: Not rare
Reference: Pembrokeshire HER; Ordnance Survey, 1890, 1:2500 First Edition Map
Documentation:
Group Value: Associated with limekiln to the west, PRN16540
Evidential Value: Disused quarry still extant in landscape
Historical Value: None
Aesthetic Value: None
Communal Value: None
Significance: Locally Important

Landway Farm, Jameston, Pembrokeshire, Archaeological Appraisal

ID number: 65 KILN PARKS LIME KILN
HER PRN: 17340 **NMR NPRN:**
NGR: SS06609880 Grid reference taken at centre of site
Period: Post Medieval **Broadclass:** Industrial
Form: Documents **Condition:**
Site Status: pcnp **SAM number:** **LB number:** **grade:**
Rarity: Not rare
Reference: Pembrokeshire HER
Documentation:
Group Value: Associated with quarries and another nearby kiln
Evidential Value: Unknown
Historical Value: None
Aesthetic Value: None
Communal Value: None
Significance: Locally Important

ID number: 66 MANORBIER LIME KILN
HER PRN: 17452 **NMR NPRN:**
NGR: SS071993 Grid reference taken at centre of site
Period: Post Medieval **Broadclass:** Industrial
Form: Documents **Condition:** Destroyed
Site Status: pcnp **SAM number:** **LB number:** **grade:**
Rarity: Not rare
Reference:
Documentation:
Group Value: None
Evidential Value: Site destroyed
Historical Value: None
Aesthetic Value: None
Communal Value: None
Significance: Locally Important

Landway Farm, Jameston, Pembrokeshire, Archaeological Appraisal

ID number: 67 UNKNOWN DWELLING
HER PRN: 20010 **NMR NPRN:**
NGR: SS0697 Unknown
Period: Post Medieval **Broadclass:** Domestic
Form: Documents **Condition:**
Site Status: Pembrok **SAM number:** **LB number:** **grade:**
Rarity: Not rare
Reference: Pembrokeshire HER
Documentation:
Group Value: Unknown
Evidential Value: Unknown
Historical Value: Mentioned in Archaeologia Cambrensis, 1867
Aesthetic Value: None
Communal Value: None
Significance: Unknown

ID number: 68 MANORBIER BAPTIST CHAPEL CHAPEL
HER PRN: 20825 **NMR NPRN:**
NGR: SS06669893 Grid reference taken at centre of site
Period: Post Medieval **Broadclass:** Religious Ritual and Funerary
Form: Building **Condition:** Not Known
Site Status: Pembrok **SAM number:** **LB number:** **grade:**
Rarity: Common
Reference: Pembrokeshire HER
Documentation:
Group Value: Part of historic settlement
Evidential Value: Standing building
Historical Value: Not known
Aesthetic Value: None
Communal Value: Place of worship
Significance: Locally Important

Landway Farm, Jameston, Pembrokeshire, Archaeological Appraisal

ID number: 69 MANORBIER VC SCHOOL SCHOOL
HER PRN: 20826 **NMR NPRN:**
NGR: SS06809893 Grid reference taken at centre of site
Period: Post Medieval **Broadclass:** Education
Form: Building **Condition:** Not Known
Site Status: Pembrok **SAM number:** **LB number:** **grade:**
Rarity: Common
Reference: Pembrokeshire HER
Documentation:
Group Value: Part of historic settlement
Evidential Value: Standing building
Historical Value: Not known
Aesthetic Value: None
Communal Value: Village school
Significance: Locally Important

ID number: 70 MANORBIER STATION RAILWAY STATION
HER PRN: 20827 **NMR NPRN:**
NGR: SS0695999411 Grid reference taken at centre of site
Period: Post Medieval **Broadclass:** Unassigned
Form: Other structure **Condition:** Not Known
Site Status: Pembrok **SAM number:** **LB number:** 18021 **grade:** II
Rarity: Not rare
Reference: Pembrokeshire HER
Documentation:
Group Value: One of the station along the railway line
Evidential Value: Standing building, converted to a dwelling
Historical Value: Not known
Aesthetic Value: None
Communal Value: Former railway station
Significance: Nationally Important

Landway Farm, Jameston, Pembrokeshire, Archaeological Appraisal

ID number: 71 JAMESTON CHURCH CHURCH
HER PRN: 20993 **NMR NPRN:**
NGR: SS05689894 Grid reference taken at centre of site
Period: Post Medieval **Broadclass:** Religious Ritual and Funerary
Form: Building **Condition:** Not Known
Site Status: Pembrok **SAM number:** **LB number:** **grade:**
Rarity: Not rare
Reference: Pembrokeshire HER
Documentation:
Group Value: Part of historic village
Evidential Value: Standing building
Historical Value: Not known
Aesthetic Value: Not known
Communal Value: Place of worship
Significance: Regionally Important

ID number: 72 SLADE COTTAGE COTTAGE
HER PRN: 21680 **NMR NPRN:**
NGR: SS03679912 Grid reference taken at centre of site
Period: Post Medieval **Broadclass:** Domestic
Form: Building **Condition:** Near Intact
Site Status: Pembrok **SAM number:** **LB number:** **grade:**
Rarity: Common
Reference: Pembrokeshire HER
Documentation:
Group Value: None
Evidential Value: Possible ruined building
Historical Value: None
Aesthetic Value: None
Communal Value: None
Significance: Minor Importance

Landway Farm, Jameston, Pembrokeshire, Archaeological Appraisal

ID number: 73 JAMESTON MEETING HOUSE MEETING HOUSE
HER PRN: 24297 **NMR NPRN:**
NGR: SS05619899 Unknown
Period: Post Medieval **Broadclass:** Religious Ritual and Funerary
Form: Documents **Condition:**
Site Status: Pembrok **SAM number:** **LB number:** **grade:**
Rarity: Not common
Reference:
Documentation:
Group Value: None
Evidential Value: Documents only
Historical Value: Mentioned in histories of Pembrokeshire Quakerism
Aesthetic Value: None
Communal Value: None
Significance: Regionally Important

ID number: 74 MANORBIER IRON MINE MINING FEATURE
HER PRN: 25492 **NMR NPRN:**
NGR: SS0555098750 Grid reference taken at centre of site
Period: Post Medieval **Broadclass:** Industrial
Form: Earthwork **Condition:** Destroyed
Site Status: Pembrok **SAM number:** **LB number:** **grade:**
Rarity: Not rare
Reference: Pembrokeshire HER; Claughton, P, 1999, A List of Mines in Pembrokeshire (online); Ordnance Survey, 1907, 1:2500 Second Edition Map
Documentation:
Group Value: One in a series of workings known as the Manorbire Iron Mine worked in the 1860s.
Evidential Value: Documents only
Historical Value: None
Aesthetic Value: None
Communal Value: None
Significance: Regionally Important

Landway Farm, Jameston, Pembrokeshire, Archaeological Appraisal

ID number: 75 MANORBIER SETTLEMENT
HER PRN: 28037 **NMR NPRN:**
NGR: SS0663097890 Grid reference taken at centre of site
Period: Post Medieval **Broadclass:** Domestic
Form: Building **Condition:** Intact
Site Status: **SAM number:** **LB number:** **grade:**
Rarity: Not rare
Reference: Pembrokeshire HER
Documentation:
Group Value: A complex historic settlement
Evidential Value: Standing buildings
Historical Value: Described in numerous sources and associated with Giraldus Cambrensis
Aesthetic Value: Not known
Communal Value: Settlement
Significance: Locally Important

ID number: 76 JAMESTON SETTLEMENT
HER PRN: 28039 **NMR NPRN:**
NGR: SS0563098990 Grid reference taken at centre of site
Period: Post Medieval **Broadclass:** Domestic
Form: Building **Condition:** Intact
Site Status: pcnp **SAM number:** **LB number:** **grade:**
Rarity: Not rare
Reference: Pembrokeshire HER
Documentation:
Group Value: One of the historic villages of the district
Evidential Value: Standing buildings, street patterns, traces of medieval strip fields
Historical Value: Not known
Aesthetic Value: Not known
Communal Value: Has parish church and public house
Significance: Locally Important

Landway Farm, Jameston, Pembrokeshire, Archaeological Appraisal

ID number: 77 MANORBIER NEWTON SETTLEMENT
HER PRN: 28077 **NMR NPRN:**
NGR: SN04590002 Grid reference taken at centre of site
Period: Post Medieval;Medieval **Broadclass:** Domestic
Form: Building **Condition:** Intact
Site Status: pcnp **SAM number:** **LB number:** **grade:**
Rarity: Not rare
Reference: Pembrokeshire HER
Documentation:
Group Value: One of a series of small villages in the district
Evidential Value: Complex of houses and fields
Historical Value: Not known
Aesthetic Value: Not known
Communal Value: Village
Significance: Locally Important

ID number: 78 COOMB QUARRY
HER PRN: 32639 **NMR NPRN:**
NGR: SS06619705 Grid reference taken at centre of site
Period: Unknown **Broadclass:** Industrial
Form: Earthwork **Condition:** Damaged
Site Status: pcnp **SAM number:** **LB number:** **grade:**
Rarity: Common
Reference: Pembrokeshire HER
Documentation:
Group Value: None
Evidential Value: Small quarry pit
Historical Value: None
Aesthetic Value: None
Communal Value: None
Significance: Minor Importance

Landway Farm, Jameston, Pembrokeshire, Archaeological Appraisal

ID number: 79 MANORBIER BAY BOAT HOUSE
HER PRN: 32813 **NMR NPRN:**
NGR: SS06059758 Grid reference taken at centre of site
Period: Post Medieval **Broadclass:** Gardens Parks and Urban Spaces;Maritim
Form: Building **Condition:** Near Destroyed
Site Status: pcnp **SAM number:** **LB number:** **grade:**
Rarity: Not rare
Reference: Pembrokeshire HER
Documentation:
Group Value: None
Evidential Value: Fragmentary ruins
Historical Value: None
Aesthetic Value: None
Communal Value: None
Significance: Minor Importance

ID number: 80 SWANLAKE BAY BOUNDARY STONE
HER PRN: 32814 **NMR NPRN:**
NGR: SS04669786 Grid reference taken at centre of site
Period: Modern **Broadclass:** Monument <By Form>
Form: Other structure **Condition:** Intact
Site Status: pcnp **SAM number:** **LB number:** **grade:**
Rarity: Not common
Reference: Pembrokeshire HER
Documentation:
Group Value: One of several similar stones notes along the coastline
Evidential Value: Small, inscribed stone blocks
Historical Value: None
Aesthetic Value: None
Communal Value: None
Significance: Locally Important

Landway Farm, Jameston, Pembrokeshire, Archaeological Appraisal

ID number: 81 SHELTER
HER PRN: 32815 **NMR NPRN:**
NGR: SS06739700 Grid reference taken at centre of site
Period: Unknown **Broadclass:** Unassigned
Form: Earthwork **Condition:** Not Known
Site Status: pcnp **SAM number:** **LB number:** **grade:**
Rarity: Not common
Reference: Pembrokeshire HER
Documentation:
Group Value: None
Evidential Value: Extant in 1996
Historical Value: None
Aesthetic Value: None
Communal Value: None
Significance: Minor Importance

ID number: 82 PRESIPE QUARRY
HER PRN: 32817 **NMR NPRN:**
NGR: SS06889712 Grid reference taken at centre of site
Period: Unknown **Broadclass:** Industrial
Form: Earthwork **Condition:** Damaged
Site Status: pcnp **SAM number:** **LB number:** **grade:**
Rarity: Common
Reference: Pembrokeshire HER
Documentation:
Group Value: None
Evidential Value: Small quarry pit
Historical Value: None
Aesthetic Value: None
Communal Value: None
Significance: Minor Importance

Landway Farm, Jameston, Pembrokeshire, Archaeological Appraisal

ID number: 83 EAST MOOR CLIFF OBSERVATION POST
HER PRN: 33455 **NMR NPRN:**
NGR: SS04869777 Grid reference taken at centre of site
Period: Modern **Broadclass:** Defence
Form: Documents **Condition:** Destroyed
Site Status: pcnp **SAM number:** **LB number:** **grade:**
Rarity: Not common
Reference: Pembrokeshire HER
Documentation:
Group Value: Part of WW2 coastal defences
Evidential Value: Documents only
Historical Value: None
Aesthetic Value: None
Communal Value: None
Significance: Regionally Important

ID number: 84 TARR FARM WINDMILL
HER PRN: 33716 **NMR NPRN:**
NGR: SS06579812 Grid reference taken at centre of site
Period: Post Medieval **Broadclass:** Industrial;Monument <By Form>
Form: Documents **Condition:**
Site Status: pcnp **SAM number:** **LB number:** **grade:**
Rarity: Rare
Reference: Pembrokeshire HER
Documentation:
Group Value: None
Evidential Value: Slight ruins remain
Historical Value: None
Aesthetic Value: None
Communal Value: None
Significance: Regionally Important

Landway Farm, Jameston, Pembrokeshire, Archaeological Appraisal

ID number: 85 MIDDLE HILL WINDMILL
HER PRN: 33717 **NMR NPRN:**
NGR: SS07249846 Grid reference taken at centre of site
Period: Post Medieval **Broadclass:** Industrial;Monument <By Form>
Form: Documents **Condition:**
Site Status: pcnp **SAM number:** **LB number:** **grade:**
Rarity: Rare
Reference: Pembrokeshire HER
Documentation:
Group Value: None
Evidential Value: Surface traces seem to remain
Historical Value: None
Aesthetic Value: None
Communal Value: None
Significance: Regionally Important

ID number: 86 PARK FARM DEER PARK
HER PRN: 33718 **NMR NPRN:**
NGR: SS062981 Unknown
Period: Medieval **Broadclass:** Gardens Parks and Urban Spaces;Recreati
Form: Documents **Condition:**
Site Status: pcnp **SAM number:** **LB number:** **grade:**
Rarity: Rare
Reference: Pembrokeshire HER
Documentation:
Group Value: None
Evidential Value: Tenuous placename evidence only
Historical Value: None
Aesthetic Value: None
Communal Value: None
Significance: Unknown

Landway Farm, Jameston, Pembrokeshire, Archaeological Appraisal

ID number: 87 MANORBIER SCHOOL HOUSE
HER PRN: 33719 **NMR NPRN:**
NGR: SS0650797619 Grid reference taken at centre of site
Period: Post Medieval **Broadclass:** Education
Form: Building **Condition:** Converted
Site Status: pcnp **SAM number:** **LB number:** 5979 **grade:** II
Rarity: Not rare
Reference: Pembrokeshire HER
Documentation:
Group Value: Part of historic settlement of Manorbier
Evidential Value: Now converted into a cottage
Historical Value: Described by Cadw for listing purposes
Aesthetic Value: None
Communal Value: None
Significance: Nationally Important

ID number: 88 THE BIER HOUSE BIER HOUSE
HER PRN: 33720 **NMR NPRN:**
NGR: SS0684297962 Grid reference taken at centre of site
Period: Modern **Broadclass:** Religious Ritual and Funerary
Form: Building **Condition:** Restored
Site Status: pcnp,listc **SAM number:** **LB number:** 18012 **grade:** II
Rarity: Not common
Reference: Pembrokeshire HER
Documentation:
Group Value: The Bier House has been built into the parish pound
Evidential Value: Still standing
Historical Value: None
Aesthetic Value: None
Communal Value: Historically used for burials within the parish, now a public open space
Significance: Nationally Important

Landway Farm, Jameston, Pembrokeshire, Archaeological Appraisal

ID number: 89 SWANLAKE FARMSTEAD
HER PRN: 33766 **NMR NPRN:**
NGR: SS0452498135 Grid reference taken at centre of site
Period: Post Medieval **Broadclass:** Agriculture and Subsistence
Form: Building **Condition:** Damaged
Site Status: Pembrok **SAM number:** **LB number:** **grade:**
Rarity: Common
Reference: Pembrokeshire HER
Documentation:
Group Value: Part of historic settlement pattern
Evidential Value: Ruined building
Historical Value: None
Aesthetic Value: None
Communal Value: None
Significance: Locally Important

ID number: 90 UNKNOWN RUBBING STONE
HER PRN: 33767 **NMR NPRN:**
NGR: SS05199792 Grid reference taken at centre of site
Period: Unknown **Broadclass:** Unassigned
Form: Documents **Condition:** Near Destroyed
Site Status: Pembrok **SAM number:** **LB number:** **grade:**
Rarity: Common
Reference: Pembrokeshire HER
Documentation:
Group Value: None
Evidential Value: No stones survive
Historical Value: None
Aesthetic Value: None
Communal Value: None
Significance: Minor Importance

Landway Farm, Jameston, Pembrokeshire, Archaeological Appraisal

ID number: 91 MANORBIER VILLAGE HALL VILLAGE HALL
HER PRN: 38326 **NMR NPRN:**
NGR: SS0659097830 Grid reference taken at centre of site
Period: Post Medieval **Broadclass:** Civil
Form: Building **Condition:** Intact
Site Status: pcnp,list **SAM number:** **LB number:** 20277 **grade:** II
Rarity: Not rare
Reference: Pembrokeshire HER
Documentation:
Group Value: Part of historic village of Manorbier
Evidential Value: Standing building
Historical Value: Designed by London architect WAS Benson in 1908
Aesthetic Value: In the Arts and Crafts style
Communal Value: Community hall
Significance: Nationally Important

ID number: 92 WHITEMOOR FARM FARM
HER PRN: 39851 **NMR NPRN:**
NGR: SS0707699481 Grid reference taken at centre of site
Period: Post Medieval;Medieval **Broadclass:** Agriculture and Subsistence
Form: None **Condition:**
Site Status: pcnp **SAM number:** **LB number:** **grade:**
Rarity: Common
Reference: Pembrokeshire HER
Documentation:
Group Value: Part of historic settlement pattern
Evidential Value: Standing building complex
Historical Value: None
Aesthetic Value: None
Communal Value: None
Significance: Locally Important

Landway Farm, Jameston, Pembrokeshire, Archaeological Appraisal

ID number: 93 NORTON FARM FARMSTEAD
HER PRN: 42857 **NMR NPRN:**
NGR: SS06409874 Grid reference taken at centre of site
Period: Post Medieval **Broadclass:** Agriculture and Subsistence
Form: Documents **Condition:** Not Known
Site Status: pcnp **SAM number:** **LB number:** **grade:**
Rarity: Common
Reference: Pembrokeshire HER
Documentation:
Group Value: Part of historic landscape and settlement pattern
Evidential Value: Standing buildings and field system in use
Historical Value: None
Aesthetic Value: None
Communal Value: None
Significance: Locally Important

ID number: 94 NORTON FARM FIELD SYSTEM
HER PRN: 42858 **NMR NPRN:**
NGR: SS06409874 Grid reference taken at centre of site
Period: Post Medieval **Broadclass:** Agriculture and Subsistence
Form: Topog **Condition:** Intact
Site Status: pcnp **SAM number:** **LB number:** **grade:**
Rarity: Common
Reference: Pembrokeshire HER
Documentation:
Group Value: Part of farmstead complex
Evidential Value: Field parcels still in use
Historical Value: None
Aesthetic Value: None
Communal Value: None
Significance: Locally Important

Landway Farm, Jameston, Pembrokeshire, Archaeological Appraisal

ID number: 95 NORTON FARM FARMHOUSE
HER PRN: 42859 **NMR NPRN:**
NGR: SS06409876 Grid reference taken at centre of site
Period: Post Medieval **Broadclass:** Agriculture and Subsistence
Form: Building **Condition:** Intact
Site Status: pcnp **SAM number:** **LB number:** **grade:**
Rarity: Common
Reference: Pembrokeshire HER
Documentation:
Group Value: Part of farmstead complex
Evidential Value: Standing building
Historical Value: None
Aesthetic Value: None
Communal Value: None
Significance: Locally Important

ID number: 96 NORTON FARM FARM BUILDING
HER PRN: 42860 **NMR NPRN:**
NGR: SS06429877 Grid reference taken at centre of site
Period: Post Medieval **Broadclass:** Agriculture and Subsistence
Form: Building **Condition:** Intact
Site Status: pcnp **SAM number:** **LB number:** **grade:**
Rarity: Common
Reference: Pembrokeshire HER
Documentation:
Group Value: Part of farmstead complex
Evidential Value: Standing building
Historical Value: None
Aesthetic Value: None
Communal Value: None
Significance: Locally Important

Landway Farm, Jameston, Pembrokeshire, Archaeological Appraisal

ID number: 97 NORTON FARM STABLE
HER PRN: 42861 **NMR NPRN:**
NGR: SS06419878 Grid reference taken at centre of site
Period: Post Medieval **Broadclass:** Agriculture and Subsistence
Form: Building **Condition:** Near Intact
Site Status: pcnp **SAM number:** **LB number:** **grade:**
Rarity: Common
Reference: Pembrokeshire HER
Documentation:
Group Value: Part of farmstead complex
Evidential Value: Standing building
Historical Value: None
Aesthetic Value: None
Communal Value: None
Significance: Locally Important

ID number: 98 NORTON FARM CART SHED
HER PRN: 42862 **NMR NPRN:**
NGR: SS06419878 Grid reference taken at centre of site
Period: Post Medieval **Broadclass:** Agriculture and Subsistence
Form: Building **Condition:** Intact
Site Status: pcnp **SAM number:** **LB number:** **grade:**
Rarity: Not rare
Reference: Pembrokeshire HER
Documentation:
Group Value: Part of farmstead complex
Evidential Value: Standing building
Historical Value: None
Aesthetic Value: None
Communal Value: None
Significance: Locally Important

Landway Farm, Jameston, Pembrokeshire, Archaeological Appraisal

ID number: 99 NORTON FARM FARM BUILDING
HER PRN: 42863 **NMR NPRN:**
NGR: SS06409878 Grid reference taken at centre of site
Period: Post Medieval **Broadclass:** Agriculture and Subsistence
Form: Building **Condition:** Intact
Site Status: pcnp **SAM number:** **LB number:** **grade:**
Rarity: Common
Reference: Pembrokeshire HER
Documentation:
Group Value: Part of farmstead complex
Evidential Value: Standing building
Historical Value: None
Aesthetic Value: None
Communal Value: None
Significance: Locally Important

ID number: 100 NORTON FARM WALLED GARDEN
HER PRN: 42864 **NMR NPRN:**
NGR: SS06379877 Grid reference taken at centre of site
Period: Post Medieval **Broadclass:** Domestic
Form: Other structure **Condition:** Damaged
Site Status: pcnp **SAM number:** **LB number:** **grade:**
Rarity: Not common
Reference: Pembrokeshire HER
Documentation:
Group Value: Part of farmstead complex
Evidential Value: Surviving walls
Historical Value: None
Aesthetic Value: None
Communal Value: None
Significance: Locally Important

Landway Farm, Jameston, Pembrokeshire, Archaeological Appraisal

ID number: 101 NORTON FARM TY BACH
HER PRN: 42865 **NMR NPRN:**
NGR: SS06379876 Grid reference taken at centre of site
Period: Post Medieval **Broadclass:** Domestic
Form: Building **Condition:** Near Intact
Site Status: pcnp **SAM number:** **LB number:** **grade:**
Rarity: Not common
Reference: Pembrokeshire HER
Documentation:
Group Value: Part of farmstead complex
Evidential Value: Still standing but roofless in 2001
Historical Value: None
Aesthetic Value: None
Communal Value: None
Significance: Locally Important

ID number: 102 NORTON FARM ORCHARD
HER PRN: 42866 **NMR NPRN:**
NGR: SS06359882 Grid reference taken at centre of site
Period: Post Medieval **Broadclass:** Domestic
Form: Topog **Condition:** Intact
Site Status: pcnp **SAM number:** **LB number:** **grade:**
Rarity: Not common
Reference: Pembrokeshire HER
Documentation:
Group Value: Part of farmstead complex
Evidential Value: Trees no longer survive, just the parcel boundaries
Historical Value: None
Aesthetic Value: None
Communal Value: None
Significance: Minor Importance

Landway Farm, Jameston, Pembrokeshire, Archaeological Appraisal

ID number: 103 NORTON FARM PLANTATION
HER PRN: 42867 **NMR NPRN:**
NGR: SS06189866 Grid reference taken at centre of site
Period: Post Medieval **Broadclass:** Domestic
Form: Topog **Condition:** Intact
Site Status: pcnp **SAM number:** **LB number:** **grade:**
Rarity: Common
Reference: Pembrokeshire HER
Documentation:
Group Value: Part of farmstead complex
Evidential Value: Standing trees
Historical Value: None
Aesthetic Value: None
Communal Value: None
Significance: Minor Importance

ID number: 104 NORTON FARM WELL
HER PRN: 42868 **NMR NPRN:**
NGR: SS06239886 Grid reference taken at centre of site
Period: Post Medieval **Broadclass:** Water Supply and Drainage
Form: Other structure **Condition:** Intact
Site Status: pcnp **SAM number:** **LB number:** **grade:**
Rarity: Not common
Reference: Pembrokeshire HER
Documentation:
Group Value: Part of farmstead complex
Evidential Value: Standing structure
Historical Value: None
Aesthetic Value: None
Communal Value: None
Significance: Minor Importance

Landway Farm, Jameston, Pembrokeshire, Archaeological Appraisal

ID number: 105 NORTON FARM POND
HER PRN: 42869 **NMR NPRN:**
NGR: SS06369855 Grid reference taken at centre of site
Period: Post Medieval **Broadclass:** Water Supply and Drainage
Form: Earthwork **Condition:** Intact
Site Status: pcnp **SAM number:** **LB number:** **grade:**
Rarity: Common
Reference: Pembrokeshire HER
Documentation:
Group Value: Part of farmstead complex
Evidential Value: Pond still holds water
Historical Value: None
Aesthetic Value: None
Communal Value: None
Significance: Locally Important

ID number: 106 NORTON FARM RUBBING STONE;
STANDING STONE?
HER PRN: 42870 **NMR NPRN:**
NGR: SS06349877 Grid reference taken at centre of site
Period: Post Medieval;Bronze Age? **Broadclass:** Agriculture and Subsistence; Religious Ri
Form: Other structure **Condition:** Near Intact
Site Status: pcnp **SAM number:** **LB number:** **grade:**
Rarity: Not rare
Reference: Pembrokeshire HER
Documentation:
Group Value: Part of farmstead complex
Evidential Value: Still standing in 2001
Historical Value: None
Aesthetic Value: None
Communal Value: None
Significance: Unknown

Landway Farm, Jameston, Pembrokeshire, Archaeological Appraisal

ID number: 107 NORTON FARM QUARRY
HER PRN: 42871 **NMR NPRN:**
NGR: SS06499881 Grid reference taken at centre of site
Period: Post Medieval **Broadclass:** Industrial
Form: Earthwork **Condition:** Intact
Site Status: pcnp **SAM number:** **LB number:** **grade:**
Rarity: Common
Reference: Pembrokeshire HER
Documentation:
Group Value: Associated with at least one limekiln
Evidential Value: Quarry disused and overgrown
Historical Value: None
Aesthetic Value: None
Communal Value: None
Significance: Locally Important

ID number: 108 NORTON FARM QUARRY
HER PRN: 42872 **NMR NPRN:**
NGR: SS06439879 Grid reference taken at centre of site
Period: Post Medieval **Broadclass:** Industrial
Form: Earthwork **Condition:** Intact
Site Status: pcnp **SAM number:** **LB number:** **grade:**
Rarity: Common
Reference: Pembrokeshire HER
Documentation:
Group Value: Associated with at least one limekiln
Evidential Value: Quarry disused and overgrown
Historical Value: None
Aesthetic Value: None
Communal Value: None
Significance: Locally Important

Landway Farm, Jameston, Pembrokeshire, Archaeological Appraisal

ID number: 109 NORTON FARM TRACKWAY
HER PRN: 42873 **NMR NPRN:**
NGR: SS06479881 Grid reference taken at point along linear site
Period: Post Medieval **Broadclass:** Transport
Form: Topog **Condition:** Near Intact
Site Status: pcnp **SAM number:** **LB number:** **grade:**
Rarity: Common
Reference: Pembrokeshire HER
Documentation:
Group Value: Possibly associated with limestone quarry PRN42871
Evidential Value: Remains in use
Historical Value: None
Aesthetic Value: None
Communal Value: None
Significance: Minor Importance

ID number: 110 NORTON FARM TRACKWAY
HER PRN: 42874 **NMR NPRN:**
NGR: SS06549882
Period: Post Medieval **Broadclass:** Transport
Form: Topog **Condition:** Intact
Site Status: pcnp **SAM number:** **LB number:** **grade:**
Rarity: Common
Reference: Pembrokeshire HER
Documentation:
Group Value: None
Evidential Value: Remains in use
Historical Value: None
Aesthetic Value: None
Communal Value: None
Significance: Minor Importance

Landway Farm, Jameston, Pembrokeshire, Archaeological Appraisal

ID number: 111 NORTON FARM TRACKWAY
HER PRN: 42875 **NMR NPRN:**
NGR: SS06589876 Grid reference taken at centre of site
Period: Post Medieval **Broadclass:** Transport
Form: Topog **Condition:** Near Destroyed
Site Status: pcnp **SAM number:** **LB number:** **grade:**
Rarity: Common
Reference: Pembrokeshire HER
Documentation:
Group Value: None
Evidential Value: Documents only
Historical Value: None
Aesthetic Value: None
Communal Value: None
Significance: Minor Importance

ID number: 112 NORTON FARM TRACKWAY
HER PRN: 42876 **NMR NPRN:**
NGR: SS06299882 Grid reference taken at point along linear site
Period: Post Medieval **Broadclass:** Transport
Form: Topog **Condition:** Damaged
Site Status: pcnp **SAM number:** **LB number:** **grade:**
Rarity: Common
Reference: Pembrokeshire HER
Documentation:
Group Value: Part of farmstead complex
Evidential Value: Faint traces visible on the ground
Historical Value: None
Aesthetic Value: None
Communal Value: None
Significance: Minor Importance

Landway Farm, Jameston, Pembrokeshire, Archaeological Appraisal

ID number: 115 TYNEWYDD LIME KILN
HER PRN: 43274 **NMR NPRN:**
NGR: SS0648699285 Grid reference taken at centre of site
Period: Post Medieval **Broadclass:** Industrial
Form: Other structure **Condition:** Damaged
Site Status: pcnp **SAM number:** **LB number:** **grade:**
Rarity: Not rare
Reference: Pembrokeshire HER
Documentation:
Group Value: None
Evidential Value: Partly surviving only by 1997
Historical Value: None
Aesthetic Value: None
Communal Value: None
Significance: Locally Important

ID number: 116 GREEN ACRES LIME KILN
HER PRN: 43275 **NMR NPRN:**
NGR: SS0626399311 Grid reference taken at centre of site
Period: Post Medieval **Broadclass:** Industrial
Form: Other structure **Condition:** Damaged
Site Status: pcnp **SAM number:** **LB number:** **grade:**
Rarity: Not rare
Reference: Pembrokeshire HER
Documentation:
Group Value: None
Evidential Value: In poor condition by 1997
Historical Value: None
Aesthetic Value: None
Communal Value: None
Significance: Locally Important

Landway Farm, Jameston, Pembrokeshire, Archaeological Appraisal

ID number: 117 MUD LANE LIME KILN
HER PRN: 43276 **NMR NPRN:**
NGR: SS0706997656 Grid reference taken at centre of site
Period: Post Medieval **Broadclass:** Industrial
Form: Other structure **Condition:** Damaged
Site Status: pcnp **SAM number:** **LB number:** **grade:**
Rarity: Not rare
Reference: Pembrokeshire HER
Documentation:
Group Value: None
Evidential Value: Still standing in 1997
Historical Value: None
Aesthetic Value: None
Communal Value: None
Significance: Locally Important

ID number: 118 ROCK FARM LIME KILN
HER PRN: 43277 **NMR NPRN:**
NGR: SS0595299467 Grid reference taken at centre of site
Period: Post Medieval **Broadclass:** Industrial
Form: Other structure **Condition:** Damaged
Site Status: pcnp **SAM number:** **LB number:** **grade:**
Rarity: Not rare
Reference: Pembrokeshire HER
Documentation:
Group Value: None
Evidential Value: Standing structure in 1997
Historical Value: None
Aesthetic Value: None
Communal Value: None
Significance: Locally Important

Landway Farm, Jameston, Pembrokeshire, Archaeological Appraisal

ID number: 119 PARK FARM FINDSPOT
HER PRN: 45109 **NMR NPRN:**
NGR: SS063983 Grid reference taken at centre of site
Period: Unknown **Broadclass:** Object
Form: Finds **Condition:**
Site Status: pcnp **SAM number:** **LB number:** **grade:**
Rarity: Not common
Reference: Pembrokeshire HER
Documentation:
Group Value: None
Evidential Value: Coins
Historical Value: None
Aesthetic Value: None
Communal Value: None
Significance: Unknown

ID number: 120 RED HOUSE KILN LIME KILN
HER PRN: 45940 **NMR NPRN:**
NGR: SS07329890 Grid reference taken at centre of site
Period: Post Medieval **Broadclass:** Industrial
Form: Other structure **Condition:** Damaged
Site Status: pcnp **SAM number:** **LB number:** **grade:**
Rarity: Not rare
Reference: Pembrokeshire HER
Documentation:
Group Value: None
Evidential Value: Standing structure in 1997
Historical Value: None
Aesthetic Value: None
Communal Value: None
Significance: Locally Important

Landway Farm, Jameston, Pembrokeshire, Archaeological Appraisal

ID number: 121 PARSON'S PIECE FINDSPOT
HER PRN: 46049 **NMR NPRN:**
NGR: SS05959705 Unknown
Period: Unknown **Broadclass:** Object
Form: Finds **Condition:**
Site Status: **SAM number:** **LB number:** **grade:**
Rarity: Rare
Reference: Pembrokeshire HER
Documentation:
Group Value: None
Evidential Value: Artefact
Historical Value: None
Aesthetic Value: None
Communal Value: None
Significance: Regionally Important

ID number: 122 MANORBIER NEWTON FINDSPOT
HER PRN: 46050 **NMR NPRN:**
NGR: SN045002 Grid reference taken at centre of site
Period: Roman **Broadclass:** Object
Form: Finds **Condition:**
Site Status: pcnp **SAM number:** **LB number:** **grade:**
Rarity: Not common
Reference: Pembrokeshire HER
Documentation:
Group Value: Not known
Evidential Value: Artefact
Historical Value: Not known
Aesthetic Value: None
Communal Value: Not known
Significance: Regionally Important

Landway Farm, Jameston, Pembrokeshire, Archaeological Appraisal

ID number: 123 MANORBIER PARISH CHURCHYARD
CHURCH;ST JAMES';ST
MARTIN'S?

HER PRN: 46832 **NMR NPRN:**

NGR: SS06509764 Grid reference taken at centre of site

Period: Early Medieval **Broadclass:** Religious Ritual and Funerary

Form: Earthwork **Condition:** Intact

Site Status: Pembrok **SAM number:** **LB number:** **grade:**

Rarity: Not common

Reference: Pembrokeshire HER

Documentation:

Group Value: Unknown

Evidential Value: Unknown

Historical Value: None

Aesthetic Value: None

Communal Value: Burial ground

Significance: Unknown

ID number: 124 BIER HILL MOUNDS ROUND BARROW

HER PRN: 47439 **NMR NPRN:**

NGR: SN0691400123 Grid reference taken at centre of site

Period: Bronze Age **Broadclass:** Religious Ritual and Funerary

Form: Earthwork **Condition:** Near Destroyed

Site Status: schedule **SAM number:** PE470 **LB number:** **grade:**

Rarity: Not rare

Reference: Pembrokeshire HER

Documentation:

Group Value: One of 5 barrows in a barrow cemetery group

Evidential Value: Denuded earthwork reduced by ploughing

Historical Value: None

Aesthetic Value: None

Communal Value: None

Significance: Nationally Important

Landway Farm, Jameston, Pembrokeshire, Archaeological Appraisal

ID number: 125 RUINS ADJACENT TO CHURCH RUINS
HILL COTTAGE, RUIN A

HER PRN: 59513 **NMR NPRN:**

NGR: SS0652097619 Grid reference taken at centre of site

Period: Post Medieval **Broadclass:** Unassigned

Form: Building **Condition:** Ruin

Site Status: pcnp,list **SAM number:** **LB number:** 18009 **grade:** II

Rarity: Unknown

Reference: Pembrokeshire HER

Documentation:

Group Value: One of four ruined buildings south of Church Hill Cottage

Evidential Value: Ruined building

Historical Value: Described by Fenton in 1811 and by Cadw for listing purposes

Aesthetic Value: None

Communal Value: None

Significance: Nationally Important

ID number: 126 OLD VICARAGE HOUSE

HER PRN: 59514 **NMR NPRN:**

NGR: SS0641797591 Grid reference taken at centre of site

Period: Post Medieval **Broadclass:** Domestic

Form: Building **Condition:** Ruin

Site Status: pcnp,list **SAM number:** **LB number:** 18010 **grade:** II

Rarity: Not rare

Reference: Pembrokeshire HER

Documentation:

Group Value: Associated with nearby parish church

Evidential Value: Ruins

Historical Value: Described by Cadw for listing purposes

Aesthetic Value: None

Communal Value: None

Significance: Nationally Important

Landway Farm, Jameston, Pembrokeshire, Archaeological Appraisal

ID number: 127 MANORBIER CATTLE POUND
HER PRN: 59515 **NMR NPRN:**
NGR: SS0684497959 Grid reference taken at centre of site
Period: Post Medieval **Broadclass:** Agriculture and Subsistence
Form: Building **Condition:**
Site Status: pcnp,list **SAM number:** **LB number:** 18011 **grade:** II
Rarity: Not rare
Reference: Pembrokeshire HER
Documentation:
Group Value: Associated with parish Bier House
Evidential Value: Standing structure
Historical Value: Described by Cadw for listing purposes
Aesthetic Value: None
Communal Value: Former parish pound, now a public garden
Significance: Nationally Important

ID number: 128 WARLOW'S COTTAGE HOUSE
HER PRN: 59516 **NMR NPRN:**
NGR: SS0676397926 Grid reference taken at centre of site
Period: Post Medieval **Broadclass:** Domestic
Form: Building **Condition:**
Site Status: pcnp,list **SAM number:** **LB number:** 18013 **grade:** II
Rarity: Common
Reference: Pembrokeshire HER
Documentation:
Group Value: Part of historic village of Manorbier
Evidential Value: Standing building
Historical Value: Described by Cadw for listing purposes
Aesthetic Value: None
Communal Value: None
Significance: Nationally Important

Landway Farm, Jameston, Pembrokeshire, Archaeological Appraisal

ID number: 129 WESLEY HOUSE HOUSE
HER PRN: 59521 **NMR NPRN:**
NGR: SS0567298980 Grid reference taken at centre of site
Period: Post Medieval **Broadclass:** Domestic
Form: Building **Condition:** Intact
Site Status: pcnp,listd **SAM number:** **LB number:** 18018 **grade:** II
Rarity: Not rare
Reference: Pembrokeshire HER
Documentation:
Group Value: Part of historic village
Evidential Value: Standing building
Historical Value: Described by Cadw for listing purposes
Aesthetic Value: None
Communal Value: None
Significance: Nationally Important

ID number: 130 FORMER RAILWAY HOUSE
 STATIONMASTER'S HOUSE
HER PRN: 59525 **NMR NPRN:**
NGR: SS0697799406 Grid reference taken at centre of site
Period: Post Medieval **Broadclass:** Domestic
Form: Building **Condition:** F
Site Status: pcnp,listd **SAM number:** **LB number:** 18022 **grade:** II
Rarity: Not rare
Reference: Pembrokeshire HER
Documentation:
Group Value: Attached to former railway station
Evidential Value: Still occupied as a private dwelling
Historical Value: Not known
Aesthetic Value: None
Communal Value: None
Significance: Nationally Important

Landway Farm, Jameston, Pembrokeshire, Archaeological Appraisal

ID number: 131 WEST MOOR FARMHOUSE HOUSE
HER PRN: 59526 **NMR NPRN:**
NGR: SS0413998507 Grid reference taken at centre of site
Period: Post Medieval **Broadclass:** Domestic
Form: Building **Condition:** Intact
Site Status: pcnp,list **SAM number:** **LB number:** 18023 **grade:** II
Rarity: Not rare
Reference: Pembrokeshire HER
Documentation:
Group Value: Part of the historic settlement pattern
Evidential Value: Standing building
Historical Value: Described by Cadw for listing purpose
Aesthetic Value: None
Communal Value: None
Significance: Nationally Important

ID number: 132 RUINS ADJACENT TO CHURCH BUILDING
HILL COTTAGE, RUIN B
HER PRN: 59529 **NMR NPRN:**
NGR: SS0651297608 Grid reference taken at centre of site
Period: Post Medieval **Broadclass:** Monument <By Form>
Form: Building **Condition:**
Site Status: pcnp,list **SAM number:** **LB number:** 18038 **grade:** II
Rarity: Unknown
Reference: Pembrokeshire HER
Documentation:
Group Value: One of four ruined buildings south of Church Hill Cottage
Evidential Value: Partial ruins
Historical Value: Described by Fenton in 1811 and by Cadw for listing purposes
Aesthetic Value: None
Communal Value: None
Significance: Nationally Important

Landway Farm, Jameston, Pembrokeshire, Archaeological Appraisal

ID number: 133 RUINS ADJACENT TO CHURCH BUILDING
HILL COTTAGE, RUIN C

HER PRN: 59530 **NMR NPRN:**

NGR: SS0652797611 Grid reference taken at centre of site

Period: Post Medieval **Broadclass:** Monument <By Form>

Form: Building **Condition:**

Site Status: pcnp,listc **SAM number:** **LB number:** 18039 **grade:** II

Rarity: Unknown

Reference: Pembrokeshire HER

Documentation:

Group Value: One of four ruined buildings south of Church Hill Cottage

Evidential Value: Fragmentary ruins

Historical Value: Described by Fenton in 1811 and by Cadw for listing purposes

Aesthetic Value: None

Communal Value: None

Significance: Nationally Important

ID number: 134 RUINS ADJACENT TO CHURCH RUINS
HILL COTTAGE, RUIN D

HER PRN: 59531 **NMR NPRN:**

NGR: SS0648197609 Grid reference taken at centre of site

Period: Post Medieval **Broadclass:** Unassigned

Form: Building **Condition:**

Site Status: pcnp,listc **SAM number:** **LB number:** 18040 **grade:** II

Rarity: Unknown

Reference: Pembrokeshire HER

Documentation:

Group Value: One of four ruined buildings south of Church Hill Cottage

Evidential Value: Fragmentary ruins

Historical Value: Described by Fenton in 1811 and by Cadw for listing purposes

Aesthetic Value: None

Communal Value: None

Significance: Nationally Important

Landway Farm, Jameston, Pembrokeshire, Archaeological Appraisal

ID number: 135 SHUTE COTTAGE HOUSE
HER PRN: 60031 **NMR NPRN:**
NGR: SS0654597700 Grid reference taken at centre of site
Period: Post Medieval **Broadclass:** Domestic
Form: Building **Condition:** Intact
Site Status: pcnp,list **SAM number:** **LB number:** 5978 **grade:** II
Rarity: Common
Reference: Pembrokeshire HER
Documentation:
Group Value: Part of historic settlement pattern of Manobier
Evidential Value: Standing building
Historical Value: None
Aesthetic Value: None
Communal Value: None
Significance: Nationally Important

ID number: 136 MANORBIER FINDSPOT
HER PRN: 102472 **NMR NPRN:**
NGR: SN05860013
Period: Bronze Age **Broadclass:** Object
Form: Finds **Condition:** Excavated
Site Status: **SAM number:** **LB number:** **grade:**
Rarity: Not common
Reference: Pembrokeshire HER
Documentation:
Group Value: Not known
Evidential Value: Artefacts
Historical Value: Reported in news and in archaeological and metal detectorists journals
Aesthetic Value: Photographed by National Museum of Wales
Communal Value: Possibly accessible at National Museum of Wales
Significance: Nationally Important

Landway Farm, Jameston, Pembrokeshire, Archaeological Appraisal

ID number: 137 NORTON FARM LIMEKILN
HER PRN: 103355 **NMR NPRN:**
NGR: SS06459876 Grid reference taken at centre of site
Period: Post Medieval **Broadclass:** Industrial
Form: documents **Condition:** Not known
Site Status: **SAM number:** **LB number:** **grade:**
Rarity: Common
Reference: Pembrokeshire HER
Documentation:
Group Value: Associated with quarry PRN42872
Evidential Value: Historic mapping
Historical Value: None
Aesthetic Value: None
Communal Value: None
Significance: Locally Important

ID number: 138 FERN HILL FARMSTEAD
HER PRN: 103360 **NMR NPRN:**
NGR: SN04670030 Grid reference taken at centre of site
Period: Post Medieval **Broadclass:** Agriculture and Subsistence
Form: Documents **Condition:** Not known
Site Status: **SAM number:** **LB number:** **grade:**
Rarity: Common
Reference: Ordnance Survey, 1907, 1:2500 Second Edition Map
Documentation:
Group Value: None
Evidential Value: Standing buildings
Historical Value: None known
Aesthetic Value: None known
Communal Value: None known
Significance: Locally Important

Landway Farm, Jameston, Pembrokeshire, Archaeological Appraisal

ID number: 139 JAMESTON WESLEYAN CHAPEL
 METHODIST CHAPEL

HER PRN: **NMR NPRN:** 11118

NGR: SS0568998992 Grid reference taken at centre of site

Period: Post Medieval **Broadclass:** Religious Ritual and Funerary

Form: Building **Condition:** Converted

Site Status: **SAM number:** **LB number:** **grade:**

Rarity: Common

Reference: National Monuments Record

Documentation:

Group Value: Part of historic village

Evidential Value: Converted building still in use

Historical Value: None

Aesthetic Value: None

Communal Value: None

Significance: Locally Important

ID number: 140 LANDWAY FARM FARMSTEAD

HER PRN: **NMR NPRN:** 0

NGR: SS0559798827 Grid reference taken at centre of site

Period: Post Medieval;Modern **Broadclass:** Agriculture and Subsistence

Form: Building **Condition:** Intact

Site Status: **SAM number:** **LB number:** **grade:**

Rarity: Common

Reference:

Documentation:

Group Value: None

Evidential Value: Extant complex

Historical Value: None

Aesthetic Value: None

Communal Value: None

Significance: Locally Important
