

Building Survey and Photographic Record (Level 1)

Photographic Record (Volume 2)

Former Custom House, Custom House Street, Cardiff

July 2018

Existing Site Plan: Photograph Locations

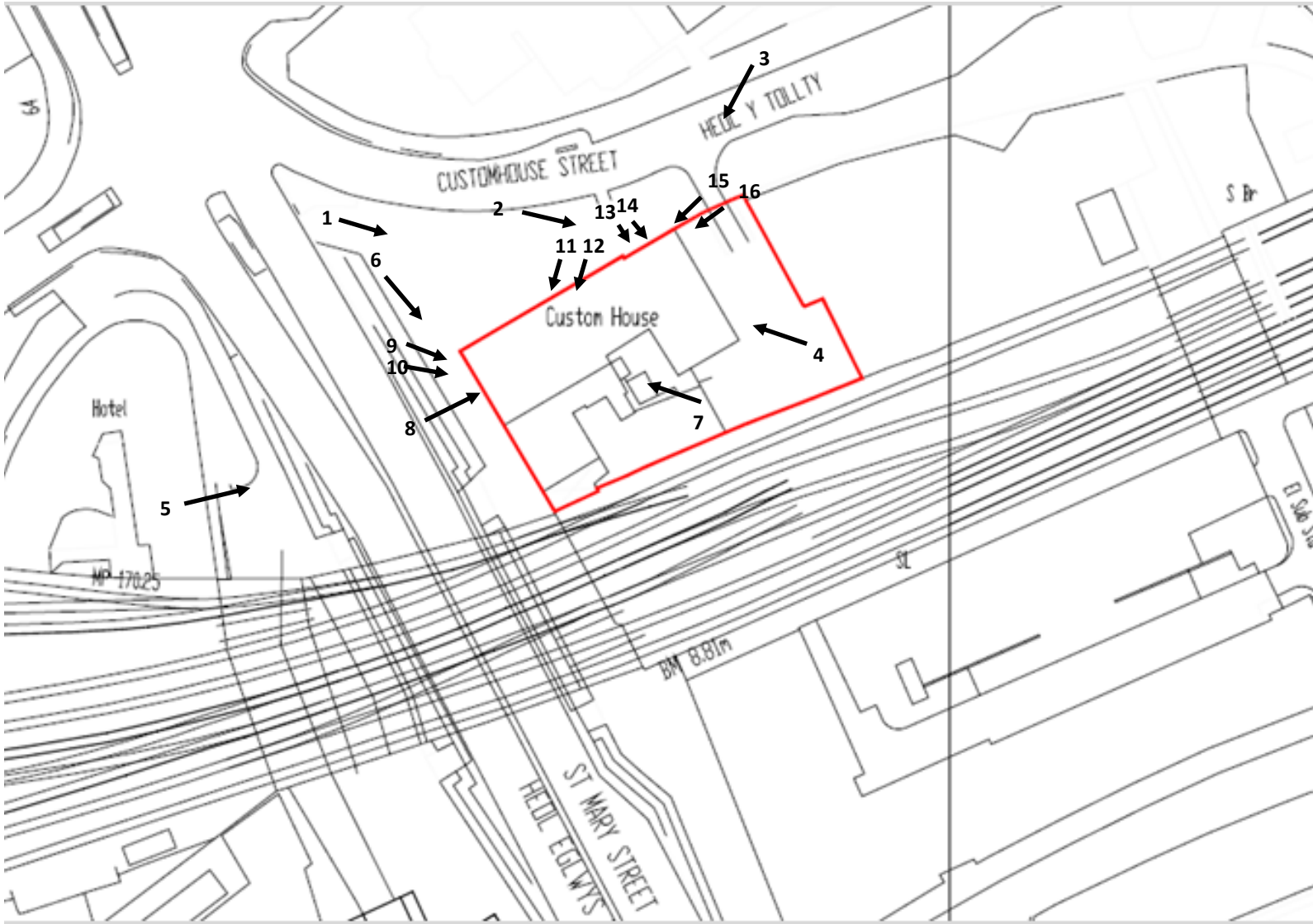

North Elevation



Photo ref	01
Photo Location	North Elevation.
Details	Two storey building with modern hipped Mansard roof above, as viewed from the north west of the Site. Frontage is comprised of stucco with some bathstone dressings. Rusticated ground floor. The north elevation is asymmetrical articulated by banded pilasters into six bays, with windows grouped 3+1+3+1+1+blank.

North Elevation (Eastern Bay)



Photo ref	02
Photo Location	North Elevation (Eastern bay)
Details	Eastern bay of North Elevation, showing doorway under modern canopy flanked by round-headed windows.

East and North Elevations



Photo ref	03
Photo Location	East and North Elevations
Details	View of the eastern and northern elevations, from the north east. The eastern elevation is late 20 th century in date and of a plain, utilitarian character. The return of the North Elevation has storeys articulated by channelling in render. The image shows the road infrastructure close to the site.

East Elevation



Photo ref	04
Photo Location	East Elevation
Details	The eastern elevation is late 20 th century in date and of a plain, utilitarian character.

West Elevation



Photo ref	05
Photo Location	West elevation.
Details	View of the western elevation from the west. Two storeys with modern hipped Mansard roof above. Rusticated ground floor. Frontage is comprised of stucco with some bathstone dressings. The west elevation has 5 bays with ground floor central doorway. Corner chimneys, square with cornice. Stone cornice and parapet with inscription 'Custom House'. The image shows the road infrastructure close to the site.

North and West Elevations



Photo ref	06
Photo Location	North and West Elevations
Details	View of the northern and western elevations, from the north west. Image includes attic lunette to North Elevation, framed by squat pilasters with scrolls, and low entablature.

South Elevation



Photo ref	07
Photo Location	South elevation.
Details	View of the southern elevation from the south east. The southern elevation is late 20 th century in date and of a plain, utilitarian character

West Elevation: Central doorway



Photo ref	08
Photo Location	West Elevation: Central doorway.
Details	View of central doorway with segmental pediment supported by paired tall brackets on tall plinths; round headed entrance doorway with keystone.

West Elevation: Ground floor



Photo ref	09
Photo Location	West Elevation: Ground floor
Details	View of ground floor windows camber-headed with tall keystones.

West Elevation: First floor



Photo ref	10
Photo Location	West Elevation: First floor
Details	View of first floor windows with square-headed sashes but round-headed shouldered surrounds with keystones.

North Elevation: Ground floor



Photo ref	11
Photo Location	North Elevation: Ground floor
Details	View of ground Venetian window and, to left, example of round-headed ground floor window with keystone (present elsewhere at ground floor on North Elevation). All ground floor windows have aprons below sills with keystone-like decoration.

North Elevation: First floor



Photo ref	12
Photo Location	North Elevation: First floor
Details	View of first floor round-headed windows with horned and keystoned surrounds. Cornice at sill level.

North Elevation (Eastern bay): Ground floor



Photo ref	13
Photo Location	North Elevation (Eastern bay): Ground floor
Details	View of first floor round-headed window to Eastern bay of North Elevation

North Elevation (Eastern bay): Ground floor



Photo ref	14
Photo Location	North Elevation (Eastern bay): Ground floor
Details	View of doorway under modern canopy to Eastern bay of North Elevation

East and North Elevations



Photo ref	15
Photo Location	East and North Elevations
Details	View of corner junction between East and North Elevations

East and North Elevations



Photo ref	16
Photo Location	East and North Elevations
Details	View of corner junction between East and North Elevations