

Porth-y-Dwr, Ruthin

NPRN: 27028 NGR: SJ 12140 58128

Recorded & drawn Geoff Ward, July 2013 & March 2014

Print Scale: 1:100 & 1:200 at A4

Crown Copyright: Royal Commission on the Ancient and Historical Monuments of Wales, 2014

Hawlfraint y Goron: Comisiwn Benhiniol Henebion Cymru, 2014



0 metres 5

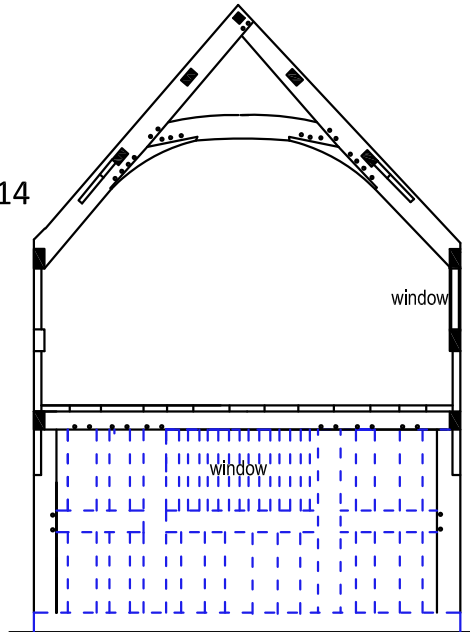

Cross-wing section through open-bay

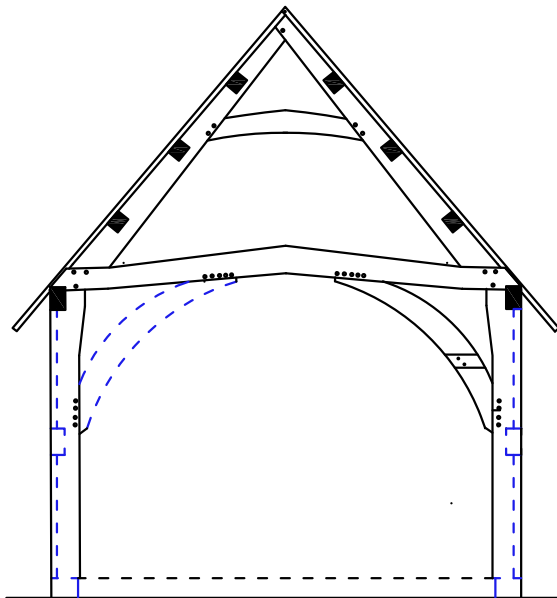

Hall central arch-braced truss

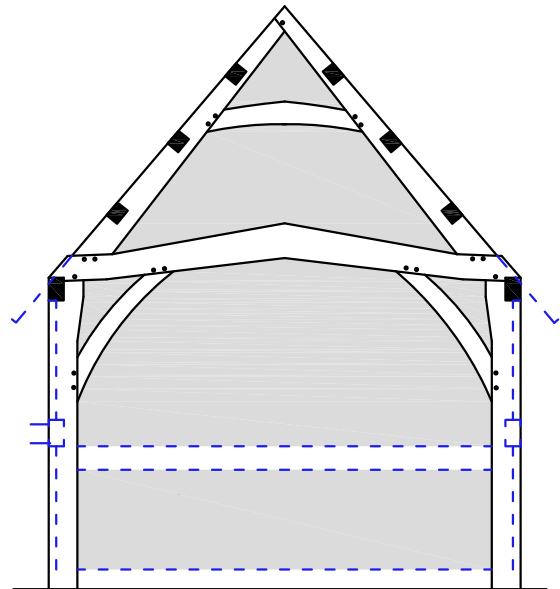

Hall closed truss at lower south end

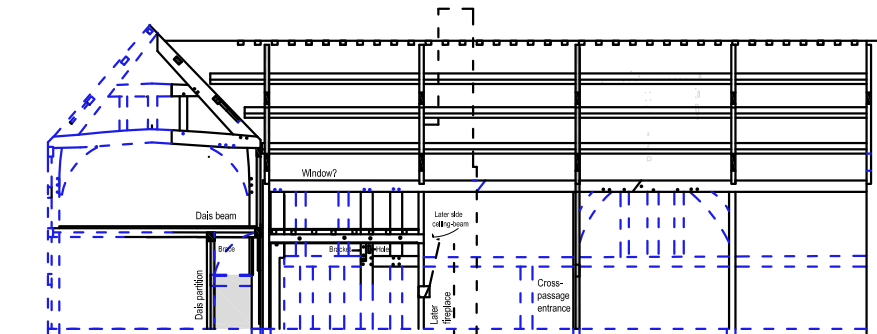

0 metres 10

Long section of hall range with cross-wing showing braced dais-partition and late-17th century hall fireplace and ceiling beams.